

MR. ANDY LAI
UNIT 1702-B ALPHA GRANDVIEW TOWER, #1716, M. H. DEL PILAR ST., MALATE, MANILA CITY
TEL#: 0927-6260000

Dear Ma'am/Sir,

Kolin Marketing Inc., is extremely honored for your endorsement of Kolin brand and we are please to offer you with a special price/s for the following items.

A. EQUIPMENT & INSTALLATION

* OPTION 1 *

QTY	U/M	MODEL / DESCRIPTION	SRP	DISCOUNTED PRICE		AMOUNT
1	UNIT/S	MODEL: KSM-IW10-WCT10M1M32 KOLIN WALL MOUNTED CERTUS SERIES AIRCONDITIONER 9,800 Kj/h (1.0HP) REGULAR INVERTER W/ WIFI R-32	29,995.00	18,796.20	PHP	18,796.20
TOTAL UNIT COST					PHP	18,796.20
ESTIMATED COST OF INSTALLATION (please see attached) w/ dismantling of existing unit					PHP	11,075.00
OTHERS: DELIVERY CHARGE					PHP	600.00
TOTAL ESTIMATED COST OF THE PROJECT					PHP	30,471.20

* OPTION 2 *

QTY	U/M	MODEL / DESCRIPTION	SRP	DISCOUNTED PRICE		AMOUNT
1	UNIT/S	MODEL: KS-IW10-MCAI1201M32 KOLIN WALL MOUNTED CERTUS A/ SERIES AIRCONDITIONER 9,800 Kj/h (1.0HP) FULL DC INVERTER W/ WIFI R-32	30,995.00	17,056.20	PHP	17,056.20
TOTAL UNIT COST					PHP	17,056.20
ESTIMATED COST OF INSTALLATION (please see attached) w/ dismantling of existing unit					PHP	11,075.00
OTHERS: DELIVERY CHARGE					PHP	600.00
TOTAL ESTIMATED COST OF THE PROJECT					PHP	28,731.20

TERMS OF PAYMENT:

FULL PAYMENT OF UNIT AND DELIVERY CHARGE. IF CHECK, SUBJECT FOR 3 DAYS CLEARING.

BANK DETAILS:

- * Unit/s & Delivery: Account Name - KOLIN MARKETING INC. / Account# - 011808002307 (BDO-KALAYAAN)
- * Installation: Will be provided by assigned installer.
- ** You may settle first payment for unit/s & delivery. Installation payment can be settled directly to installer after actual works.

WARRANTY:

FOR SPLIT TYPE : ONE (1) YEAR FREE PARTS AND LABOR, THREE YEARS (3) MAIN PCB , TEN (10) YEARS WARRANTY ON COMPRESSOR.

NOTES: PRICES ARE SUBJECT TO CHANGE WITHOUT PRIOR NOTICE.

PRICES IS VAT INCLUSIVE.

** Cost of Installation is Package with the Unit(s), this cost cannot avail separately (cost will be based on actual works).

We thank you for giving opportunity to offer our product and services, hoping we receive your purchase order.

If you need assistance, don't hesitate to call the under signed at 0917-807-8607 or email at kmi_asst@kolinphil.com.ph

Very Truly Yours,

JANELLEN S. LIM
KMI-ASSISTANT

Noted by:
MART NATHANIEL R. FLORES
KMI-SUPERVISOR

Approved By:
MS. EDITHA M. FLORES
AVP - FINANCE

KMI-QUOTE-01-26-0004
DCG-24%/4K/6.5K

Conforme:
SIGNATURE OVER PRINTED NAME



KOLIN Philippines International Inc.
Survey Form

No 003717

Customer Name : XNOY Lx1 Date : 1-7-20
 Address : Unit 102-13 Alabaster Greenway Tower #1116 SJR No. : 45700
 Establishment Type : Residential ☒ Area Surveyed : 0FT-14
 Commercial ☐ Area Surveyed : _____
 Recommended Product Model : KS-1W10-MCX11201M32

Cooling Capacity Computation

Floor Area : 12 sqm.
 Ceiling Height : 2.5 mtr.

note: add 20% per meter in excess of 3 meters in the initial cooling capacity computed.

Floor Area :	<u>12</u>	x	550 Btu/h	<u>6600</u> Btu/h
Ceiling Height (excess of 3 mtrs.) :		x	20%	
Window Direct Sunlight		x	20% - 50%	<u>1320</u> Btu/h
Total Cooling Capacity				<u>7920</u> Btu/h

Add : Additional Heat Load

No. of Person	<u>2</u>	x	300 Btu/h	<u>600</u> Btu/h
No. of Ordinary Light (<40w)	<u>4</u>	x	200 Btu/h	<u>800</u> Btu/h
No. of Special Light (>40w)		x	400 Btu/h	
No. of Refrigerator (< 6 cu.ft.)		x	400 Btu/h	
No. of Refrigerator (> 6 cu.ft.)		x	800 Btu/h	
No. of Cooking Range		x	1500 Btu/h	
No. of Laptop Computer		x	150 Btu/h	
No. of Desktop Computer	<u>1</u>	x	400 Btu/h	<u>400</u> Btu/h
No. of Printer		x	500 Btu/h	
No. of Photocopier		x	1000 Btu/h	
Total Cooling Capacity				<u>1800</u> Btu/h

Recommended Cooling Capacity

9.720 Btu/h

Note : Compressor warranty will be reduced to ____ yr. if air-conditioner purchased is lower than the recommended cooling capacity or pipe lay-out is beyond the maximum allowable length.

Scope of Work Agreement

- | | | |
|-----------------------------------|--|--|
| 1. Copper tube lay-out | <input type="checkbox"/> Expose | <input type="checkbox"/> Embedded |
| 2. Chipping | <input checked="" type="checkbox"/> Included | <input checked="" type="checkbox"/> Not Included |
| 3. Fabricated Bracket | <input type="checkbox"/> Yes <input type="checkbox"/> Shop | <input type="checkbox"/> Site <input checked="" type="checkbox"/> No |
| 4. Service Ledge | <input type="checkbox"/> Yes | <input checked="" type="checkbox"/> No |
| 5. Dismantling of existing Aircon | <input checked="" type="checkbox"/> Included | <input type="checkbox"/> Not Included |
| 6. Ducting | <input type="checkbox"/> Yes | <input checked="" type="checkbox"/> No |

Dimension :

- Plastering, carpentry and restoration works are to be done by the customer.
- Wiring of electrical supply from main panel to air-conditioning unit are to be done by the customer.
- Processing of mechanical plan, working permit, electrical permit are to be done by the customer.
- Other concern:

DISMANTLE & LAY-OUT OF NEW CONDENSER
AND COMMUNICATION WITH NEED WORKING
PERMIT USE EXISTING BRACKET &
BRACKET. THE INDOOR UNIT NEED
TO LOWER BY 175CM.

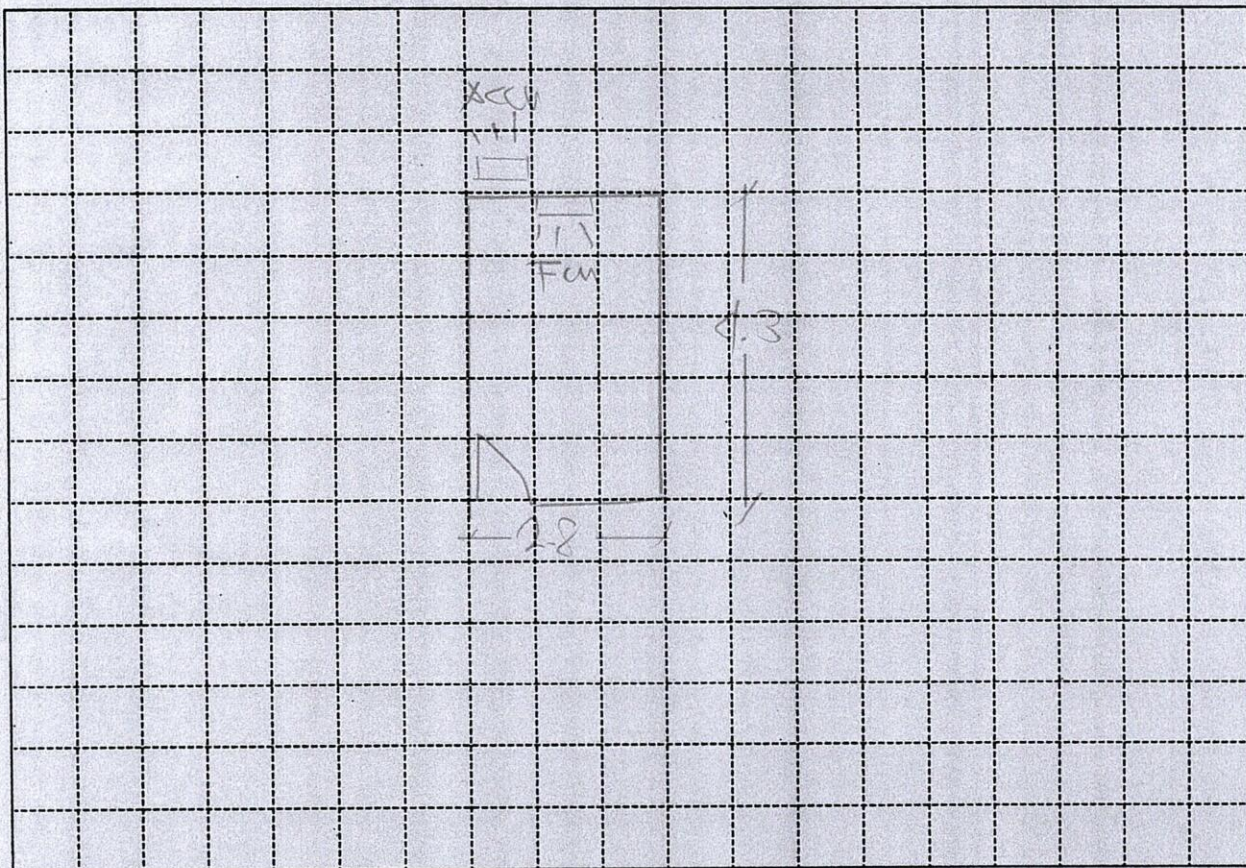

Indoor Unit Location : UP OF WINDOW SAME LOCATION
 Outdoor Unit Location : AT THE ROOF SAME LOCATION
 Pipe Length : 12 FT
 Special Note : _____

Installation Cost Estimate			
Material Description	Qty.	Unit Cost	Total Cost
Copper Tube (excess of 10 ft.) 2330, 2430, 2520, 3520, 4620	12	350	4200
Wire (Royal Cord-signal wire) (excess of 10ft.) 2.0mmx4C	7	100	700
Wire (Royal Cord - Breaker to ODU) 3.5mm / 5.5mm x 3C	3	60	180
Circuit Breaker 20A, 30A, 40A/1ph, 40A/3ph			
Bracket (ODU) (Imptd. / Fabricated) ; (Floor / Wall)			
Bracket (WAC) Angle Type			
PVC Pipe (drain) 1/2" , 3/4"			
PVC Pipe (electrical) 3/4" , 1"			
Drain Pump			
Drain Pump Hose 1/2"	11	15	165
Chipping Works mtr.			
Dismantling Fee (existing air-conditioner) 1HP		2500	2500
Initial Charge LESS OUTDOOR BRACKET (500-800)			6700
TOTAL ESTIMATE		P 11,075-	

Note :

1. Initial Charge includes labor, 10ft. Copper tube, 10ft. Royal cord, Circuit breaker, Outdoor Bracket (SAC), Indoor Bracket (PAC) and Consumable materials.
2. Survey fee will be **deducted** in the installation fee.

Prepared by:

Signature Over Printed Name

Customer Conforme:

Signature Over Printed Name