



January 27, 2026

MRS. KAKA ELIDO  
UNIT 802, ALDER RESIDENCES, ALDER BUILDING ACACIA ESTATES, IPIL ST. TAGUIG CITY  
TEL#: 0917-8816792

Dear Ma'am/Sir,

Kolin Marketing Inc., is extremely honored for your endorsement of Kolin brand and we are please to offer you with a special price/s for the following items.

A. EQUIPMENT & INSTALLATION - **OPTION 1**

QTY	U/M	MODEL / DESCRIPTION	SRP	DISCOUNTED PRICE		AMOUNT
1	UNIT/S	MODEL: KVM-40VAH1M-O KOLIN VERSAMATCH SERIES AIRCONDITIONER 37,980 kJ/h (4.0HP) OUTDOOR UNIT INVERTER R32	79,995.00	60,796.20	PHP	60,796.20
1	UNIT/S	MODEL: KVM-20IWAH-I KOLIN VERSAMATCH SERIES AIRCONDITIONER INVERTER 18,990 kJ/h (2.0HP) WALL MOUNTED INDOOR UNIT R32	15,995.00	12,156.20	PHP	12,156.20
2	UNIT/S	MODEL: KVM-10IWAH-I KOLIN VERSAMATCH SERIES AIRCONDITIONER INVERTER 9,495 kJ/h (1.0HP) WALL MOUNTED INDOOR UNIT R32	10,995.00	8,356.20	PHP	16,712.40
TOTAL UNIT COST					PHP	89,664.80
ESTIMATED COST OF INSTALLATION (please see attached)					PHP	77,940.00
OTHERS: DELIVERY CHARGE					PHP	600.00
TOTAL ESTIMATED COST OF THE PROJECT					PHP	168,204.80

TERMS OF PAYMENT:

FULL PAYMENT OF UNIT AND DELIVERY CHARGE. IF CHECK, SUBJECT FOR 3 DAYS CLEARING.

BANK DETAILS:

- \* Unit/s & Delivery: Account Name - KOLIN MARKETING INC. / Account# - 011808002307 (BDO-KALAYAAN)
- \*\* *You may settle first payment for unit/s & delivery. Installation payment can be settled directly to installer after actual works.*
- \* Installation: Will be provided by assigned installer.

WARRANTY:

FOR VERSAMATCH: ONE (1) YEAR FREE PARTS AND LABOR, FIVE (5) YEARS WARRANTY ON COMPRESSOR.

NOTES: \*\*\* Need to sign waiver agreement due to under capacity of unit choice.

PRICES ARE SUBJECT TO CHANGE WITHOUT PRIOR NOTICE.

PRICES IS VAT INCLUSIVE.

\*\* *Cost of Installation is Package with the Unit(s), this cost cannot avail separately (Final charges will be based on actual works).*

We thank you for giving opportunity to offer our product and services, hoping we receive your purchase order.

If you need assistance, don't hesitate to call the under signed at 0917-807-8607 or email at [kmi\\_asst@kolinphil.com.ph](mailto:kmi_asst@kolinphil.com.ph)

Very Truly Yours,

JANELLEN S. LIM  
KMI-ASSISTANT

Noted by:  
MART NATHANIEL B. FLORES  
KMI-SUPERVISOR

KMI-QUOTE-01-26-0051.1  
MMC-24%

Approved By:  
MS. EDITHA M. FLORES  
AVP - FINANCE

Conforme: \_\_\_\_\_  
SIGNATURE OVER PRINTED NAME



JANUARY 26, 2026

Kaka Elido

Unit 802, Alder Residences Alder Building Acacia Estates, Ipil St. Taguig City

0917-8816792

MODEL	QUANTITY
KVM-40VAH1M-O	1
KVM-20IWAH-I	1
KVM-10IWAH-I	2

OPTION 1-VERSAMATCH

**MASTER BEDROOM/ ROOM1/LIVING DINING**

<b>ACCU</b>	<b>4.0hp Flexmatch Inverter</b>	<b>KVM-40WAH1M-O</b>		
	<b>Initial Charge</b>		<b>P</b>	<b>8,500.00</b>
	<b>Includes:</b>			

Additional Charges	Description	Unit	Price per Unit	Subtotal
Circuit Breaker	40A-1ph	1 unit	P 1000	1000
Royal Cord (ODU-Breaker)	5.5mm <sup>2</sup> x 3C	7 ft	P 70 / ft	P 490
Outdoor Bracket(fabricated)	floor	1 unit	P 2500 / unit	P 2,500 P 3,990.00

<b>Estimated Charges</b>	<b>P</b>	<b>12,490.00</b>
--------------------------	----------	------------------

**LIVING/DINING/KITCHEN**

Area ≈ 28.5 sq.m

<b>FCU A</b>	<b>2.0hp Wall Mounted Inverter</b>	<b>KVM-20IWAH-I</b>		
	Estimated Pipe Length : 43	ft		
	Estimated Royal Cord Length : 50	ft		
	<b>Includes:</b>			
	Labor			
	10ft Copper Tube			
	10ft Royal Cord			
	Other Consumables			

Additional Charges	Description	Unit	Price per Unit	Subtotal
Coppertube	1/4" x 1/2"	33 ft	P 350 / ft	P 11,550
Royal Cord	2mm <sup>2</sup> x 4C	40 ft	P 100 / ft	P 4,000

<b>Estimated Charges</b>	<b>P</b>	<b>15,550.00</b>
--------------------------	----------	------------------

<b>Estimated Charges for 1st Pair</b>	<b>P</b>	<b>28,040.00</b>
---------------------------------------	----------	------------------

**MASTER BEDROOM**

Area ≈ 10 sq.m

<b>FCU B</b>	<b>1.0hp Wall Mounted Inverter</b>	<b>KVM-10IWAH-I</b>		
	Estimated Pipe Length : 37	ft		
	Estimated Royal Cord Length : 44	ft		
	<b>Includes:</b>			
	Labor		<b>P</b>	<b>8,500.00</b>
	10ft Copper Tube			
	10ft Royal Cord			
	Other Consumables			

Additional Charges	Description	Unit	Price per Unit	Subtotal
Coppertube	1/4" x 1/2"	27 ft	P 350 / ft	P 9,450
Royal Cord	2mm <sup>2</sup> x 4C	34 ft	P 100 / ft	P 3,400 12,850.00

<b>Estimated Charges</b>	<b>P</b>	<b>21,350.00</b>
--------------------------	----------	------------------



<b>BEDROOM1</b>	<b>Area ≈ 6 sq.m</b>
-----------------	----------------------

**FCU C** 1.0hp Wallmounted Inverter **KVM-10IWAH-I**

Estimated Pipe Length : 53 ft

Estimated Royal Cord Length : 60 ft

Includes:

- Labor P 8,500.00
- 10ft Copper Tube
- 10ft Royal Cord
- Other Consumables

Additional Charges	Description	Unit	Price per Unit	Subtotal
Coppertube	1/4" x 1/2"	43 ft	P 350 / ft	P 15,050
Royal Cord	2mm <sup>2</sup> x 4C	50 ft	P 100 / ft	P 5,000
				20,050.00

<b>Estimated Charges</b>	<b>P 28,550.00</b>
--------------------------	--------------------

<b>Total Estimated Charges</b>	<b>P 77,940.00</b>
--------------------------------	--------------------

Validity: This quotation is valid for a period of fifteen (15) days from the date thereof, subject to our confirmation thereafter.

**Note:**

- 1 Location of indoor and outdoor units agree by customer and kolin surveyor.
- 2 AC drain line will be tapped to the nearest drain provision provided by the customer's contractor.
- 3 **Expose coppertube in the area. For drainage line use the clean out of each unit drain. For approval of customer.**
- 4 Schedule for markings first for pipe layout and drain provisions.
- 5 Outdoor floor mount only, no drilling on floor and wall.
- 6 Working days: Monday to Saturday, 8am- 5pm. parking is for confirmation, need working permit.
- 7 Mechanical Plans, Permits, Electrical permits not included.
- 8 Deflectors, masonry, carpentry, chipping & plastering (finishing & restoration) are not included in the installation.
- 9 Electrical power supply (feeder line) is not included in the scope of work of Kolin.
- 10 **Final charges will be based on actual installation.**

Prepared by:

Customer Conformance:

**Jeffrey Dadios**  
Field Surveyor

\_\_\_\_\_  
Signature Over Printed Name

Reviewed by:

**Engr. Adnan Nogoy**  
Project Engineer

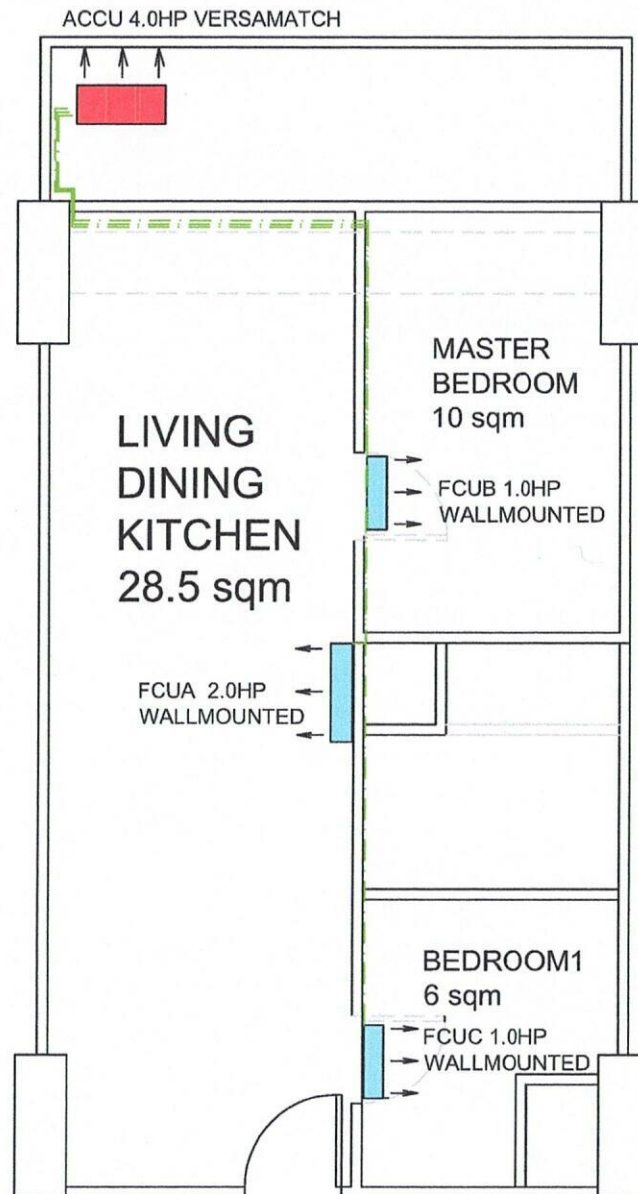

**OPTION 1- VERSAMATCH AC LAYOUT PLAN**

**JANUARY 27, 2026**

**Kaka Elido**

Unit 802, Alder Residences Alder Building Acacia Estates, Ipil St. Taguig City

0917-8816792

Please be informed that the air-conditioner you intend to purchase is under capacity as compared to the following unit that we proposed:

Area	Kolin's Recommendation	Customer's Choice	Remarks
LIVING/DINING/KITCHEN	KVM-25IWAH-I	KVM-20IWAH-I	Calculated 2.2hp
			under by 0.2hp

Since the unit of your choice is under capacity, it is probable that you may experience the following;

1. Capacity of the unit to cool the area will take longer or it will not cool the area at all that may lead to your dissatisfaction with the cooling performance of our unit.
2. Power consumption will be higher due to frequent running of compressor for not reaching the desired temperature within the normal parameter.
3. Useful life of compressor will be shortened due to excessive running beyond the normal run cycle.

Considering the above conditions, we regret to inform you that we cannot guarantee the efficient performance of unit. **Also, One (1) year warranty for parts (compressor-10years).**

For your guidance and information

Prepared by:

  
\_\_\_\_\_  
**Jeffrey Dadios**  
Surveyor

Approved by:

  
\_\_\_\_\_  
**Mr. Alvin de Rivera**  
Service Manager

Noted by:

  
\_\_\_\_\_  
**Engr. Adrian Nogoy**  
Project Engineer

01-28-2026

Customer Conforme:

\_\_\_\_\_  
Signature Over Printed Name