



January 28, 2026

MS. BIFFANY TAN  
UNIT 210 OREAN PLACE AT VERTIS NORTH BY ALVEO LAND, BRGY. VERTIS NORTH TRIANGLE, QUEZON CITY  
TEL#: 0917-8237004

Dear Ma'am/Sir,

Kolin Marketing Inc., is extremely honored for your endorsement of Kolin brand and we are please to offer you with a special price/s for the following items.

A. EQUIPMENT & INSTALLATION - **OPTION 2**

QTY	U/M	MODEL / DESCRIPTION	SRP	DISCOUNTED PRICE		AMOUNT
1	UNIT/S	MODEL: KSG-IWF-25WFF-8K1M32 KOLIN WALL MOUNTED PRIMUS GOLD AIRCONDITIONER 25,560 Kj/h (2.5HP) FULL DC INVERTER W/ WIFI R-32	68,995.00	45,436.20	PHP	45,436.20
1	UNIT/S	MODEL: KSG-IWF-20WFF-8K1M32 KOLIN WALL MOUNTED PRIMUS GOLD AIRCONDITIONER 19,000 Kj/h (2.0HP) FULL DC INVERTER W/ WIFI R-32	59,595.00	38,292.20	PHP	38,292.20
1	UNIT/S	MODEL: KAG-100WCINV KOLIN WINDOW TYPE QUAD SERIES AIRCONDITIONER 10,200 Kj/h (1.0HP) FULL DC INVERTER W/ WIFI R-32 (WxDxH) 18"x25"x14"	28,995.00	20,736.20	PHP	20,736.20
TOTAL UNIT COST					PHP	104,464.60
ESTIMATED COST OF INSTALLATION (please see attached)					PHP	30,775.00
OTHERS: DELIVERY CHARGE					PHP	600.00
TOTAL ESTIMATED COST OF THE PROJECT					PHP	135,839.60

TERMS OF PAYMENT:

FULL PAYMENT OF UNIT AND DELIVERY CHARGE. IF CHECK, SUBJECT FOR 3 DAYS CLEARING.

BANK DETAILS:

\* Unit/s & Delivery: Account Name - KOLIN MARKETING INC. / Account# - 011808002307 (BDO-KALAYAAN)

\* Installation: Will be provided by assigned installer.

\*\* You may settle first payment for unit/s & delivery. Installation payment can be settled directly to installer after actual works.

WARRANTY:

FOR SPLIT TYPE : ONE (1) YEAR FREE PARTS AND LABOR, THREE YEARS (3) MAIN PCB , TEN (10) YEARS WARRANTY ON COMPRESSOR.

FOR WINDOW TYPE: ONE (1) YEAR FREE PARTS AND LABOR, THREE YEARS (3) MAIN PCB, TEN (10) YEARS WARRANTY ON COMPRESSOR.

NOTES: PRICES ARE SUBJECT TO CHANGE WITHOUT PRIOR NOTICE.

PRICES IS VAT INCLUSIVE.

\*\* Cost of Installation is Package with the Unit(s), this cost cannot avail separately (Final charges will be based on actual works).

We thank you for giving opportunity to offer our product and services, hoping we receive your purchase order.

If you need assistance, don't hesitate to call the under signed at 0917-807-8607 or email at kmi\_asst@kolinphil.com.ph

Very Truly Yours,

JANELLEN S. LIM  
KMI-ASSISTANT

Noted By  
MART NATHANIEL B. FLORES  
KMI-SUPERVISOR

Approved By

MS. EDITHA M. FLORES  
AVP - FINANCE

Conforme:

SIGNATURE OVER PRINTED NAME

KMI-QUOTE-11-25-0797-rev2  
ECY-24%/7K/1.3K

Kolin Marketing, Inc.

1854 Sta. Rita St., Guadalupe Nuevo, Makati City

Tel.: (632) 8852-6473

Fax: (632) 8852-2170 / (632) 8852-4792

www.kolinphil.com.ph / kolinphilippines



JANUARY 27, 2025

BIFFANY TAN

Unit 210 Orea Place at Vertis North by Alveo Land , Brgy Veritis North Triangle Quezon City

0917-8237004

KSG-IWF-25WFY-8K1M32	1
KSG-IWF-20WFY-8K1M32	1
KAG-100WCINV	1

OPTION 2

<b>LIVING, DINING, KITCHEN</b>	Area ≈ 32 sq.m
--------------------------------	----------------

<b>ACU 1</b>	<b>2.5hp Wallmounted Inverter</b>	<b>KSG-IWF-25WFY-8K1M32</b>					
	Estimated Pipe Length	:	10	ft			
	Estimated Royal Cord Length	:	10	ft			
	Initial Charge				P		8,500.00

Includes:

Labor  
10ft Copper Tube  
10ft Royal Cord  
Outdoor Bracket (FLOOR)  
Other Consumables

Additional Charges	Description	Unit	Price Per Unit	Subtotal
	Copper Cord (ODU-Breaker)	14 ft	P 60 / ft	P 840
	Leaktest(Existing Coppertube)	1/4" x 5/8"	1 set	P 2,000 / set
	Drain Hose	White -1/2"	7 ft	P 25 / ft
				P 175
				P 3,015.00

<b>Estimated Charges</b>	<b>P</b>	<b>11,515.00</b>
--------------------------	----------	------------------

<b>MASTER BEDROOM</b>	Area ≈ 19 sq.m
-----------------------	----------------

<b>ACU 2</b>	<b>2.0hp Wallmounted Inverter</b>	<b>KSG-IWF-20WFY-8K1M32</b>					
	Estimated Pipe Length	:	27	ft			
	Estimated Royal Cord Length	:	32	ft			
	Initial Charge				P		7,500.00

Includes:

Labor  
10ft Copper Tube  
10ft Royal Cord  
Outdoor Bracket (FLOOR)  
Other Consumables

Additional Charges	Description	Unit	Price Per Unit	Subtotal
	Copper Tube	1/4"x 1/2"	17 ft	P 350 / ft
	Royal Cord	2.mm2 x 4C	22 ft	P 100 / ft
	Royal Cord (ODU-Breaker)	3.5mm2 x 3C	14 ft	P 60 / ft
	Rubber Insulation(drainline)	11/8x 3/4x 6'	4 pc(s)	P 230 / pc
	PVC Pipe (Drain)	3/4- blue	2 pc(s)	P 150 / ft
	Drain Hose	White -1/2"	7 ft	P 25 / ft
				P 175
				P 10,385.00

<b>Estimated Charges</b>	<b>P</b>	<b>17,885.00</b>
--------------------------	----------	------------------

<b>BEDROOM1</b>	Area ≈ 10 sq.m
-----------------	----------------

<b>ACU3</b>	<b>1.0hp Windowtype Inverter</b>	<b>KAG-100WCINV</b>					
	Initial charge				P		1,200.00
	Drain Hose	White -1/2"	7 ft	P 25 / ft	P	175	P 175.00

<b>Estimated charges</b>	<b>P</b>	<b>1,375.00</b>
--------------------------	----------	-----------------

<b>Total Estimated Charges</b>	<b>P</b>	<b>30,775.00</b>
--------------------------------	----------	------------------

Validity: This quotation is valid for a period of fifteen (15) days from the date thereof, subject to our confirmation thereafter.

Note:

- 1 Location of indoor and outdoor units were agreed by the customer and Kolin's surveyor.
- 2 **KAG-100WCINV Dimension: W x D x H, = 450 X 640 x 350 mm. (18 x 25 x 14 inches)**
- 3 AC drain line will be tapped to the nearest drain provision provided by the customer's contractor.
- 4 **Coppertube and Drainline of ACU2 MASTER BEDROOM Expose in ROOM 1 and open the existing false column at the side.**
- 5 Working days: Monday to Friday, 8am- 5pm without parking for confirmation.Need working permit.
- 6 Mechanical Plans, Permits, Electrical permits not included.
- 7 Deflectors, masonry, carpentry, chipping & plastering (finishing & restoration) are not included in the installation.
- 8 Electrical power supply (feeder line) **220v/ 60hz/ 1ph**, is not included in the scope of work of Kolin.
- 9 **Final charges will be based on actual installation.**

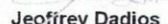

Prepared by:

  
Jeffrey Dadios  
Field Surveyor

Customer Conformance:

\_\_\_\_\_  
Signature Over Printed Name

Reviewed by

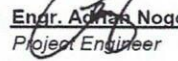
  
Engr. Adrian Nogoy  
Project Engineer

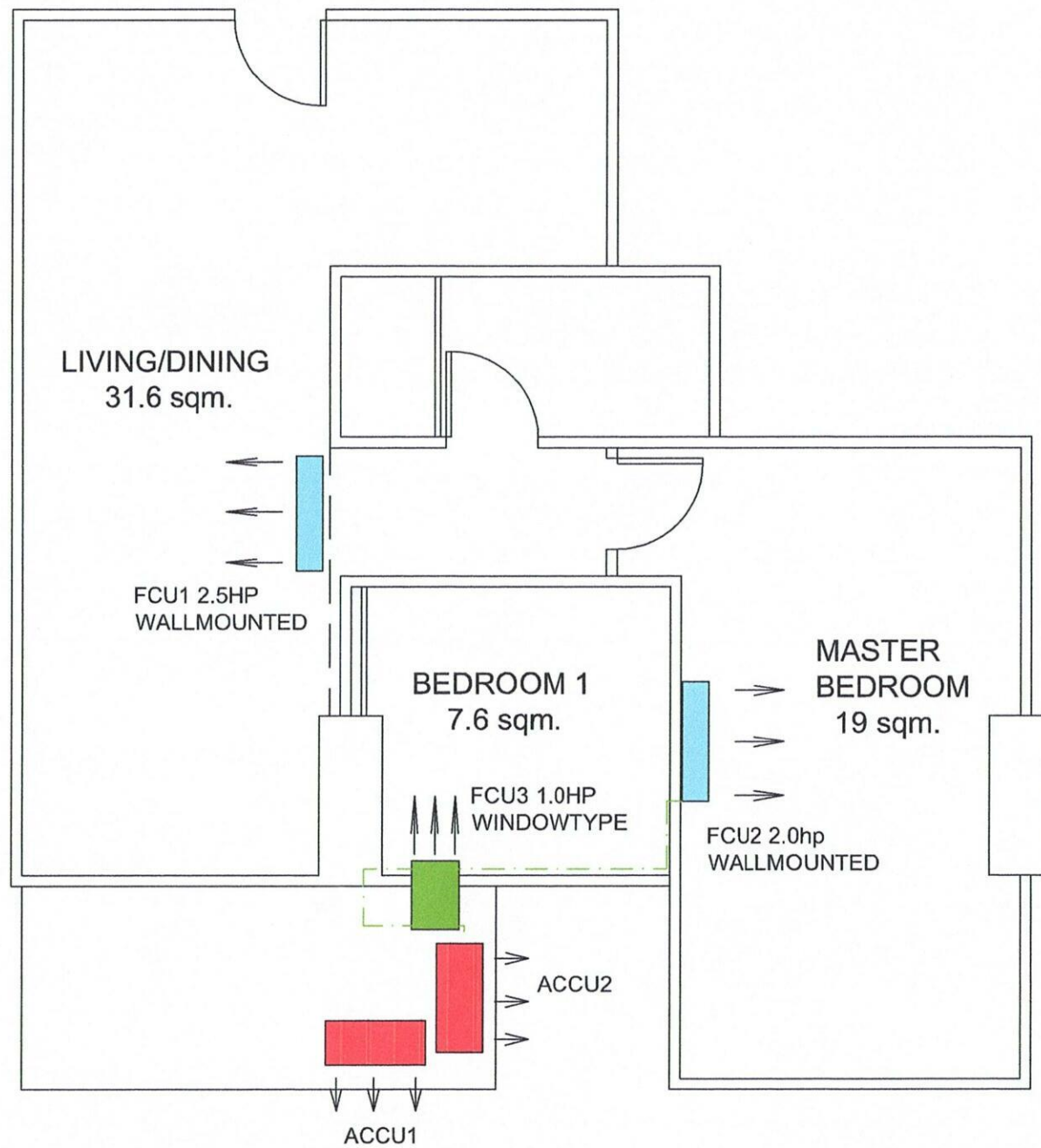

**OPTION 2~ WALL MOUNTED AND WAC- AC LAYOUT PLAN**