



January 28, 2026

MS. LIZA BONIFACIO  
2 VISAYAS ST., BRGY. BATASAN HILLS, QUEZON CITY  
TEL#: 0956-1206787

Dear Ma'am/Sir,

Kolin Marketing Inc., is extremely honored for your endorsement of Kolin brand and we are please to offer you with a special price/s for the following items.

A. EQUIPMENT & INSTALLATION

\* OPTION 1 \*

QTY	U/M	MODEL / DESCRIPTION	SRP	DISCOUNTED PRICE		AMOUNT
2	UNIT/S	MODEL: KS-IW10-MCA11201M32 KOLIN WALL MOUNTED CERTUS A/ SERIES AIRCONDITIONER 9,800 Kj/h (1.0HP) FULL DC INVERTER W/ WIFI R-32	30,995.00	17,056.20	PHP	34,112.40
TOTAL UNIT COST					PHP	34,112.40
ESTIMATED COST OF INSTALLATION (please see attached)					PHP	30,040.00
OTHERS: DELIVERY CHARGE					PHP	600.00
TOTAL ESTIMATED COST OF THE PROJECT					PHP	64,752.40

\* OPTION 2 \*

QTY	U/M	MODEL / DESCRIPTION	SRP	DISCOUNTED PRICE		AMOUNT
2	UNIT/S	MODEL: KSG-IWF-10WFF-8K1M32 KOLIN WALL MOUNTED PRIMUS GOLD AIRCONDITIONER 11,484 Kj/h (1.0HP) FULL DC INVERTER W/ WIFI R-32	42,595.00	25,372.20	PHP	50,744.40
TOTAL UNIT COST					PHP	50,744.40
ESTIMATED COST OF INSTALLATION (please see attached)					PHP	30,040.00
OTHERS: DELIVERY CHARGE					PHP	600.00
TOTAL ESTIMATED COST OF THE PROJECT					PHP	81,384.40

TERMS OF PAYMENT:

FULL PAYMENT OF UNIT AND DELIVERY CHARGE. IF CHECK, SUBJECT FOR 3 DAYS CLEARING.

BANK DETAILS:

- \* Unit/s & Delivery: Account Name - KOLIN MARKETING INC. / Account# - 011808002307 (BDO-KALAYAAN)
- \* Installation: Will be provided by assigned installer.
- \*\* You may settle first payment for unit/s & delivery. Installation payment can be settled directly to installer after actual works.

WARRANTY:

FOR SPLIT TYPE : ONE (1) YEAR FREE PARTS AND LABOR, THREE YEARS (3) MAIN PCB , TEN (10) YEARS WARRANTY ON COMPRESSOR.

NOTES: PRICES ARE SUBJECT TO CHANGE WITHOUT PRIOR NOTICE.

PRICES IS VAT INCLUSIVE.

\*\* Cost of Installation is Package with the Unit(s), this cost cannot avail separately (cost will be based on actual works).

We thank you for giving opportunity to offer our product and services, hoping we receive your purchase order.

If you need assistance, don't hesitate to call the under signed at 0917-807-8607 or email at kmi\_asst@kolinphil.com.ph

Very Truly Yours,

JANELLEN S. LIM  
KMI-ASSISTANT

Noted by:

MART NATHANIEL R. FLORES  
KMI-SUPERVISOR

Approved By:

MS. EDITHA M. FLORES  
AVP - FINANCE

KMI-QUOTE-01-26-0050  
EMF-24%/6.5K/7K

Conforme:

SIGNATURE OVER PRINTED NAME

Kolin Marketing, Inc.

1854 Sta. Rita St., Guadalupe Nuevo, Makati City

Tel.: (632) 8852-6473

Fax: (632) 8852-2170 / (632) 8852-4792

www.kolinphil.com.ph / kolinphilippines





JANUARY 27, 2026

LIZA BONIFACIO

Landmark: 2 Visayas St. Brgy Batasan Hills, Quezon City

0956-1206787

KS-IW10-MCAI1201M32

2

NIKA ROOM						Area ≈ 8 sq.m	
ACU 1	1.0hp Wallmounted Inverter	KS-IW10-MCAI1201M32					
	Estimated Pipe Length	:	15	ft			
	Estimated Royal Cord Length	:	20	ft			
	Initial Charge		(7500-800)			P	6,700.00
	Includes:						Less Outdoor Bracket
	Labor						
	10ft Copper Tube						
	10ft Royal Cord						
	Other Consumables						
Additional Charges		Description	Unit	Price Per Unit		Subtotal	
	Copper Tube	1/4"x 3/8"	5 ft	P	350 / ft	P	1,750
	Royal Cord	2.mm2 x 4C	10 ft	P	100 / ft	P	1,000
	Royal Cord (ODU-Breaker)	3.5mm2 x 3C	7 ft	P	60 / ft	P	420
	Dismantle	1.0hp	1 pc(s)	P	2,500 / pc	P	2,500
	Drainhose	white 1/2"	7 ft	P	25 / pc	P	175
							5,845.00
Estimated Charges						P	12,545.00

ALY ROOM						Area ≈ 7.3 sq.m	
ACU 2	1.0hp Wallmounted Inverter	KS-IW10-MCAI1201M32					
	Estimated Pipe Length	:	25	ft			
	Estimated Royal Cord Length	:	30	ft			
	Initial Charge		(7500-800)			P	6,700.00
	Includes:						Less Outdoor Bracket
	Labor						
	10ft Copper Tube						
	10ft Royal Cord						
	Other Consumables						
Additional Charges		Description	Unit	Price Per Unit		Subtotal	
	Copper Tube	1/4"x 3/8"	15 ft	P	350 / ft	P	5,250
	Royal Cord	2.mm2 x 4C	20 ft	P	100 / ft	P	2,000
	Royal Cord (ODU-Breaker)	3.5mm2 x 3C	7 ft	P	60 / ft	P	420
	Dismantle	1.0hp	1 pc(s)	P	2,500 / pc	P	2,500
	PVC	Blue- 3/4"	3 pc(s)	P	150 / pc	P	450
	Drainhose	white 1/2"	7 ft	P	25 / pc	P	175
							10,795.00
Estimated Charges						P	17,495.00
Total Estimated Charges						P	30,040.00

Validity: This quotation is valid for a period of fifteen (15) days from the date thereof, subject to our confirmation thereafter.

**Note:**

- 1 Location of indoor and outdoor units agree by customer and kolin surveyor.
- 2 AC drain line will be tapped to the nearest drain provision provided by the customer's contractor.
- 3 Expose coppertube in the Area.make a bigger loop at the back of unit to prevent the water to come down.
- 4 Schedule for markings first for pipe layout and drain provisions. Repipe the drainline of ACU2.
- 5 Working days: Saturday-Sunday Only, 8am- 5pm., with Parking. **Bring Harness.Bring sealant for the hole .**
- 6 Mechanical Plans, Permits, Electrical permits not included.
- 7 Deflectors, masonry, carpentry, chipping & plastering (finishing & restoration) are not included in the installation.
- 8 Electrical power supply (feeder line) is not included in the scope of work of Kolin.
- 9 Final charges will be based on actual installation.

Prepared by:

Customer Conformer:

Jeffrey Dadios

Field Surveyor

Signature Over Printed Name

Reviewed by:

Engr. Adrian Nogoy

Project Engineer

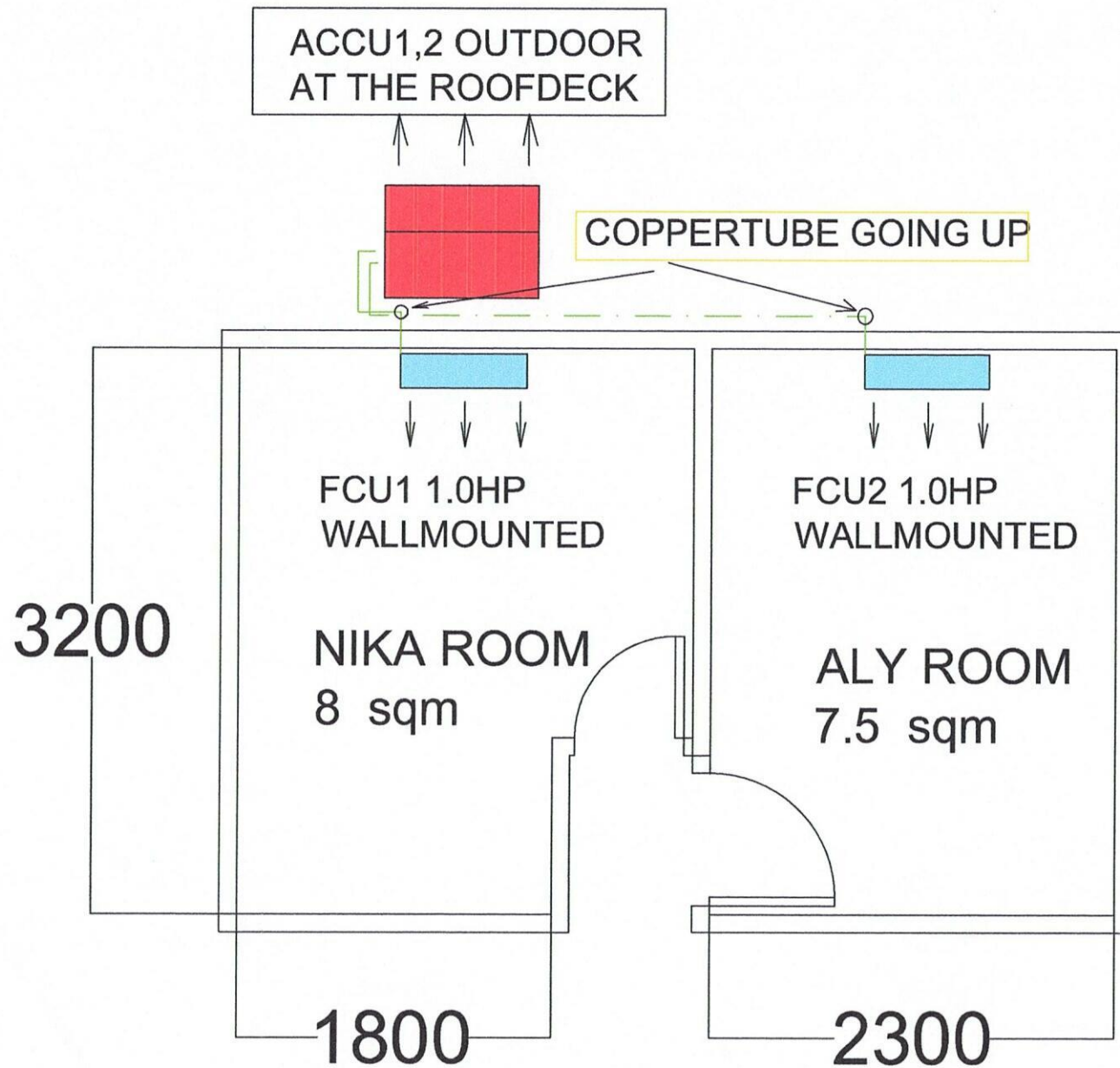

**LIZA BONIFACIO- AC LAYOUT PLAN**