



July 2, 2025

MS. JOSEPHINE GUBATINA
1626 INSTRUCCION ST., BRGY. 495, SAMPALOC MANILA
TEL#: 0917-8460161

Dear Ma'am/Sir,

Kolin Marketing Inc., is extremely honored for your endorsement of Kolin brand and we are please to offer you with a special price/s for the following items.

A. EQUIPMENT & INSTALLATION

QTY	U/M	MODEL / DESCRIPTION	SRP	DISCOUNTED PRICE		AMOUNT
1	UNIT/S	MODEL: KSG-IWF-30WFY-8K1M32 KOLIN WALL MOUNTED PRIMUS GOLD AIRCONDITIONER 29,500 Kj/h (3.0HP) FULL DC INVERTER W/ WIFI R-32	76,595.00	51,212.20	PHP	51,212.20
1	UNIT/S	MODEL: KSM-IW20-WCT10M1M32 KOLIN WALL MOUNTED CERTUS SERIES AIRCONDITIONER 18,990 Kj/h (2.0HP) REGULAR INVERTER R-32	41,995.00	27,916.20	PHP	27,916.20
TOTAL UNIT COST					PHP	79,128.40
ESTIMATED COST OF INSTALLATION (please see attached)					PHP	46,150.00
OTHERS: DELIVERY CHARGE					PHP	600.00
TOTAL ESTIMATED COST OF THE PROJECT					PHP	125,878.40

TERMS OF PAYMENT:

FULL PAYMENT OF UNIT AND DELIVERY CHARGE. IF CHECK, SUBJECT FOR 3 DAYS CLEARING.

WARRANTY:

FOR SPLIT TYPE : ONE (1) YEAR FREE PARTS AND LABOR, THREE YEARS (3) MAIN PCB , TEN (10) YEARS WARRANTY ON COMPRESSOR.

NOTES: *** Need to sign waiver agreement due to under capacity of unit choice. (ACU1)

PRICES ARE SUBJECT TO CHANGE WITHOUT PRIOR NOTICE.

PRICES IS VAT INCLUSIVE.

**** Cost of Installation is Package with the Unit(s), this cost cannot avail separately (cost will be based on actual works).**

***** You may settle first payment for unit/s & delivery. Installation payment can be settled directly to installer after actual works.**

We thank you for giving opportunity to offer our product and services, hoping we receive your purchase order.

If you need assistance, don't hesitate to call the under signed at 0917-807-8607 or email at kmi_asst@kolinphil.com.ph

Very Truly Yours,

JANELLEN S. LIM
KMI-ASSISTANT

Noted by;

MART NATHANIEL R. FLORES
KMI-SUPERVISOR

Approved By:

MS. EDITHA M. FLORES
AVP - FINANCE

KMI-QUOTE-07-25-0517
OMF-24%/7K/4K

Conforme:

SIGNATURE OVER PRINTED NAME

Kolin Marketing, Inc.
1854 Sta. Rita St., Guadalupe Nuevo, Makati City
Tel.: (632) 8852-6473
Fax: (632) 8852-2170 / (632) 8852-4792
www.kolinphil.com.ph / kolinphilippines

July 01, 2025
 Josephine Gubatina
 1626 Instruccion St. Brgy 495 Sampaloc Manila
 0917-8460161

MODEL	Qty
KSG-IWF-30Wfy8K1M32	1
KSM-IW20-WCT10M1M32	1

OFFICE	Area	33 sqm
---------------	------	--------

ACU 1 3.0 HP Wall Mounted Inverter *KSG-IWF-30Wfy8K1M32*

Estimated Pipe Length = 43 ft

Estimated Royal Cord Length = 48 ft

Initial Charge ₱ 8,500.00

Includes:

- Labor
- 10ft Copper Tube
- 10ft Royal Cord
- Outdoor Bracket (Wall)
- Consumables

Installation Materials	Description	Qty	Price per qty	Subtotal
Copper Tube	Ø 1/4" x Ø 5/8"	33 ft	₱ 400.00/ft	₱ 13,200.00
Royal Cord (comm. wire)	2.mm2 x 4C	38 ft	₱ 100.00/ft	₱ 3,800.00
Royal Cord (ACCU-Breaker)	3.5mm x 3c	5 ft	₱ 60.00/ft	₱ 300.00
Circuit Breaker waterproof	30A / 1Ph	1 pc/s	₱ 1,000.00/pc	₱ 1,000.00
PVC blue	3/4" x 10'	4 pc/s	₱ 150.00/pc	₱ 600.00
				<u>₱ 18,900.00</u>

Estimated Charges	₱ 27,400.00
--------------------------	--------------------

BARRACKS	Area	24 sqm
-----------------	------	--------

ACU 2 2.0 HP Wall Mounted Inverter *KSM-IW20-WCT10M1M32*

Estimated Pipe Length = 30 ft

Estimated Royal Cord Length = 35 ft

Initial Charge ₱ 7,500.00

Includes:

- Labor
- 10ft Copper Tube
- 10ft Royal Cord
- Outdoor Bracket (Wall)
- Consumables

Installation Materials	Description	Qty	Price per qty	Subtotal
Copper Tube	Ø 1/4" x Ø 1/2"	20 ft	₱ 350.00/ft	₱ 7,000.00
Royal Cord (comm. wire)	2.mm2 x 4C	25 ft	₱ 100.00/ft	₱ 2,500.00
Royal Cord (ACCU-Breaker)	3.5mm x 3c	5 ft	₱ 60.00/ft	₱ 300.00
Circuit Breaker waterproof	30A / 1Ph	1 pc/s	₱ 1,000.00/pc	₱ 1,000.00
PVC blue	3/4" x 10'	3 pc/s	₱ 150.00/pc	₱ 450.00
				<u>₱ 11,250.00</u>

Estimated Charges	₱ 18,750.00
--------------------------	--------------------

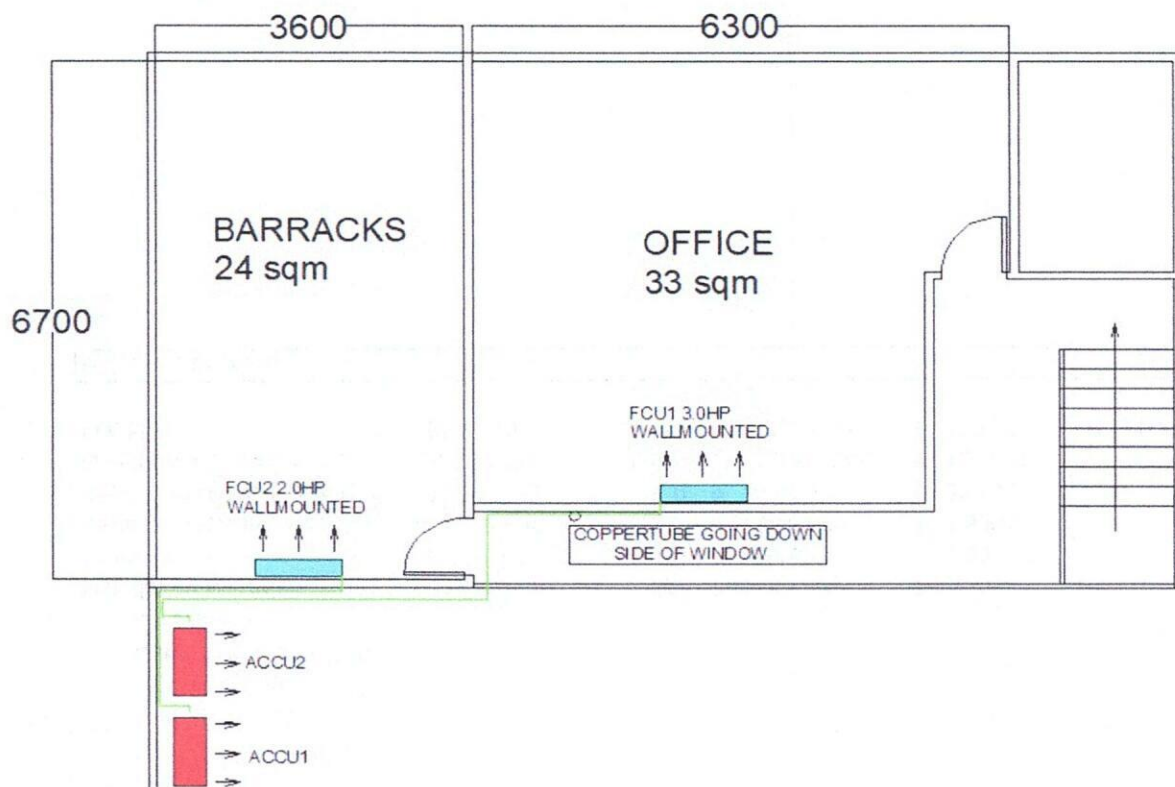

Total Estimated Charges

₱ 46,150.00

Validity: This quotation is valid for a period of fifteen (15) days from the date thereof, subject to our confirmation thereafter.

Installation notes:

- 1 Location of indoor and outdoor units were agreed by the customer and Kolin's surveyor.
- 2 AC drain line will be tapped to the nearest drain provision provided by the customer's contractor.
- 3 Coppertube and Drainline expose inside the area. Bring plywood 3/4 inch for indoor Backing.
- 4 ACU1 Need WAIVER due to undercapacity.**
- 5 Working days: Monday to Saturday, 8am- 5pm with parking.
- 6 Mechanical Plans, Permits, Electrical permits not included.
- 7 Deflectors, masonry, carpentry, chipping & plastering (finishing & restoration) are not included in the installation.
- 8 Air conditioning drain line and Electrical power supply (feeder line) **220v/ 60hz/ 1PH** , should be provided by customer's contractor, Outdoor location / Breaker.
- 9 Final charges will be based on actual installation.**

Prepared by:

Jeffrey Dadios
Jeffrey Dadios
Field Surveyor

Customer Conformer:

Signature Over Printed Name

Reviewed by:

Engr. Kenneth Zamora
Engr. Kenneth Zamora
Service Supervisor Shop and
Field Operation