



July 30, 2025

DEPARTMENT A

UNIT 2B MSD BLDG. KALAYAAN AVE., 5945 GLORIA ST., BRGY. POBLACION, MAKATI CITY

TEL#: 0920-7185279 / 0927-4848469

Email: hello.dpatmnta@gmail.com

Dear Ma'am/Sir,

Kolin Marketing Inc., is extremely honored for your endorsement of Kolin brand and we are please to offer you with a special price/s for the following items.

A. EQUIPMENT & INSTALLATION

QTY	U/M	MODEL / DESCRIPTION	SRP	DISCOUNTED PRICE		AMOUNT
1	UNIT/S	MODEL: KSM-IW25-WCT10M1M32 KOLIN WALL MOUNTED CERTUS AIRCONDITIONER 23,210 Kj/h (2.5HP) REGULAR INVERTER W/ WIFI R-32	49,995.00	33,996.20 ✓	PHP	33,996.20
2	UNIT/S	MODEL: KSM-IW15-WCT10M1M32 KOLIN WALL MOUNTED CERTUS SERIES AIRCONDITIONER 12,660 Kj/h (1.5HP) REGULAR INVERTER W/ WIFI R-32	32,995.00	21,076.20 ✓	PHP	42,152.40
TOTAL UNIT COST					PHP	76,148.60
ESTIMATED COST OF INSTALLATION (please see attached)					PHP	39,100.00
OTHERS: DELIVERY CHARGE					PHP	600.00
TOTAL ESTIMATED COST OF THE PROJECT					PHP	115,848.60

TERMS OF PAYMENT:

FULL PAYMENT OF UNIT AND DELIVERY CHARGE. IF CHECK, SUBJECT FOR 3 DAYS CLEARING.

WARRANTY:

FOR SPLIT TYPE : ONE (1) YEAR FREE PARTS AND LABOR, THREE YEARS (3) MAIN PCB , TEN (10) YEARS WARRANTY ON COMPRESSOR.

NOTES: PRICES ARE SUBJECT TO CHANGE WITHOUT PRIOR NOTICE.

PRICES IS VAT INCLUSIVE.

** Cost of Installation is Package with the Unit(s), this cost cannot avail separately (cost will be based on actual works).

*** You may settle first payment for unit/s & delivery. Installation payment can be settled directly to installer after actual works.

We thank you for giving opportunity to offer our product and services, hoping we receive your purchase order.

If you need assistance, don't hesitate to call the under signed at 0917-807-8607 or email at kmi_asst@kolinphil.com.ph

Very Truly Yours,

JANELLEN S. LIM
KMI-ASSISTANT

Noted By:

MART NATHANIEL R. FLORES
KMI-SUPERVISOR

Approved By:

MS. EDITHA M. FLORES
AVP - FINANCE

KMI-QUOTE-07-25-0582
OMF-24%/4K

Conforme:

SIGNATURE OVER PRINTED NAME

Kolin Marketing, Inc.

1854 Sta. Rita St., Guadalupe Nuevo, Makati City

Tel.: (632) 8852-6473

Fax: (632) 8852-2170 / (632) 8852-4792

www.kolinphil.com.ph / kolinphilippines



July 30, 2025

DEPARTMENT A

Unit 2B MSD Bldg. Kalayaan Ave. 5945 Gloria St. Brgy Poblacion, Makati City

0920-7185279, 0927-4848469

hello.dpatmmta@gmail.com

Model	Qty
KSM-IW25-WCT10M1M32	1
KSM-IW15-WCT10M1M32	2

COMMON AREA	Area ≈ 21 sq.m
-------------	----------------

ACU 1	2.5hp Wallmounted Inverter	KSM-IW25-WCT10M1M32				
	Estimated Pipe Length :	10	ft			
	Estimated Royal Cord Length :	15	ft			
	Initial Charge				P	7,700.00
	Includes:				/	
	Labor					Less Outdoor
	10ft Copper Tube				1	Bracket
	10ft Royal Cord					
	Other Consumables					
	Additional Charges	Description	Unit	Price Per Unit	Subtotal	
	Royal Cord	2.mm2 x 4C	5 ft	P 100.00 / ft	P	500.00
	Royal Cord (ODU-Breaker)	3.5mm2 x 3C	5 ft	P 60.00 / ft	P	300.00
	Circuit Breaker(NEMA)	30A/ 1Ph	1 pc(s)	P 1,000.00 / pc	P	1,000.00 \
	Outdoor Bracket (fabricated)	wall with ledge	1 pc(s)	P 6,500.00 / pc	P	6,500.00 \
	PVC (Drainline)	blue-3/4"	2 pc(s)	P 150.00 / pc	P	300.00
					P	8,600.00

Estimated Charges	P 16,300.00
-------------------	-------------

OFFICE1	Area ≈ 11.4 sq.m
---------	------------------

ACU 2	1.5hp Wallmounted Inverter	KSM-IW15-WCT10M1M32			
	Estimated Pipe Length :	14	ft		
	Estimated Royal Cord Length :	19	ft		
	Initial Charge				P 7,500.00
	Includes:				
	Labor				
	10ft Copper Tube				
	10ft Royal Cord				
	Outdoor Bracket (floor)				
	Other Consumables				
	Additional Charges	Description	Unit	Price Per Unit	Subtotal
	Copper Tube	1/4"x 1/2"	4 ft	P 350.00 / ft	P 1,400.00 \
	Royal Cord	2.mm2 x 4C	9 ft	P 100.00 / ft	P 900.00 \
	Royal Cord (ODU-Breaker)	3.5mm2 x 3C	5 ft	P 60.00 / ft	P 300.00
	Circuit Breaker(NEMA)	20A/ 1Ph	1 pc(s)	P 1,000.00 / pc	P 1,000.00 \
	PVC (Drainline)	blue-3/4"	2 pc(s)	P 150.00 / pc	P 300.00 P 3,900.00

Estimated Charges	P 11,400.00
-------------------	-------------

OFFICE2	Area ≈ 13.7 sq.m
----------------	------------------

ACU 3 1.5hp Wallmounted Inverter *KSM-IW15-WCT10M1M32*
 Estimated Pipe Length : 14 ft
 Estimated Royal Cord Length : 19 ft
 Initial Charge P 7,500.00

Includes:

Labor
 10ft Copper Tube
 10ft Royal Cord
 Outdoor Bracket (floor)
 Other Consumables

Additional Charges	Description	Unit	Price Per Unit	Subtotal
Copper Tube	1/4"x 3/8"	4 ft P	350.00 / ft P	1,400.00
Royal Cord	2.mm2 x 4C	9 ft P	100.00 / ft P	900.00
Royal Cord (ODU-Breaker)	3.5mm2 x 3C	5 ft P	60.00 / ft P	300.00
Circuit Breaker(NEMA)	30A/ 1Ph	1 pc(s) P	1,000.00 / pc P	1,000.00
PVC (Drainline)	blue-3/4"	2 pc(s) P	150.00 / pc P	300.00 P 3,900.00

Estimated Charges	P 11,400.00
--------------------------	--------------------

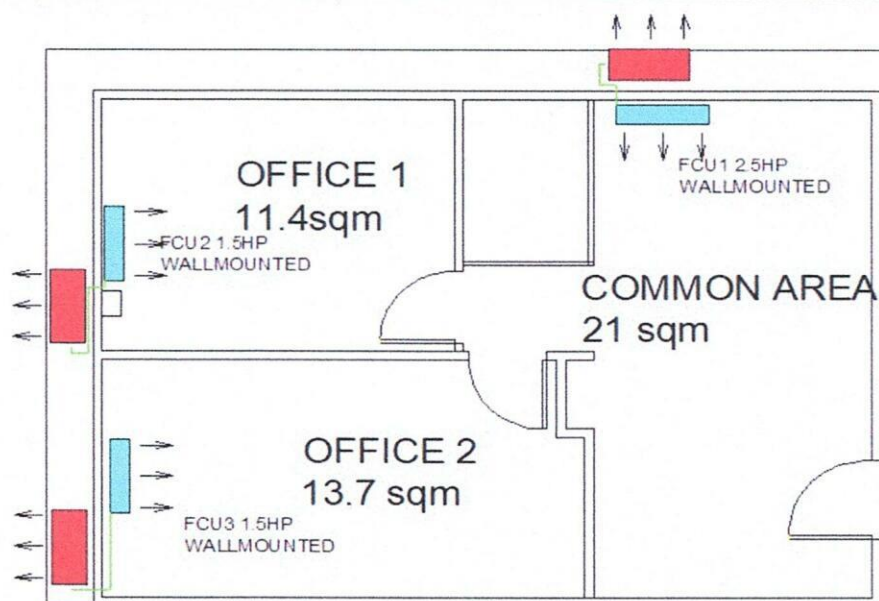

Total Estimated Charges	P 39,100.00
--------------------------------	--------------------

This quotation is valid for a period of fifteen (15) days from the date thereof, subject to our confirmation thereafter.

Validity:

Note:

- 1 Location of indoor and outdoor units were agreed by the customer and Kolin's surveyor.
- 2 AC drain line will be tapped to the nearest drain provision provided by the customer's contractor.
- 3 Expose coppertube in the area. Onsite Fabricated outdoor Bracket.
- 4 Working days: Monday to Saturday, 8am- 5pm with parking. bring harness and rope.
- 5 Mechanical Plans, Permits, Electrical permits not included.
- 6 Deflectors, masonry, carpentry, chipping & plastering (finishing & restoration) are not included in the installation.
- 7 Electrical power supply (feeder line) **220v/ 60hz/ 1ph**, is not included in the scope of work of Kolin.
- 8 **Final charges will be based on actual installation.**

Prepared by:

Jeoffrey Dadios
 Field Surveyor

Customer Conformee:

Signature Over Printed Name

Reviewed by:

Engr. Kenneth Zamora
 Service Supervisor
 Field and Shop Operation