



June 17, 2025

MR. LEO VENEZUELA  
ATTN: MS. VERONICA VALDES  
UNIT 22D STRATA GOLD CONDOMINIUM, 738 ONGPIN ST BINONDO MANILA  
TEL#: 0917-8135997

Dear Ma'am/Sir,

Kolin Marketing Inc., is extremely honored for your endorsement of Kolin brand and we are please to offer you with a special price/s for the following items.

A. EQUIPMENT & INSTALLATION

*\* MASTER'S BEDROOM \**

QTY	U/M	MODEL / DESCRIPTION	SRP	DISCOUNTED PRICE		AMOUNT
1	UNIT/S	MODEL: KSG-IWF-30Wfy-8K1M32 KOLIN WALL MOUNTED PRIMUS GOLD AIRCONDITIONER 29,500 Kj/h (3.0HP) FULL DC INVERTER W/ WIFI R-32	76,595.00	51,212.20	PHP	51,212.20
TOTAL UNIT COST					PHP	51,212.20
ESTIMATED COST OF INSTALLATION (please see attached)					PHP	13,445.00
OTHERS: DELIVERY CHARGE					PHP	600.00
TOTAL ESTIMATED COST OF THE PROJECT					PHP	65,257.20

TERMS OF PAYMENT:

FULL PAYMENT OF UNIT AND DELIVERY CHARGE. IF CHECK, SUBJECT FOR 3 DAYS CLEARING.

WARRANTY:

FOR SPLIT TYPE : ONE (1) YEAR FREE PARTS AND LABOR, THREE YEARS (3) MAIN PCB , TEN (10) YEARS WARRANTY ON COMPRESSOR.

NOTES: PRICES ARE SUBJECT TO CHANGE WITHOUT PRIOR NOTICE.

PRICES IS VAT INCLUSIVE.

**\*\* Cost of Installation is Package with the Unit(s), this cost cannot avail separately (cost will be based on actual).**

We thank you for giving opportunity to offer our product and services, hoping we receive your purchase order.

If you need assistance, don't hesitate to call the under signed at 0917-807-8607 or email at [kmi\\_asst@kolinphil.com.ph](mailto:kmi_asst@kolinphil.com.ph)

Very Truly Yours,

JANELLEN S. LIM  
KMI-ASSISTANT

Noted by:

MART NATHANIEL R. FLORES  
KMI-SUPERVISOR

Approved By:

MS. EDITHA M. FLORES  
AVP - FINANCE

KMI-QUOTE-06-25-0466-rev  
REG-24%/7K

Conforme:

SIGNATURE OVER PRINTED NAME

Kolin Marketing, Inc.  
1854 Sta. Rita St., Guadalupe Nuevo, Makati City  
Tel.: (632) 8852-6473  
Fax: (632) 8852-2170 / (632) 8852-4792  
[www.kolinphil.com.ph](http://www.kolinphil.com.ph) / [kolinphilippines](http://kolinphilippines)





**KOLIN Philippines International Inc.**  
**Survey Form**

Nº 003660

Customer Name : LEO VENEZUELA Date : 6-14-15  
 Address : UNIT 2ND STREET GOLD CORNER 738 ORANGE ST SJR No. : 261060  
BHOLDO, MXP/BA  
 Establishment Type : Residential ☒ Area Surveyed : MASTER BED ROOM  
 Commercial ☐ Area Surveyed : \_\_\_\_\_  
 Recommended Product Model : K50-1WF 30WFX-6K1M31

**Cooling Capacity Computation**

Floor Area : 27 sqm.  
 Ceiling Height : 2.4 mtr.

note: add 20% per meter in excess of 3 meters in the initial cooling capacity computed.

Floor Area :	<u>27</u>	x	550 Btu/h	<u>14850</u> Btu/h
Ceiling Height (excess of 3 mtrs.) :		x	20%	
Window Direct Sunlight		x	20% - 50%	<u>2970</u> Btu/h
Total Cooling Capacity				<u>17,820</u> Btu/h

**Add : Additional Heat Load**

No. of Person	<u>2</u>	x	300 Btu/h	<u>600</u> Btu/h
No. of Ordinary Light (<40w)	<u>5</u>	x	200 Btu/h	<u>1000</u> Btu/h
No. of Special Light (>40w)		x	400 Btu/h	
No. of Refrigerator (< 6 cu.ft.)		x	400 Btu/h	
No. of Refrigerator (> 6 cu.ft.)		x	800 Btu/h	
No. of Cooking Range		x	1500 Btu/h	
No. of Laptop Computer		x	150 Btu/h	
No. of Desktop Computer <u>1/TV</u>	<u>1</u>	x	400 Btu/h	<u>400</u> Btu/h
No. of Printer		x	500 Btu/h	
No. of Photocopier		x	1000 Btu/h	
Total Cooling Capacity				<u>2000</u> Btu/h

**Recommended Cooling Capacity**

19,820 Btu/h

Note : Compressor warranty will be reduced to \_\_\_\_ yr. if air-conditioner purchased is lower than the recommended cooling capacity or pipe lay-out is beyond the maximum allowable length.

**Scope of Work Agreement**

- |                                   |  |  |
|-----------------------------------|--|--|
| 1. Copper tube lay-out            | <input type="checkbox"/> Expose                            | <input type="checkbox"/> Embedded                                    |
| 2. Chipping                       | <input type="checkbox"/> Included                          | <input checked="" type="checkbox"/> Not Included                     |
| 3. Fabricated Bracket             | <input type="checkbox"/> Yes <input type="checkbox"/> Shop | <input type="checkbox"/> Site <input checked="" type="checkbox"/> No |
| 4. Service Ledge                  | <input type="checkbox"/> Yes                               | <input checked="" type="checkbox"/> No                               |
| 5. Dismantling of existing Aircon | <input checked="" type="checkbox"/> Included               | <input type="checkbox"/> Not Included                                |
| 6. Ducting                        | <input type="checkbox"/> Yes                               | <input checked="" type="checkbox"/> No                               |

**Dimension :**

- Plastering, carpentry and restoration works are to be done by the customer.
- Wiring of electrical supply from main panel to air-conditioning unit are to be done by the customer.
- Processing of mechanical plan, working permit, electrical permit are to be done by the customer.

10. Other concern: DISMANTLE AND REMOVE COPPER TUBE  
AND UNIT. NEED WORKING PERMIT AND. TRAVEL  
FOR PERMISSION TO MAKE A NEW HOLE  
FOR THE UNIT. COPIES TUBE. TRAVEL  
FOR COPPER TUBE OR PAY WORKING



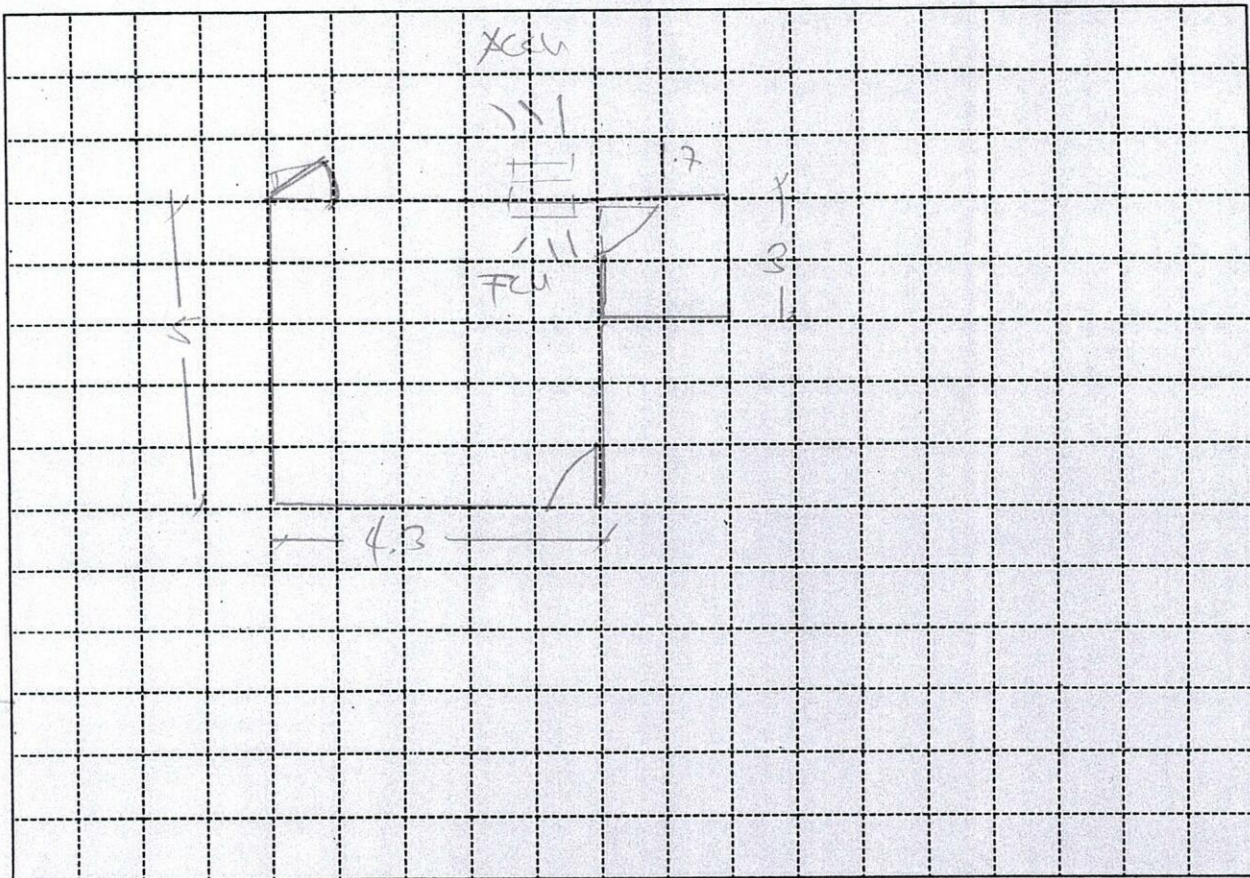

Indoor Unit Location : NEAR CP DOOR NEW LOCATION  
 Outdoor Unit Location : AT THE BACK EXISTING  
 Pipe Length : 3 METERS / 10 FT  
 Special Note : \_\_\_\_\_

## Installation Cost Estimate

Material Description	Qty.	Unit Cost	Total Cost
Copper Tube (excess of 10 ft.) 2330, 2430, 2520, 3520, 4620			
Wire (Royal Cord-signal wire) (excess of 10ft.) 2.0mmx4C	100	100	100
Wire (Royal Cord - Breaker to ODU) 3.5mm / 5.5mm x 3C	100	100	100
Circuit Breaker 20A, 30A, 40A/1ph, 40A/3ph	1	1000	1000
Bracket (ODU) (Imptd. / Fabricated) : (Floor / Wall)			
Bracket (WAC) Angle Type			
PVC Pipe (drain) 1/2" , 3/4"	1	150	150
PVC Pipe (electrical) 3/4" , 1"			
Drain Pump			
Drain Pump Hose 1/2" mtr.	175	75	175
Chipping Works			
Dismantling Fee (existing air-conditioner) 2.0			2000
Initial Charge			8500
TOTAL ESTIMATE			P 13,445-

## Note :

- Initial Charge includes labor, 10ft. Copper tube, 10ft. Royal cord, Circuit breaker, Outdoor Bracket (SAC), Indoor Bracket (PAC) and Consumable materials.
- Survey fee will be deducted in the installation fee.

Prepared by:

JEFFREY D. X. 10/03  
 Signature Over Printed Name

Customer Conforme:

Signature  
 Signature Over Printed Name