



June 18, 2025

MR. ADRIAN CHING  
11 ATOK ST., BRGY. STO. DOMINGO, QUEZON CITY  
TEL#: 0917-3114678

Dear Ma'am/Sir,

Kolin Marketing Inc., is extremely honored for your endorsement of Kolin brand and we are please to offer you with a special price/s for the following items.

A. EQUIPMENT & INSTALLATION

\* OPTION 2 \*

QTY	U/M	MODEL / DESCRIPTION	SRP	DISCOUNTED PRICE		AMOUNT
1	UNIT/S	MODEL: KSM-IW20-WCT10M1M32 KOLIN WALL MOUNTED CERTUS SERIES AIRCONDITIONER 18,990 Kj/h (2.0HP) REGULAR INVERTER R-32	41,995.00	27,916.20	PHP	27,916.20
1	UNIT/S	MODEL: KA-150MCARINV32 KOLIN WINDOW TYPE CREO SERIES AIRCONDITIONER 12,800 Kj/h (1.5HP) FULL DC INVERTER R-32 WITH REMOTE (WxDxH) 17.7"x26.6"x13.8"	27,995.00	20,276.20	PHP	20,276.20
1	UNIT/S	MODEL: KSM-IW10-WCT10M1M32 KOLIN WALL MOUNTED CERTUS SERIES AIRCONDITIONER 9,800 Kj/h (1.0HP) REGULAR INVERTER R-32	29,995.00	18,796.20	PHP	18,796.20
TOTAL UNIT COST					PHP	66,988.60
ESTIMATED COST OF INSTALLATION (please see attached)					PHP	28,050.00
OTHERS: DELIVERY CHARGE					PHP	600.00
TOTAL ESTIMATED COST OF THE PROJECT					PHP	95,638.60

TERMS OF PAYMENT:

FULL PAYMENT OF UNIT AND DELIVERY CHARGE. IF CHECK, SUBJECT FOR 3 DAYS CLEARING.

WARRANTY:

FOR SPLIT TYPE : ONE (1) YEAR FREE PARTS AND LABOR, THREE YEARS (3) MAIN PCB , TEN (10) YEARS WARRANTY ON COMPRESSOR.  
FOR WINDOW TYPE: ONE (1) YEAR FREE PARTS AND LABOR, THREE YEARS (3) MAIN PCB, TEN (10) YEARS WARRANTY ON COMPRESSOR.

NOTES: PRICES ARE SUBJECT TO CHANGE WITHOUT PRIOR NOTICE.

PRICES IS VAT INCLUSIVE.

\*\* Cost of Installation is Package with the Unit(s), this cost cannot avail separately (cost will be based on actual works).

\*\*\* You may settle first payment for unit/s & delivery. Installation payment can be settled directly to installer after actual works.

We thank you for giving opportunity to offer our product and services, hoping we receive your purchase order.

If you need assistance, don't hesitate to call the under signed at 0917-807-8607 or email at kmi\_asst@kolinphil.com.ph

Very Truly Yours,

JANELLEN S. LIM  
KMI-ASSISTANT

Noted by:

MART NATHANIEL R. FLORES  
KMI-SUPERVISOR

Approved By:

MS. EDITHA M. FLORES  
AVP - FINANCE

KMI-QUOTE-06-25-0461-rev1  
JCY-24%/4K/1K

Conforme:

SIGNATURE OVER PRINTED NAME

Kolin Marketing, Inc.  
1854 Sta. Rita St., Guadalupe Nuevo, Makati City  
Tel.: (632) 8852-6473  
Fax: (632) 8852-2170 / (632) 8852-4792  
www.kolinphil.com.ph / kolinphilippines



June 17, 2025

ADRIAN CHING

11 Atok St. Brgy Sto Domingo, Quezon City

0917-3114678

MODEL	QUANTITY
KSG-IWF-20Wfy8K1M32	1
KAG-145WCINV	1
<del>KSG-IWF-10Wfy8K1M32</del>	1

revision1

<b>LIVING/DINING</b>	Area ≈ 25 sq.m
----------------------	----------------

ACU 1	2.0hp Wall mounted Inverter	KSG-IWF-20Wfy8K1M32					
	Estimated Pipe Length :	17	ft				
	Estimated Royal Cord Length :	22	ft				
	Initial Charge					P	7,500.00
	Includes:						
	Labor						
	10ft Copper Tube						
	10ft Royal Cord						
	Outdoor Bracket						
	Other Consumables						
	<b>Additional Charges</b>	<b>Description</b>	<b>Unit</b>	<b>Price Per Unit</b>		<b>Subtotal</b>	
	Copper Tube	1/4"x 1/2"	7 ft	P 350.00 / ft	P	2,450.00	
	Royal Cord	2.mm2 x 4C	12 ft	P 100.00 / ft	P	1,200.00	
	Royal Cord (ODU-Breaker)	3.5mm2 x 3C	5 ft	P 60.00 / ft	P	300.00	
	Circuit Breaker(NEMA)	30A/ 1Ph	1 pc(s)	P 1,000.00 / pc	P	1,000.00	P 4,950.00
	<b>Estimated Charges</b>					P	12,450.00

<b>MASTER BEDROOM</b>	Area ≈ 11 sq.m
-----------------------	----------------

ACU2	1.5hp Windowtype Inverter	KAG-145WCINV					
	Initial charge					P	1,200.00
	Angle Bracket					P	600.00
	<b>Estimated charges</b>					P	1,800.00

<b>FATHERS ROOM</b>	Area ≈ 8 sq.m
---------------------	---------------

ACU 3	1.0hp Wall mounted Inverter	KSG-IWF-10Wfy8K1M32					
	Estimated Pipe Length :	20	ft				
	Estimated Royal Cord Length :	25	ft				
	Initial Charge					P	7,500.00
	Includes:						
	Labor						
	10ft Copper Tube						
	10ft Royal Cord						
	Outdoor Bracket						
	Other Consumables						
	<b>Additional Charges</b>	<b>Description</b>	<b>Unit</b>	<b>Price Per Unit</b>		<b>Subtotal</b>	
	Copper Tube	1/4"x 1/2"	10 ft	P 350.00 / ft	P	3,500.00	
	Royal Cord	2.mm2 x 4C	15 ft	P 100.00 / ft	P	1,500.00	
	Royal Cord (ODU-Breaker)	3.5mm2 x 3C	5 ft	P 60.00 / ft	P	300.00	
	Circuit Breaker(NEMA)	30A/ 1Ph	1 pc(s)	P 1,000.00 / pc	P	1,000.00	P 6,300.00
	<b>Estimated Charges</b>					P	13,800.00



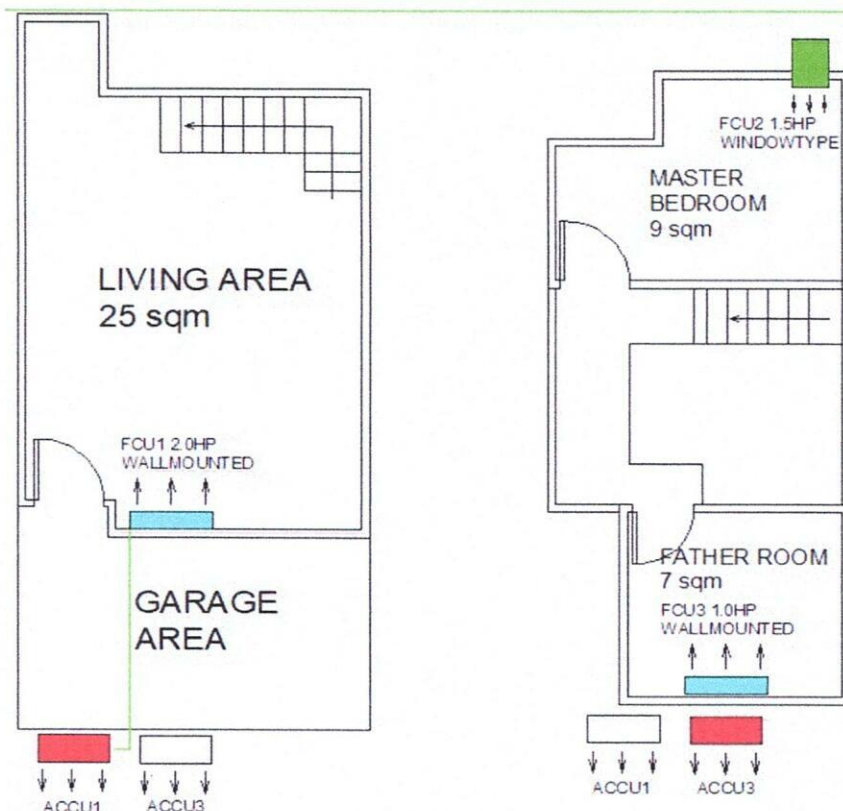

**Total Estimated Charges**

**P 28,050.00**

**Validity:** This quotation is valid for a period of fifteen (15) days from the date thereof, subject to our confirmation thereafter.

**Note:**

- 1 Location of indoor and outdoor units were agreed by the customer and Kolin's surveyor.
- 2 AC drain line will be tapped to the nearest drain provision provided by the customer's contractor.
- 3 **KAG-145WCINV Dimension: W x D x H, = 560 X 708 x 375 mm. (22 x 28 x 15 inches)**
- 4 **ACU3** location is not yet final in the area, recommendation only.
- 5 ACU1 is for LIVING,DINING computation only . Kitchen will be close as per customer.
- 6 Side of hole for window would be closed by customer,Hole is larger than the unit recommendation.  
Hole dimension:Width x Height ( 660mm x430mm)
- 7 Working days: Monday to Saturday, 8am- 5pm with parking.
- 8 Mechanical Plans, Permits, Electrical permits not included.
- 9 Deflectors, masonry, carpentry, chipping & plastering (finishing & restoration) are not included in the installation.
- 10 Electrical power supply (feeder line) **220v/ 60hz/ 1ph** , is not included in the scope of work of Kolin.
- 11 **Final charges will be based on actual installation.**

Prepared by:

**Jeffrey Dadios**

Field Surveyor

Customer Conformer:

Signature Over Printed Name

Reviewed by:

**Engr. Kenneth Zamora**

Service Supervisor

Field and Shop Operation