



June 18, 2025

MR. BRYAN DY  
UNIT 8, FIREFLY ST. WESTWOOD LANE VALLE VERDE, BRGY. UGONG, PASIG CITY  
TEL#: 0917-8927939

Dear Ma'am/Sir,

Kolin Marketing Inc., is extremely honored for your endorsement of Kolin brand and we are please to offer you with a special price/s for the following items.

A. EQUIPMENT & INSTALLATION

QTY	U/M	MODEL / DESCRIPTION	SRP	DISCOUNTED PRICE		AMOUNT
1	UNIT/S	MODEL: KSG-IWF-20WFF-8K1M32 KOLIN WALL MOUNTED PRIMUS GOLD AIRCONDITIONER 19,000 Kj/h (2.0HP) FULL DC INVERTER W/ WIFI R-32	59,595.00	38,292.20	PHP	38,292.20
1	UNIT/S	MODEL: KSG-IWF-15WFF-8K1M32 KOLIN WALL MOUNTED PRIMUS GOLD AIRCONDITIONER 12,960 Kj/h (1.5HP) FULL DC INVERTER W/ WIFI R-32	46,595.00	28,412.20	PHP	28,412.20
TOTAL UNIT COST					PHP	66,704.40
ESTIMATED COST OF INSTALLATION (please see attached)					PHP	31,350.00
OTHERS: DELIVERY CHARGE					PHP	600.00
TOTAL ESTIMATED COST OF THE PROJECT					PHP	98,654.40

TERMS OF PAYMENT:

FULL PAYMENT OF UNIT AND DELIVERY CHARGE. IF CHECK, SUBJECT FOR 3 DAYS CLEARING.

WARRANTY:

FOR SPLIT TYPE : ONE (1) YEAR FREE PARTS AND LABOR, THREE YEARS (3) MAIN PCB , TEN (10) YEARS WARRANTY ON COMPRESSOR.

NOTES: PRICES ARE SUBJECT TO CHANGE WITHOUT PRIOR NOTICE.

PRICES IS VAT INCLUSIVE.

**\*\* Cost of Installation is Package with the Unit(s), this cost cannot avail separately (cost will be based on actual).**

**\*\*\* You may settle first payment for unit/s & delivery. Installation payment can be settled directly to installer after actual works.**

We thank you for giving opportunity to offer our product and services, hoping we receive your purchase order.

If you need assistance, don't hesitate to call the under signed at 0917-807-8607 or email at [kmi\\_asst@kolinphil.com.ph](mailto:kmi_asst@kolinphil.com.ph)

Very Truly Yours,

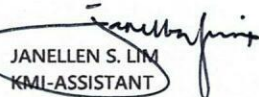
  
JANELLEN S. LIM  
KMI-ASSISTANT

Noted by:

  
MART NATHANIEL R. FLORES  
KMI-SUPERVISOR

Approved By:

  
MS. EDITHA M. FLORES  
AVP - FINANCE

KMI-QUOTE-06-25-0475  
ADR-24%/7K

Conforme:

SIGNATURE OVER PRINTED NAME

Kolin Marketing, Inc.

1854 Sta. Rita St., Guadalupe Nuevo, Makati City

Tel.: (632) 8852-6473

Fax: (632) 8852-2170 / (632) 8852-4792

 [www.kolinphil.com.ph](http://www.kolinphil.com.ph) / [kolinphilippines](http://kolinphilippines)



June 14, 2025

BRYAN DY

Unit 8, 15 Firefly St. Westwood Lane, Valle Verde Brgy Ugong Pasig City

0917-8927939

MODEL	Qty
KSG-IWF-20Wfy8K1M32	1
KSG-IWF-15Wfy8K1M32	1

<b>BEDROOM 2</b>	Area	18 sqm
------------------	------	--------

ACU 1	2.0 HP Wall Mounted Inverter	KSG-IWF-20Wfy8K1M32			
	Estimated Pipe Length = 20 ft				
	Estimated Royal Cord Length = 25 ft				
	<b>Initial Charge</b>				P 7,500.00
	Includes:				
	Labor				
	10ft Copper Tube				
	10ft Royal Cord				
	Outdoor Bracket (Wall)				
	Consumables				
	<b>Installation Materials</b>	<b>Description</b>	<b>Qty</b>	<b>Price per qty</b>	<b>Subtotal</b>
	Copper Tube	Ø 1/4" x Ø 1/2"	10 ft	P 350.00/ft	P 3,500.00
	Royal Cord (comm. wire)	2.mm2 x 4C	15 ft	P 100.00/ft	P 1,500.00
	Royal Cord (ACCU-Breaker)	3.5mm x 3c	5 ft	P 60.00/ft	P 300.00
	Circuit Breaker waterproof	30A / 1Ph	1 pc/s	P 1,000.00/pc	P 1,000.00
	PVC blue	3/4" x 10'	2 pc/s	P 150.00/pc	P 300.00
					<b>P 6,600.00</b>
	<b>Estimated Charges</b>				<b>P 14,100.00</b>

<b>OFFICE</b>	Area	14.8 sqm
---------------	------	----------

ACU 2	1.5 HP Wall Mounted Inverter	KSG-IWF-15Wfy8K1M32			
	Estimated Pipe Length = 27 ft				
	Estimated Royal Cord Length = 32 ft				
	<b>Initial Charge</b>				P 7,500.00
	Includes:				
	Labor				
	10ft Copper Tube				
	10ft Royal Cord				
	Outdoor Bracket (Wall)				
	Consumables				
	<b>Installation Materials</b>	<b>Description</b>	<b>Qty</b>	<b>Price per qty</b>	<b>Subtotal</b>
	Copper Tube	Ø 1/4" x Ø 3/8"	17 ft	P 350.00/ft	P 5,950.00
	Royal Cord (comm. wire)	2.mm2 x 4C	22 ft	P 100.00/ft	P 2,200.00
	Royal Cord (ACCU-Breaker)	3.5mm x 3c	5 ft	P 60.00/ft	P 300.00
	Circuit Breaker waterproof	30A / 1Ph	1 pc/s	P 1,000.00/pc	P 1,000.00
	PVC blue	3/4" x 10'	2 pc/s	P 150.00/pc	P 300.00
					<b>P 9,750.00</b>
	<b>Estimated Charges</b>				<b>P 17,250.00</b>



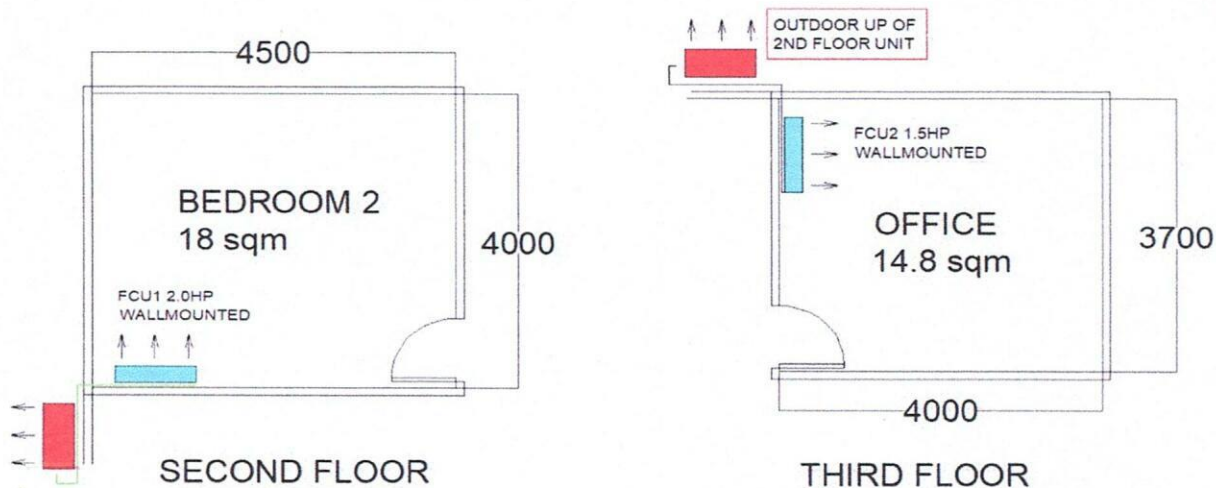

Total Estimated Charges	P 31,350.00
-------------------------	-------------

**Validity:** This quotation is valid for a period of fifteen (15) days from the date thereof, subject to our confirmation thereafter.

**Installation notes:**

- 1 Location of indoor and outdoor units were agreed by the customer and Kolin's surveyor.
- 2 AC drain line will be tapped to the nearest drain provision provided by the customer's contractor.
- 3 Need for site visit and markings of drainline and lay out of coppertube.
- 4 Working days: Monday to Saturday, 8am- 5pm with parking. Need working permit.
- 5 Mechanical Plans, Permits, Electrical permits not included.
- 6 Deflectors, masonry, carpentry, chipping & plastering (finishing & restoration) are not included in the installation.
- 7 Air conditioning drain line and Electrical power supply (feeder line) **220v/ 60hz/ 1ph** , should be provided by customer's contractor.
- 8 **Final charges will be based on actual installation.**

Prepared by:

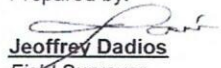
  
**Jeffrey Dadios**  
 Field Surveyor

Customer Conformance:

\_\_\_\_\_  
 Signature Over Printed Name

Reviewed by:

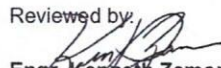
  
**Engr. Kenneth Zamora**  
 Service Supervisor Shop and  
 Field Operation