



June 30, 2025

UPCARE DIAGNOSTICS INC.
522 EDSA, BRGY. BIGLANG AWA COR. URBANO PLATA ST., CALOOCAN CITY
TEL#: 0995-3035702
Email: niel.upcarecoor@gmail.com

Dear Ma'am/Sir,

Kolin Marketing Inc., is extremely honored for your endorsement of Kolin brand and we are please to offer you with a special price/s for the following items.

A. EQUIPMENT & INSTALLATION

* OPTION 1 *

QTY	U/M	MODEL / DESCRIPTION	SRP	DISCOUNTED PRICE		AMOUNT
1	UNIT/S	MODEL: KLM-IS60-AA1M32 KOLIN CEILING CASSETTE AIRCONDITIONER 55,503 Kj/h (5.0TR) DC INVERTER R-32 SINGLE PHASE	154,995.00	117,796.20	PHP	117,796.20
TOTAL UNIT COST					PHP	117,796.20
ESTIMATED COST OF INSTALLATION (please see attached)					PHP	46,300.00
OTHERS: DELIVERY CHARGE					PHP	600.00
TOTAL ESTIMATED COST OF THE PROJECT					PHP	164,696.20

TERMS OF PAYMENT:

FULL PAYMENT OF UNIT AND DELIVERY CHARGE. IF CHECK, SUBJECT FOR 3 DAYS CLEARING.

WARRANTY:

FOR CEILING CASSETTE (Inverter): ONE (1) YEAR FREE PARTS AND LABOR, FIVE (5) YEARS WARRANTY ON COMPRESSOR.

NOTES: PRICES ARE SUBJECT TO CHANGE WITHOUT PRIOR NOTICE.

PRICES IS VAT INCLUSIVE.

** Cost of Installation is Package with the Unit(s), this cost cannot avail separately (cost will be based on actual works).

*** You may settle first payment for unit/s & delivery. Installation payment can be settled directly to installer after actual works.

We thank you for giving opportunity to offer our product and services, hoping we receive your purchase order.

If you need assistance, don't hesitate to call the under signed at 0917-807-8607 or email at kmi_asst@kolinphil.com.ph

Very Truly Yours,

JANELLEN S. LIM
KMI-ASSISTANT

Noted by:

MART NATHANIEL R. FLORES
KMI-SUPERVISOR

Approved By:

MS. EDITHA M. FLORES
AVP - FINANCE

KMI-QUOTE-06-25-0508
REG-24%

Conforme:

SIGNATURE OVER PRINTED NAME

Kolin Marketing, Inc.

1854 Sta. Rita St., Guadalupe Nuevo, Makati City

Tel.: (632) 8852-6473

Fax: (632) 8852-2170 / (632) 8852-4792

www.kolinphil.com.ph / kolinphilippines

June 28, 2025
 UPCARE DIAGNOSTICS
 522 EDSA Brgy Biglang Awa, Cor Urbano Plata St. Caloocan City
 0995-3035702
niel.upcarecoor@gmail.com

MODEL Qty
 KLM-IS60-AA1M32 1

OPTION 1

LABORATORY Area 37.8 sqm

ACU 6.0 HP Ceiling Cassette Inverter KLM-IS60-AA1M32
 Estimated Pipe Length = 53 ft
 Estimated Royal Cord Length = 60 ft
 Initial Charge P 15,000.00

Includes:
 Labor
 10ft Copper Tube
 10ft Royal Cord
 Consumables

Installation Materials	Description	Qty	Price per qty	Subtotal
Copper Tube	Ø 3/8 " x Ø 5/8"	43 ft	P 400.00/ft	P 17,200.00
Royal Cord (comm. wire)	2.mm2 x 4C	50 ft	P 100.00/ft	P 5,000.00
Royal Cord (ACCU-Breaker)	5.5mm x 3c	5 ft	P 70.00/ft	P 350.00
Circuit Breaker waterproof	40A / 1Ph	1 pc/s	P 1,000.00/pc	P 1,000.00
Rubber Insulation	2 1/8" x 3/4" x 6'	7 pc/s	P 350.00/pc	P 2,450.00
Dismantle	4.0HP Ceiling Susp	1 set	P 3,500.00/set	P 3,500.00
Outdoor bracket	Modified	1 pc/s	P 1,500.00/pc	P 1,500.00
PVC blue	3/4" x 10'	2 pc/s	P 150.00/pc	P 300.00
				P 31,300.00

Estimated Charges P 46,300.00

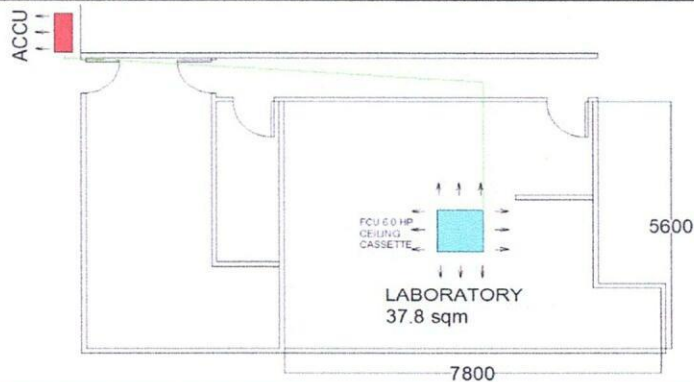

Total Estimated Charges P 46,300.00

Validity: This quotation is valid for a period of fifteen (15) days from the date thereof, subject to our confirmation thereafter.

Installation notes:

- 1 Location of indoor and outdoor units were agreed by the customer and Kolin's surveyor.
- 2 AC drain line will be tapped to the nearest drain provision provided by the customer's contractor.
- 3 Coppertube going inside the ceiling.
- 4 Working days: Monday to Saturday, 8am- 5pm without parking.
- 5 Mechanical Plans, Permits, Electrical permits not included.
- 6 Deflectors, masonry, carpentry, chipping & plastering (finishing & restoration) are not included in the installation.
- 7 Air conditioning drain line and Electrical power supply (feeder line) **220v/ 60hz/ 1ph**, should be provided by customer's contractor.
- 8 **Final charges will be based on actual installation.**

Prepared by:

Jeffrey Dadios
 Field Surveyor

Customer Conformer:

Signature Over Printed Name

Reviewed by:

Engr. Kenneth Zamora
 Service Supervisor Shop and
 Field Operation