



June 5, 2025

LOPA COMPOUND DEVELOPMENT / HOUSE #3 TINAY
LOPA FARM MARILAQUE HIWAY, SITIO MAYAGAY, BRGY. SAMPALOC TANAY RIZAL
Email: mereyes@foro.ph

Dear Ma'am/Sir,

Kolin Marketing Inc., is extremely honored for your endorsement of Kolin brand and we are please to offer you with a special price/s for the following items.

A. EQUIPMENT & INSTALLATION

QTY	U/M	MODEL / DESCRIPTION	SRP	DISCOUNTED PRICE		AMOUNT
2	UNIT/S	MODEL: KSG-IWF-25WFF-8K1M32 KOLIN WALL MOUNTED PRIMUS GOLD AIRCONDITIONER 25,560 KJ/h (2.5HP) FULL DC INVERTER W/ WIFI R-32	68,995.00	45,436.20	PHP	90,872.40
1	UNIT/S	MODEL: KA-200MCARINV32 KOLIN WINDOW TYPE CREO SERIES AIRCONDITIONER 19,800 KJ/h (2.0HP) FULL DC INVERTER R-32 WITH REMOTE (WxDxH) 26"x30.7"x16.8"	36,995.00	26,916.20	PHP	26,916.20
1	UNIT/S	MODEL: KA-150MCARINV32 KOLIN WINDOW TYPE CREO SERIES AIRCONDITIONER 12,800 KJ/h (1.5HP) FULL DC INVERTER R-32 WITH REMOTE (WxDxH) 17.7"x26.6"x13.8"	27,995.00	20,276.20	PHP	20,276.20
TOTAL UNIT COST					PHP	138,064.80
ESTIMATED COST OF INSTALLATION (please see attached)					PHP	59,050.00
OTHERS: DELIVERY CHARGE					PHP	600.00
TOTAL ESTIMATED COST OF THE PROJECT					PHP	197,714.80

TERMS OF PAYMENT:

FULL PAYMENT OF UNIT AND DELIVERY CHARGE. IF CHECK, SUBJECT FOR 3 DAYS CLEARING.

WARRANTY:

FOR SPLIT TYPE : ONE (1) YEAR FREE PARTS AND LABOR, THREE YEARS (3) MAIN PCB , TEN (10) YEARS WARRANTY ON COMPRESSOR.
FOR WINDOW TYPE: ONE (1) YEAR FREE PARTS AND LABOR, THREE YEARS (3) MAIN PCB, TEN (10) YEARS WARRANTY ON COMPRESSOR.

NOTES: PRICES ARE SUBJECT TO CHANGE WITHOUT PRIOR NOTICE.

PRICES IS VAT INCLUSIVE.

**** Cost of Installation is Package with the Unit(s), this cost cannot avail separately (cost will be based on actual).**

We thank you for giving opportunity to offer our product and services, hoping we receive your purchase order.

If you need assistance, don't hesitate to call the under signed at 0917-807-8607 or email at kmi_asst@kolinphil.com.ph

**** SUBJECT FOR ACTUAL SITE VISIT / OCULAR ****

Very Truly Yours,

JANELLE S. LIM
KMI-ASSISTANT

Noted by:

MART NATHANIEL R. FLORES
KMI-SUPERVISOR

Approved By:

MS. EDITHA M. FLORES
AVP - FINANCE

KMI-QUOTE-04-25-0266-rev3
DCG-24%/7K/1.2K/1K

Conforme:

SIGNATURE OVER PRINTED NAME

Kolin Marketing, Inc.

1854 Sta. Rita St., Guadalupe Nuevo, Makati City

Tel.: (632) 8852-6473

Fax: (632) 8852-2170 / (632) 8852-4792

www.kolinphil.com.ph / kolinphilippines

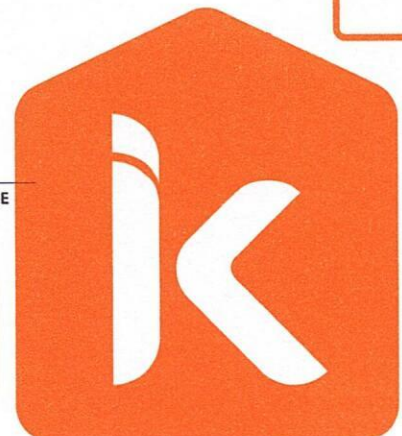

June 4, 2025

LOPA COMPOUND DEVELOPMENT/ HOUSE #3 TINAY

Lopa Farm Marilaque Hiway Sitio Mayagay, Brgy Sampaloc Tanay Rizal

MODEL	QUANTITY
KSG-IWF-25WFFY8K1M32	2
KA-200MCARINV32	1
KA-150MCARINV32	1

REV3

GROUND FLOOR

FOYER/LIVING AREA	Area ≈ 47 sq.m
--------------------------	----------------

ACU 1	2.5hp Wall mounted Inverter	KSG-IWF-25WFFY8K1M32	
	Estimated Pipe Length :	30	ft
	Estimated Royal Cord Length :	35	ft
	Initial Charge		P 8,500.00

Includes:

Labor

10ft Copper Tube

10ft Royal Cord

Outdoor Bracket

Other Consumables

Additional Charges	Description	Unit	Price Per Unit	Subtotal
Copper Tube	1/4"x 5/8"	20 ft	P 400.00 / ft	P 8,000.00
Royal Cord	2.mm2 x 4C	25 ft	P 100.00 / ft	P 2,500.00
Royal Cord (ODU-Breaker)	3.5mm2 x 3C	5 ft	P 60.00 / ft	P 300.00
Circuit Breaker(NEMA)	30A/ 1Ph	1 pc(s)	P 1,000.00 / pc	P 1,000.00
PVC(Drainline)	Blue 3/4"	2 pc(s)	P 150.00 / pc	P 300.00
Rubber Insulation	2 1/8"x3/4" x 6'	4 pc(s)	P 350.00 / pc	P 1,400.00
Full Thread	3 meters	1 pc(s)	P 150.00 / pc	P 150.00
Pipe hanger	3 inches	6 pc(s)	P 120.00 / pc	P 720.00
				P 14,370.00

Estimated Charges	P 22,870.00
--------------------------	--------------------

ACU 2	2.5hp Wall mounted Inverter	KSG-IWF-25WFFY8K1M32	
	Estimated Pipe Length :	40	ft
	Estimated Royal Cord Length :	45	ft
	Initial Charge		P 8,500.00

Includes:

Labor

10ft Copper Tube

10ft Royal Cord

Outdoor Bracket

Other Consumables

Additional Charges	Description	Unit	Price Per Unit	Subtotal
Copper Tube	1/4"x 5/8"	30 ft	P 400.00 / ft	P 12,000.00
Royal Cord	2.mm2 x 4C	35 ft	P 100.00 / ft	P 3,500.00
Royal Cord (ODU-Breaker)	3.5mm2 x 3C	7 ft	P 60.00 / ft	P 420.00
Circuit Breaker(NEMA)	30A/ 1Ph	5 pc(s)	P 1,000.00 / pc	P 5,000.00
PVC(Drainline)	Blue 3/4"	2 pc(s)	P 150.00 / pc	P 300.00
Rubber Insulation	2 1/8"x3/4" x 6'	5 pc(s)	P 350.00 / pc	P 1,750.00
Full Thread	3 meters	1 pc(s)	P 150.00 / pc	P 150.00
Pipe hanger	3 inches	8 pc(s)	P 120.00 / pc	P 960.00
				P 24,080.00

Estimated Charges	P 32,580.00
--------------------------	--------------------

BEDROOM1	Area ≈ 14 sq.m
-----------------	----------------

ACU3 1.5hp Windowtype Inverter KA-150MCARINV32

Initial charge P 1,200.00
Angle Bracket P 600.00

Estimated charges P 1,800.00

MASTER BEDROOM	Area ≈ 22.2 sq.m
-----------------------	------------------

ACU4 2.0hp Windowtype Inverter KA-200MCARINV32

Initial charge P 1,200.00
Angle Bracket P 600.00

Estimated charges P 1,800.00

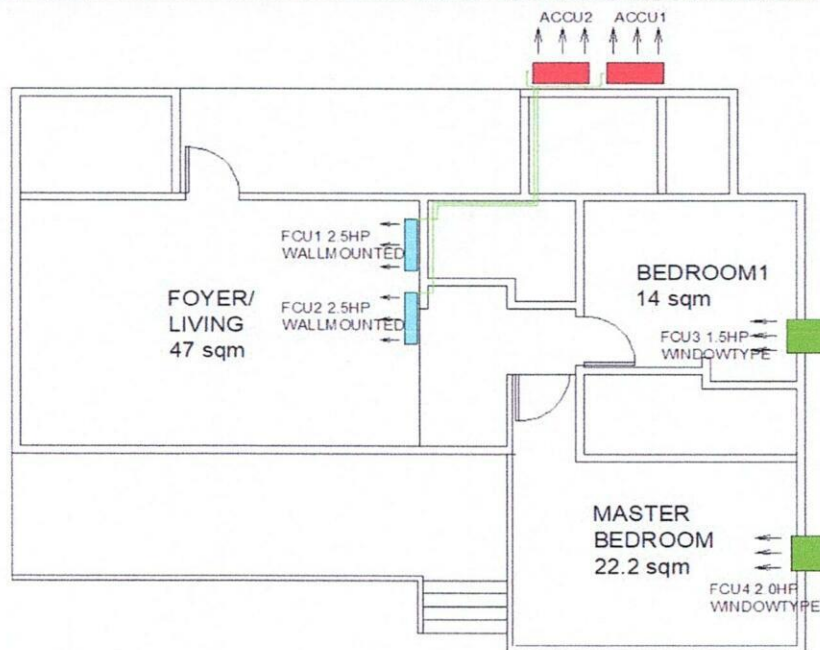

Total Estimated Charges	P 59,050.00
--------------------------------	-------------

Validity: This quotation is valid for a period of fifteen (15) days from the date thereof, subject to our confirmation thereafter.

Note:

- 1 Location of indoor and outdoor units base in floor plan.
- 2 AC drain line will be tapped to the nearest drain provision provided by the customer's contractor.
- 3 Need for site visit before installation and for final location of units.
- 4 Customer need to cover the side of windowtype if unit is smaller than existing hole.
- 5 KA-150CARINV32 Dimension: W x D x H, = 450.6 X 675 x 350 mm. (17.7x 26.6 x 13.8 inches)
- 6 KA-200CARINV32 Dimension: W x D x H, = 660 X 780 x 428 mm. (26 x 30.7 x 116.8 inches)
- 7 Working days: Monday to Saturday, 8am- 5pm with parking. Need working permit.
- 8 Mechanical Plans, Permits, Electrical permits not included.
- 9 Deflectors, masonry, carpentry, chipping & plastering (finishing & restoration) are not included in the installation.
- 10 Electrical power supply (feeder line) **220v/ 60hz/ 1ph** , is not included in the scope of work of Kolin.
- 11 Final charges will be based on actual installation.

Prepared by:

Jeffrey Dadios

Field Surveyor

Customer Conformer:

Signature Over Printed Name

Reviewed by:

Engr. Kenneth Zamora

Service Supervisor
Field and Shop Operation