



March 27, 2025

MR. BENJAMIN BAUTISTA
UNIT D6, LANUZA AVE, CASA VERDE TOWNHOMES, BRGY. UGONG PASIG CITY
Email: pmgbautista@outlook.com

Dear Ma'am/Sir,

Kolin Marketing Inc., is extremely honored for your endorsement of Kolin brand and we are please to offer you with a special price/s for the following items.

A. EQUIPMENT & INSTALLATION

**** OPTION 1**

QTY	U/M	MODEL / DESCRIPTION	SRP	DISCOUNTED PRICE		AMOUNT
1	UNIT/S	MODEL: KLG-IF40-5G1M32 KOLIN FLOOR MOUNTED AIRCONDITIONER 37,980 Kj/h (3.0TR) FULL DC INVERTER R-32 SINGLE PHASE	113,195.00	79,028.20	PHP	79,028.20
1	UNIT/S	MODEL: KAG-200WCINV KOLIN WINDOW TYPE QUAD SERIES AIRCONDITIONER 19,080 Kj/h (2.0HP) FULL DC INVERTER W/ WIFI R-32 (WxDxH) 26"x28"x17"	43,595.00	31,332.20	PHP	31,332.20
2	UNIT/S	MODEL: KAG-145WCINV KOLIN WINDOW TYPE QUAD SERIES AIRCONDITIONER 13,210 Kj/h (1.5HP) FULL DC INVERTER W/ WIFI R-32 (WxDxH) 22"x28"x15"	32,995.00	23,776.20	PHP	47,552.40
TOTAL UNIT COST					PHP	157,912.80
ESTIMATED COST OF INSTALLATION (please see attached)					PHP	39,765.00
OTHERS: DELIVERY CHARGE					PHP	600.00
TOTAL ESTIMATED COST OF THE PROJECT					PHP	198,277.80

TERMS OF PAYMENT:

FULL PAYMENT OF UNIT AND DELIVERY CHARGE. IF CHECK, SUBJECT FOR 3 DAYS CLEARING.

WARRANTY:

FOR FLOOR MOUNTED: ONE (1) YEAR FREE PARTS AND LABOR, FIVE (5) YEARS WARRANTY ON COMPRESSOR.

FOR WINDOW TYPE: ONE (1) YEAR FREE PARTS AND LABOR, THREE YEARS (3) MAIN PCB, TEN (10) YEARS WARRANTY ON COMPRESSOR.

NOTES: PRICES ARE SUBJECT TO CHANGE WITHOUT PRIOR NOTICE.

PRICES IS VAT INCLUSIVE.

**** Cost of Installation is Package with the Unit(s), this cost cannot avail separately (cost will be based on actual).**

We thank you for giving opportunity to offer our product and services, hoping we receive your purchase order.

If you need assistance, don't hesitate to call the under signed at 0917-807-8607 or email at kmi_asst@kolinphil.com.ph

Very Truly Yours,

JANELLEN S. LIM
KMI-ASSISTANT

Noted by:

MART NATHANIEL R. FLORES
KMI-SUPERVISOR

Approved By:

MS. EDITHA M. FLORES
AVP - FINANCE

KMI-QUOTE-03-25-0233
ECY-24%/7K/1.8K/1.3K

Conforme:

SIGNATURE OVER PRINTED NAME

Kolin Marketing, Inc.

1854 Sta. Rita St., Guadalupe Nuevo, Makati City

Tel.: (632) 8852-6473

Fax: (632) 8852-2170 / (632) 8852-4792

www.kolinphil.com.ph / kolinphilippines

March 26, 2025

BENJAMIN BAUTISTA

Unit D6, Lanuza Ave, Casa Verde Townhomes, Brgy Ugong Pasig City

0917-8269939

pmgbautista@outlook.com

MODEL	QUANTITY
KLG-IF40-5G1M32	1
KAG-200WCINV	1
KAG-145WCINV	2

OPTION 1 -floor and windowtype inverter

GROUND FLOOR

LIVING	Area ≈ 42 sq.m
---------------	----------------

ACU 1	4.0hp Floor mounted Inverter	KLG-IF40-5G1M32	
	Estimated Pipe Length :	33	ft
	Estimated Royal Cord Length :	40	ft
	Initial Charge		P 11,000.00

Includes:

Labor

10ft Copper Tube

10ft Royal Cord

Indoor Bracket

Other Consumables

Additional Charges	Description	Unit	Price Per Unit	Subtotal
Copper Tube	3/8"x 5/8"	23 ft	P 400.00 / ft	P 9,200.00
Royal Cord	2.mm2 x 4C	30 ft	P 100.00 / ft	P 3,000.00
Royal Cord (ODU-Breaker)	5.5mm2 x 3C	7 ft	P 70.00 / ft	P 490.00
Circuit Breaker(NEMA)	40A/ 1Ph	1 pc(s)	P 1,000.00 / pc	P 1,000.00
Outdoor Bracket(wall)	Fabricated	1 pc(s)	P 5,000.00 / pc	P 5,000.00
Dismantle	4.0hp	1 pc(s)	P 3,000.00 / pc	P 3,000.00
Scaffoldings	3sets	1 pc(s)	P 1,500.00 / pc	P 1,500.00
Drain Hose	White -1/2"	7 ft	P 25.00 / ft	P 175.00
				P 23,365.00

Estimated Charges	P 34,365.00
--------------------------	--------------------

SECOND FLOOR

BEDROOM 3	Area ≈ 16 sq.m
------------------	----------------

ACU2	1.5hp Windowtype Inverter	KAG-145WCINV	
	Initial charge		P 1,200.00
	Angle Bracket		P 600.00

Estimated charges	P 1,800.00
--------------------------	-------------------

BEDROOM 2	Area ≈ 16 sq.m
------------------	----------------

ACU3	1.5hp Windowtype Inverter	KAG-145WCINV	
	Initial charge		P 1,200.00
	Angle Bracket		P 600.00

Estimated charges	P 1,800.00
--------------------------	-------------------

MASTER BEDROOM	Area ≈ 20 sq.m
-----------------------	----------------

ACU4	2.0hp Windowtype Inverter	KAG-200WCINV	
	Initial charge		P 1,200.00
	Angle Bracket		P 600.00

Estimated charges	P 1,800.00
--------------------------	-------------------



GROUND FLOOR

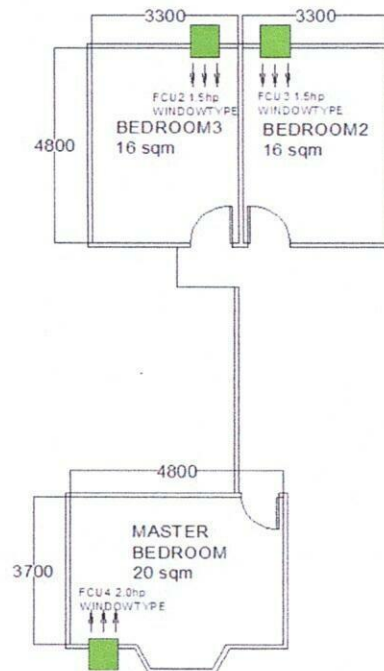

SECOND FLOOR

Total Estimated Charges

P 39,765.00

Validity: This quotation is valid for a period of fifteen (15) days from the date thereof, subject to our confirmation thereafter.

Note:

- 1 Location of indoor and outdoor units were agreed by the customer and Kolin's surveyor.
- 2 AC drain line will be tapped to the nearest drain provision provided by the customer's contractor.
- 3 Customer need to cover the side of windowtype if unit is smaller than existing hole.
- 4 Need a ducting if ACU4. Having error due to lack of ventilation provided by customer
- 5 KAG-145WCINV Dimension: W x D x H, = 560 X 708 x 375 mm. (22 x 28 x 15 inches)
- 6 KAG-200WCINV Dimension: W x D x H, = 660 X 800 x 428 mm. (26 x 31.5 x 17 inches)
- 7 Working days: Monday to Saturday, 8am- 5pm with parking. Need working permit.
- 8 Mechanical Plans, Permits, Electrical permits not included.
- 9 Deflectors, masonry, carpentry, chipping & plastering (finishing & restoration) are not included in the installation.
- 10 Electrical power supply (feeder line) **220v/ 60hz/ 1ph**, is not included in the scope of work of Kolin.
- Transfer power Supply to new location.
- 11 Final charges will be based on actual installation.

Prepared by:

Jeffrey Dadios
Field Surveyor

Customer Conformance:

Signature Over Printed Name

Reviewed by:

Engr. Kenneth Zamora
Service Supervisor
Field and Shop Operation