



March 5, 2025

PATTS COLLEGE OF AERONAUTICS
LOMBOS ST., BRGY. SAN ISIDRO, PARAÑAQUE CITY
TEL#: 825-8823 / 825-8824

Dear Ma'am/Sir,

Kolin Marketing Inc., is extremely honored for your endorsement of Kolin brand and we are please to offer you with a special price/s for the following items.

A. EQUIPMENT & INSTALLATION

* PRINTING PRESS ROOM

QTY	U/M	MODEL / DESCRIPTION	SRP	DISCOUNTED PRICE		AMOUNT
1	UNIT/S	MODEL: KLG-IF40-5G1M32 KOLIN FLOOR MOUNTED AIRCONDITIONER 37,980 Kj/h (3.0TR) FULL DC INVERTER R-32 SINGLE PHASE	113,195.00	79,028.20	PHP	79,028.20
TOTAL UNIT COST					PHP	79,028.20
ESTIMATED COST OF INSTALLATION (please see attached)					PHP	26,700.00
OTHERS: DELIVERY CHARGE					PHP	600.00
TOTAL ESTIMATED COST OF THE PROJECT					PHP	106,328.20

TERMS OF PAYMENT:

FULL PAYMENT OF UNIT AND DELIVERY CHARGE. IF CHECK, SUBJECT FOR 3 DAYS CLEARING.

WARRANTY:

FOR FLOOR MOUNTED: ONE (1) YEAR FREE PARTS AND LABOR, FIVE (5) YEARS WARRANTY ON COMPRESSOR.

NOTES: PRICES ARE SUBJECT TO CHANGE WITHOUT PRIOR NOTICE.

PRICES IS VAT INCLUSIVE.

**** Cost of Installation is Package with the Unit(s), this cost cannot avail separately (cost will be based on actual).**

We thank you for giving opportunity to offer our product and services, hoping we receive your purchase order.

If you need assistance, don't hesitate to call the under signed at 0917-807-8607 or email at kmi_asst@kolinphil.com.ph

Very Truly Yours,

JANELLEN S. LIM
KMI-ASSISTANT

Noted by:

MART NATHANIEL R. FLORES
KMI-SUPERVISOR

Approved By:

MS. EDITHA M. FLORES
AVP - FINANCE

KMI-QUOTE-03-25-0167
REG-24%/7K

Conforme:

SIGNATURE OVER PRINTED NAME

Kolin Marketing, Inc.
1854 Sta. Rita St., Guadalupe Nuevo, Makati City
Tel.: (632) 8852-6473
Fax: (632) 8852-2170 / (632) 8852-4792
www.kolinphil.com.ph / kolinphilippines



MARCH 04, 2025
PATT'S COLLEGE OF AERONAUTICS
Lombos St. Brgy. San Isidro, Paranaque City
825-8823, 825-8824

MODEL Qty
KLG-IF40-5G1M32 1

PRINTING PRESS Area 37.2 sqm

ACU 4.0 HP Floor Standing Inverter KLG-IF40-5G1M32
Estimated Pipe Length = 27 ft
Estimated Royal Cord Length = 34 ft
Initial Charge P 11,000.00

Includes:

Labor
10ft Copper Tube
10ft Royal Cord
Indoor bracket (floor)
Consumables

Installation Materials	Description	Qty	Price per qty	Subtotal
Copper Tube	Ø 3/8" x Ø 5/8"	17 ft	P 400.00/ft	P 6,800.00
Royal Cord (comm. wire)	2.mm2 x 4C	24 ft	P 100.00/ft	P 2,400.00
Royal Cord (ACCU-Breaker)	5.5mm x 3c	5 ft	P 70.00/ft	P 350.00
Circuit Breaker waterproof	40A / 1Ph	1 pc/s	P 1,000.00/pc	P 1,000.00
Outdoor Bracket(wall)	fabricated	1 pc/s	P 5,000.00/pc	P 5,000.00
PVC blue	3/4" x 10'	1 pc/s	P 150.00/pc	P 150.00
				P 15,700.00

Estimated Charges P 26,700.00

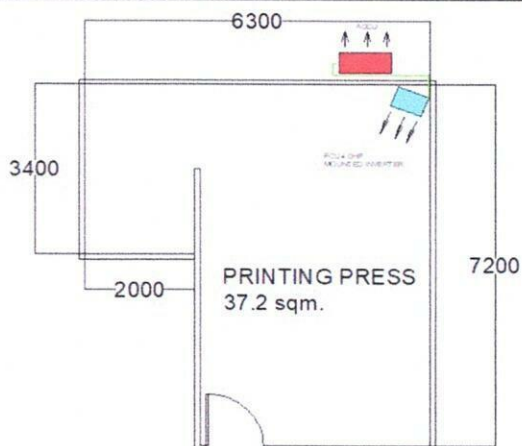

Total Estimated Charges P 26,700.00

Validity: This quotation is valid for a period of fifteen (15) days from the date thereof, subject to our confirmation thereafter.

Installation notes:

- 1 Location of indoor and outdoor units were agreed by the customer and Kolin's surveyor.
- 2 Expose Coppertube, wires and drainline in the area.
- 3 Mechanical Plans, Permits, Electrical permits not included.
- 4 Deflectors, masonry, carpentry, chipping & plastering (finishing & restoration) are not included in the installation.
- 5 Air conditioning drain line and Electrical power supply (feeder line) **220v/ 60hz/ 1ph** , should be provided by customer's contractor.
- 6 Final charges will be based on actual installation.

Prepared by:

Jeffrey Dadios
Field Surveyor

Reviewed by:

Engr. Kenneth Zamora
Service Supervisor Shop and
Field Operation

Customer Conformance:

Signature Over Printed Name