



May 23, 2025

IPRINT LABELS & PACKAGING CORP.
138 KAYTIKLING CABRERA RD., BRGY. DOLORES, TAYTAY RIZAL
ATTN: MS. CHERRY CABALLERO
Email: purchasing@iprintcorp.com

Dear Ma'am/Sir,

Kolin Marketing Inc., is extremely honored for your endorsement of Kolin brand and we are please to offer you with a special price/s for the following items.

A. EQUIPMENT & INSTALLATION

**** OPTION 2 (RIGHT OF EXISTING UNIT)**

QTY	U/M	MODEL / DESCRIPTION	SRP	DISCOUNTED PRICE		AMOUNT
1	UNIT/S	MODEL: KLM-IC40-AA1M32 KOLIN FLOOR/CEILING AIRCONDITIONER 37,980 Kj/h (3.0TR) DC INVERTER R-32	117,995.00	89,676.20 ^	PHP	89,676.20
TOTAL UNIT COST					PHP	89,676.20
ESTIMATED COST OF INSTALLATION (please see attached)					PHP	25,265.00
OTHERS: DELIVERY CHARGE					PHP	600.00
TOTAL ESTIMATED COST OF THE PROJECT					PHP	115,541.20

TERMS OF PAYMENT:

FULL PAYMENT OF UNIT AND DELIVERY CHARGE. IF CHECK, SUBJECT FOR 3 DAYS CLEARING.

WARRANTY:

FOR FLOOR/CEILING: ONE (1) YEAR FREE PARTS AND LABOR, FIVE (5) YEARS WARRANTY ON COMPRESSOR.

NOTES: PRICES ARE SUBJECT TO CHANGE WITHOUT PRIOR NOTICE.

PRICES IS VAT INCLUSIVE.

**** Cost of Installation is Package with the Unit(s), this cost cannot avail separately (cost will be based on actual works).**

We thank you for giving opportunity to offer our product and services, hoping we receive your purchase order.

If you need assistance, don't hesitate to call the under signed at 0917-807-8607 or email at kmi_asst@kolinphil.com.ph

Very Truly Yours,

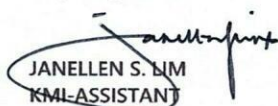
JANELLEN S. LIM
KMI-ASSISTANT

Noted by:

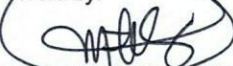
MART NATHANIEL R. FLORES
KMI-SUPERVISOR

Approved By:

MS. EDITHA M. FLORES
AVP - FINANCE

Conforme:

SIGNATURE OVER PRINTED NAME

KMI-QUOTE-05-25-0416
REG-24%

Kolin Marketing, Inc.
1854 Sta. Rita St., Guadalupe Nuevo, Makati City
Tel.: (632) 8852-6473
Fax: (632) 8852-2170 / (632) 8852-4792
 www.kolinphil.com.ph / kolinphilippines



Customer Name : IPMHT LABELES & PACKAGING CORP. Date : 5-20-78
 Address : 138 ISYTIKUNG RD. BRGY. DOMINOS DAVAO CITY SJR No. : 1456903

Establishment Type : Residential ☐ Area Surveyed :
 Commercial ☒ Area Surveyed : CONFERENCE ROOM

Recommended Product Model : KUM-1C40-111M32

Cooling Capacity Computation

Floor Area : 73.2 sqm.
 Ceiling Height : 3.7 mtr.

note: add 20% per meter in excess of 3 meters in the initial cooling capacity computed.

Floor Area :	<u>73.2</u>	x	550 Btu/h	<u>40260</u> Btu/h
Ceiling Height (excess of 3 mtrs.) :	<u>3.7</u>	x	20%	<u>8,052</u> Btu/h
Window Direct Sunlight		x	20% - 50%	
Total Cooling Capacity				<u>48,312</u> Btu/h

Add : Additional Heat Load

No. of Person	<u>2</u>	x	300 Btu/h	<u>600</u> Btu/h
No. of Ordinary Light (<40w)	<u>20</u>	x	200 Btu/h	<u>4000</u> Btu/h
No. of Special Light (>40w)		x	400 Btu/h	
No. of Refrigerator (< 6 cu.ft.)		x	400 Btu/h	
No. of Refrigerator (> 6 cu.ft.)		x	800 Btu/h	
No. of Cooking Range		x	1500 Btu/h	
No. of Laptop Computer		x	150 Btu/h	
No. of Desktop Computer		x	400 Btu/h	
No. of Printer		x	500 Btu/h	
No. of Photocopier		x	1000 Btu/h	
Total Cooling Capacity				<u>4600</u> Btu/h

Recommended Cooling Capacity 5.8 52,912 Btu/h

Note : Compressor warranty will be reduced to ____ yr. if air-conditioner purchased is lower than the recommended cooling capacity or pipe lay-out is beyond the maximum allowable length.

Scope of Work Agreement

- | | | |
|-----------------------------------|---|--|
| 1. Copper tube lay-out | <input checked="" type="checkbox"/> Expose | <input type="checkbox"/> Embedded |
| 2. Chipping | <input type="checkbox"/> Included | <input checked="" type="checkbox"/> Not Included |
| 3. Fabricated Bracket | <input checked="" type="checkbox"/> Yes <input type="checkbox"/> Shop | <input checked="" type="checkbox"/> Site <input type="checkbox"/> No |
| 4. Service Ledge | <input type="checkbox"/> Yes | <input checked="" type="checkbox"/> No |
| 5. Dismantling of existing Aircon | <input type="checkbox"/> Included | <input checked="" type="checkbox"/> Not Included |
| 6. Ducting | <input type="checkbox"/> Yes | <input checked="" type="checkbox"/> No |

Dimension :

- Plastering, carpentry and restoration works are to be done by the customer.
- Wiring of electrical supply from main panel to air-conditioning unit are to be done by the customer.
- Processing of mechanical plan, working permit, electrical permit are to be done by the customer.
- Other concern;

CUSTOMER NEED PROVIDE POWER SUPPLY
AT THE OUTDOOR BRACKET
MAKE A HOLE IN CEILING/CLUB FOR THE
CONDENSATE DRAIN-OUT. CUSTOMER PROVIDE
SIX FEETING.

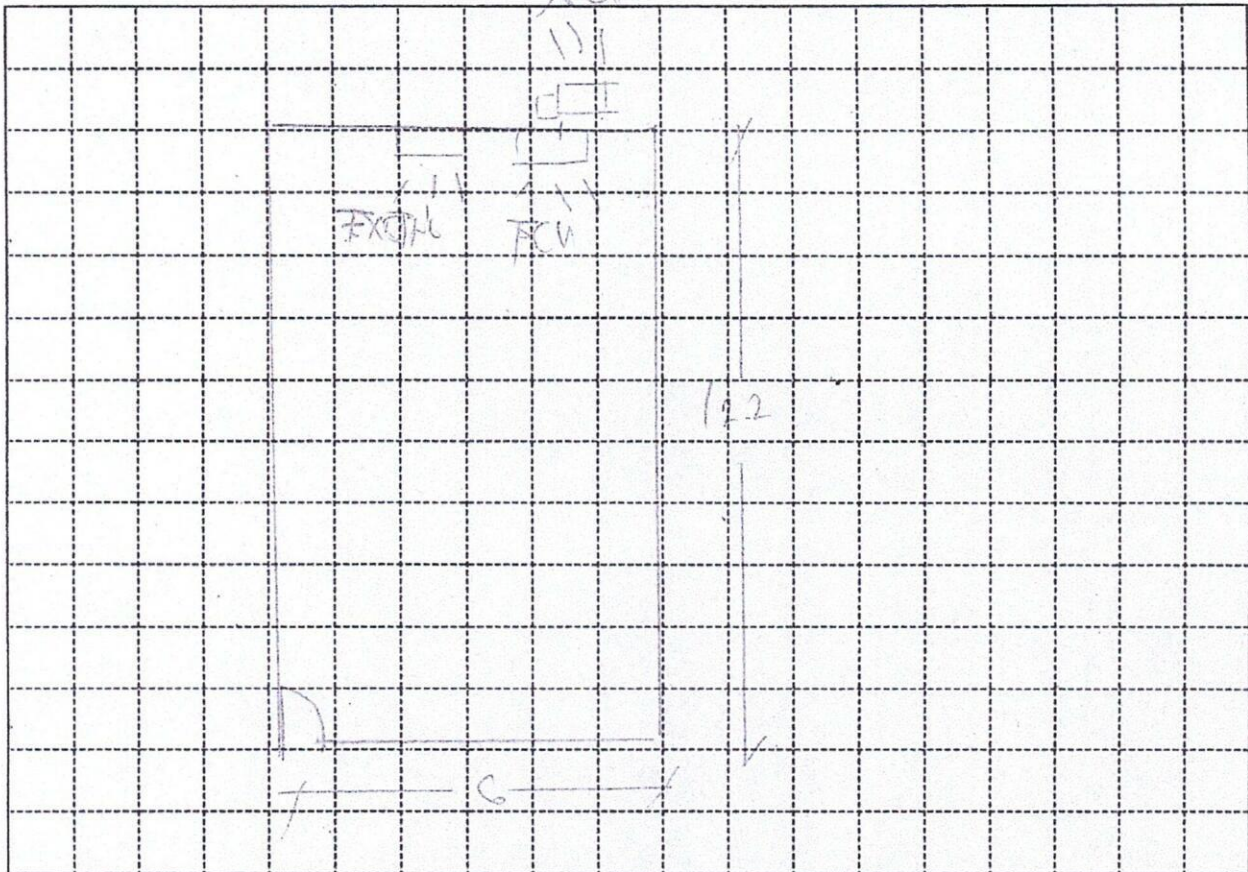

Indoor Unit Location : RIGHT OF EXISTING UNIT
 Outdoor Unit Location : LEFT OF EXISTING UNIT
 Pipe Length : 5 METERS / 17 FT
 Special Note :

Installation Cost Estimate			
Material Description	Qty.	Unit Cost	Total Cost
Copper Tube (excess of 10 ft.) 2330, 2430, 2520, 3520, 4620	7 FT	400	6800
Wire (Royal Cord-signal wire) (excess of 10ft.) 2.0mmx4C	14 FT	100	1400
Wire (Royal Cord - Breaker to ODU) 3.5mm / 5.5mm x 3C	7 FT	70	490
Circuit Breaker 20A, 30A, 40A/1ph, 40A/3ph	1	1000	1000
Bracket (ODU) (Imptd. / Fabricated) (Floor / Wall)	1	200	200
Bracket (WAC) Angle Type			
PVC Pipe (drain) 1/2", 3/4"	2	150	300
PVC Pipe (electrical) 3/4", 1"			
Drain Pump			
Drain Pump Hose	7 FT	15	105
Chipping Works FULL TRUCK mtr.	2	300	600
Dismantling Fee (existing air-conditioner)			
Initial Charge			12000
TOTAL ESTIMATE		P 25,265-	

Note :

- Initial Charge includes labor, 10ft. Copper tube, 10ft. Royal cord, Circuit breaker, Outdoor Bracket (SAC), Indoor Bracket (PAC) and Consumable materials.
- Survey fee will be **deducted** in the installation fee.

Prepared by:

Signature Over Printed Name

Customer Conforme:

Signature Over Printed Name