



May 6, 2025

ATTY. ARVIN SANTOS  
33 ROXAS ST. XAVIERVILLE 3, BRGY. LOYOLA HEIGHTS, QUEZON CITY  
TEL#: 0917-8055154

Dear Ma'am/Sir,

Kolin Marketing Inc., is extremely honored for your endorsement of Kolin brand and we are please to offer you with a special price/s for the following items.

A. EQUIPMENT & INSTALLATION

QTY	U/M	MODEL / DESCRIPTION	SRP	DISCOUNTED PRICE		AMOUNT
1	UNIT/S	MODEL: KSM-IW20-WCT10M1M32 KOLIN WALL MOUNTED CERTUS SERIES AIRCONDITIONER 18,990 Kj/h (2.0HP) REGULAR INVERTER R-32	41,995.00	27,916.20 7	PHP	27,916.20
1	UNIT/S	MODEL: KSM-IW15-WCT10M1M32 KOLIN WALL MOUNTED CERTUS SERIES AIRCONDITIONER 12,660 Kj/h (1.5HP) REGULAR INVERTER R-32	32,995.00	21,076.20 7	PHP	21,076.20
1	UNIT/S	MODEL: KSM-IW10-WCT10M1M32 KOLIN WALL MOUNTED CERTUS SERIES AIRCONDITIONER 9,800 Kj/h (1.0HP) REGULAR INVERTER R-32	29,995.00	18,796.20 7	PHP	18,796.20
TOTAL UNIT COST					PHP	7 67,788.60
ESTIMATED COST OF INSTALLATION (please see attached)					PHP	57,300.00
TOTAL ESTIMATED COST OF THE PROJECT					PHP	125,088.60

TERMS OF PAYMENT:

FULL PAYMENT OF UNIT AND DELIVERY CHARGE. IF CHECK, SUBJECT FOR 3 DAYS CLEARING.

WARRANTY:

FOR SPLIT TYPE : ONE (1) YEAR FREE PARTS AND LABOR, THREE YEARS (3) MAIN PCB , TEN (10) YEARS WARRANTY ON COMPRESSOR.

NOTES: PRICES ARE SUBJECT TO CHANGE WITHOUT PRIOR NOTICE.

PRICES IS VAT INCLUSIVE.

**\*\* Cost of Installation is Package with the Unit(s), this cost cannot avail separately.**

We thank you for giving opportunity to offer our product and services, hoping we receive your purchase order.

If you need assistance, don't hesitate to call the under signed at 0917-807-8607 or email at kmi\_asst@kolinphil.com.ph

Very Truly Yours,

JANELLEN S. LIM  
KMI-ASSISTANT

Noted by:

MART WATHANIEL R. FLORES  
KMI-SUPERVISOR

Approved By:

MS. EDITHA M. FLORES  
AVP - FINANCE

KMI-QUOTE-05-25-0332-rev  
REG-24%/4K

Conforme:

SIGNATURE OVER PRINTED NAME



Kolin Marketing, Inc.

1854 Sta. Rita St., Guadalupe Nuevo, Makati City

Tel.: (632) 8852-6473

Fax: (632) 8852-2170 / (632) 8852-4792

www.kolinphil.com.ph / kolinphilippines

May 6, 2025

ATTY ARVIN SANTOS

33 Roxas St. Xavierville 3, Brgy Ioyola Heights, Quezon City

0917-8055154

Model	Qty
KSM-IW20-WCT10M1M32	1
KSM-IW15-WCT10M1M32	1
KSM-IW10-WCT10M1M32	1

<b>BEDROOM1</b>	Area ≈ 13.4 sq.m
-----------------	------------------

ACU 1 1.5hp Wallmounted Inverter *KSM-IW15-WCT10M1M32*

Estimated Pipe Length : 20 ft

Estimated Royal Cord Length : 25 ft

Initial Charge P 7,500.00

Includes:

Labor

10ft Copper Tube

10ft Royal Cord

Outdoor Bracket (wall)

Other Consumables

Additional Charges	Description	Unit	Price Per Unit	Subtotal
Copper Tube	3/8"x 1/4"	10 ft	P 350.00 / ft	P 3,500.00
Royal Cord	2.mm2 x 4C	15 ft	P 100.00 / ft	P 1,500.00
Royal Cord (ODU-Breaker)	3.5mm2 x 3C	5 ft	P 60.00 / ft	P 300.00
Circuit Breaker(NEMA)	20A/ 1Ph	1 pc(s)	P 1,000.00 / pc	P 1,000.00
PVC(Drainline)	Blue-3/4"	3 pc(s)	P 150.00 / pc	P 450.00
				P 6,750.00

<b>Estimated Charges</b>	<b>P 14,250.00</b>
--------------------------	--------------------

<b>BEDROOM2</b>	Area ≈ 11 sq.m
-----------------	----------------

ACU 2 1.0hp Wallmounted Inverter *KSM-IW10-WCT10M1M32*

Estimated Pipe Length : 30 ft

Estimated Royal Cord Length : 35 ft

Initial Charge P 7,500.00

Includes:

Labor

10ft Copper Tube

10ft Royal Cord

Outdoor Bracket (wall)

Other Consumables

Additional Charges	Description	Unit	Price Per Unit	Subtotal
Copper Tube	3/8"x 1/4"	20 ft	P 350.00 / ft	P 7,000.00
Royal Cord	2.mm2 x 4C	25 ft	P 100.00 / ft	P 2,500.00
Royal Cord (ODU-Breaker)	3.5mm2 x 3C	5 ft	P 60.00 / ft	P 300.00
Circuit Breaker(NEMA)	20A/ 1Ph	1 pc(s)	P 1,000.00 / pc	P 1,000.00
PVC(Drainline)	Blue-3/4"	3 pc(s)	P 150.00 / pc	P 450.00
				P 11,250.00

<b>Estimated Charges</b>	<b>P 18,750.00</b>
--------------------------	--------------------

<b>BEDROOM3</b>	Area ≈ 19 sq.m
-----------------	----------------

ACU 3 2.0hp Wallmounted Inverter *KSM-IW20-WCT10M1M32*

Estimated Pipe Length : 10 ft

Estimated Royal Cord Length : 15 ft

Initial Charge P 7,500.00

Includes:

Labor

10ft Copper Tube

10ft Royal Cord

Outdoor Bracket (wall)

Other Consumables

Additional Charges	Description	Unit	Price Per Unit	Subtotal
Royal Cord	2.mm2 x 4C	5 ft	P 100.00 / ft	P 500.00
Royal Cord (ODU-Breaker)	3.5mm2 x 3C	5 ft	P 60.00 / ft	P 300.00
Circuit Breaker(NEMA)	30A/ 1Ph	1 pc(s)	P 1,000.00 / pc	P 1,000.00
PVC(Drainline)	Blue-3/4"	2 pc(s)	P 150.00 / pc	P 300.00
				P 2,100.00

<b>Estimated Charges</b>	<b>P 9,600.00</b>
--------------------------	-------------------



<b>FAMILY ROOM</b>	Area ≈ 31 sq.m
--------------------	----------------

**ACU 4 1.5hp Wallmounted Inverter** **KSM-15MB1INV**

Estimated Pipe Length : 10 ft

Estimated Royal Cord Length : 15 ft

Labor Charge P 7,600.00

Dismantle/Relocate

Indoor and outdoor unit

Additional Charges	Description	Unit	Price Per Unit	Subtotal
Copper Tube	1/4"x 1/2"	10 ft	P 350.00 / ft	P 3,500.00
Royal Cord	2.mm2 x 4C	5 ft	P 100.00 / ft	P 500.00
Royal Cord (ODU-Breaker)	3.5mm2 x 3C	5 ft	P 60.00 / ft	P 300.00
Circuit Breaker(NEMA)	30A/ 1Ph	1 pc(s)	P 1,000.00 / pc	P 1,000.00
PVC(Drainline)	Blue-3/4"	2 pc(s)	P 150.00 / pc	P 300.00
General Cleaning	1.5hp	1 pc(s)	P 1,500.00 / pc	P 1,500.00
				P 7,100.00

<b>Estimated Charges</b>	<b>P 14,700.00</b>
--------------------------	--------------------

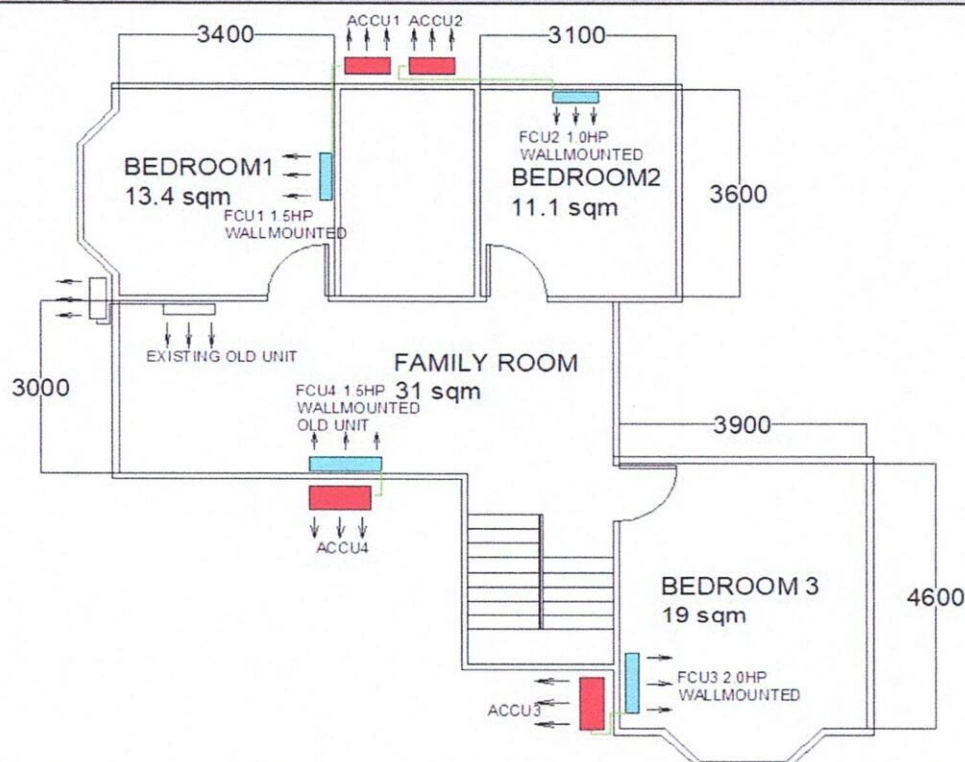

<b>Total Estimated Charges</b>	<b>P 57,300.00</b>
--------------------------------	--------------------

**Validity:** This quotation is valid for a period of fifteen (15) days from the date thereof, subject to our confirmation thereafter.

**Note:**

- 1 Location of indoor units were agreed by the customer and Kolin's surveyor. Outdoor is recommendation only, for confirmation.
- 2 AC drain line will be tapped to the nearest drain provision provided by the customer's contractor.
- 3 Customer need to provide power supply at the outdoor location/breaker each units.
- 4 Coppertube, wires and drainline expose in the area.
- 5 Need for site visit and meeting with installer for final location and markings of area, drainline and coppertube lay-out.
- 6 **ACU4; old unit existing .use existing breaker, bracket and communication wires. Coppertube if still serviceable.**
- 7 Working days: Monday to Saturday, 8am- 5pm with parking.
- 8 Mechanical Plans, Permits, Electrical permits not included.
- 9 Deflectors, masonry, carpentry, chipping & plastering (finishing & restoration) are not included in the installation.
- 10 Electrical power supply (feeder line) **220v/ 60hz/ 1ph** , is not included in the scope of work of Kolin.
- 10 **Final charges will be based on actual installation.**

Prepared by:

**Jeoffrey Dadios**

Field Surveyor

Customer Conformance:

Signature Over Printed Name

Reviewed by:

**Engr. Kenneth Zamora**

Service Supervisor

Field and Shop Operation