



May 6, 2025

MR. TIMOTHY LEE ABUY
B10 L5 BETHLEHEM ST., NORTH OLYMPUS SUBDIVISION, BRGY. KALIGAYAHAN ZABARTE, QUEZON CITY
TEL#: 0919-2620231

Dear Ma'am/Sir,

Kolin Marketing Inc., is extremely honored for your endorsement of Kolin brand and we are please to offer you with a special price/s for the following items.

A. EQUIPMENT & INSTALLATION

QTY	U/M	MODEL / DESCRIPTION	SRP	DISCOUNTED PRICE		AMOUNT
1	UNIT/S	MODEL: KSM-IW10-WCT10M1M32 KOLIN WALL MOUNTED CERTUS SERIES AIRCONDITIONER 9,800 Kj/h (1.0HP) REGULAR INVERTER R-32	29,995.00	18,796.20	PHP	18,796.20
TOTAL UNIT COST					PHP	18,796.20
ESTIMATED COST OF INSTALLATION (please see attached)					PHP	9,945.00
OTHERS: DELIVERY CHARGE					PHP	600.00
TOTAL ESTIMATED COST OF THE PROJECT					PHP	29,341.20

TERMS OF PAYMENT:

FULL PAYMENT OF UNIT AND DELIVERY CHARGE. IF CHECK, SUBJECT FOR 3 DAYS CLEARING.

WARRANTY:

FOR SPLIT TYPE : ONE (1) YEAR FREE PARTS AND LABOR, THREE YEARS (3) MAIN PCB , TEN (10) YEARS WARRANTY ON COMPRESSOR.

NOTES: PRICES ARE SUBJECT TO CHANGE WITHOUT PRIOR NOTICE.

PRICES IS VAT INCLUSIVE.

**** Cost of Installation is Package with the Unit(s), this cost cannot avail separately.**

We thank you for giving opportunity to offer our product and services, hoping we receive your purchase order.

If you need assistance, don't hesitate to call the under signed at 0917-807-8607 or email at kmi_asst@kolinphil.com.ph

Very Truly Yours,

JANELLEN S. LIM
KMI-ASSISTANT

Noted by:

MART NATHANIEL R. FLORES
KMI-SUPERVISOR

Approved By:

MS. EDITHA M. FLORES
AVP - FINANCE

KMI-QUOTE-05-25-0349
ECY-24%/4K

Conforme:

SIGNATURE OVER PRINTED NAME



KOLIN Philippines International Inc.
Survey Form

No 003632

Customer Name : TIMOTHY LEE ARMY Date : 5-2-28
 Address : BIO WILL SETTLEMENT ST. MORA OLIMPOS SJR No. : 28771
 Establishment Type : Residential ☒ Area Surveyed : MASTER (R) Room
 Commercial ☐ Area Surveyed : _____
 Recommended Product Model : KSM-1W10-WOTOM/1M32

Cooling Capacity Computation

Floor Area : 97 sqm.
 Ceiling Height : 2.4 mtr.

note: add 20% per meter in excess of 3 meters in the initial cooling capacity computed.

Floor Area :	<u>97</u>	x	550 Btu/h	<u>5335</u> Btu/h
Ceiling Height (excess of 3 mtrs.) :		x	20%	
Window Direct Sunlight		x	20% - 50%	
Total Cooling Capacity				<u>5335</u> Btu/h

Add : Additional Heat Load

No. of Person	<u>2</u>	x	300 Btu/h	<u>600</u> Btu/h
No. of Ordinary Light (<40w)	<u>4</u>	x	200 Btu/h	<u>800</u> Btu/h
No. of Special Light (>40w)		x	400 Btu/h	
No. of Refrigerator (< 6 cu.ft.)		x	400 Btu/h	
No. of Refrigerator (> 6 cu.ft.)		x	800 Btu/h	
No. of Cooking Range		x	1500 Btu/h	
No. of Laptop Computer		x	150 Btu/h	
No. of Desktop Computer / TV	<u>1</u>	x	400 Btu/h	<u>400</u> Btu/h
No. of Printer		x	500 Btu/h	
No. of Photocopier		x	1000 Btu/h	
Total Cooling Capacity				<u>1800</u> Btu/h

Recommended Cooling Capacity

7135 Btu/h

Note : Compressor warranty will be reduced to ____ yr. if air-conditioner purchased is lower than the recommended cooling capacity or pipe lay-out is beyond the maximum allowable length.

Scope of Work Agreement

- | | | |
|-----------------------------------|--|--|
| 1. Copper tube lay-out | <input checked="" type="checkbox"/> Expose | <input type="checkbox"/> Embedded |
| 2. Chipping | <input type="checkbox"/> Included | <input checked="" type="checkbox"/> Not Included |
| 3. Fabricated Bracket | <input type="checkbox"/> Yes <input type="checkbox"/> Shop | <input type="checkbox"/> Site <input checked="" type="checkbox"/> No |
| 4. Service Ledge | <input type="checkbox"/> Yes | <input checked="" type="checkbox"/> No |
| 5. Dismantling of existing Aircon | <input type="checkbox"/> Included | <input checked="" type="checkbox"/> Not Included |
| 6. Ducting | <input type="checkbox"/> Yes | <input checked="" type="checkbox"/> No |

Dimension :

- Plastering, carpentry and restoration works are to be done by the customer.
- Wiring of electrical supply from main panel to air-conditioning unit are to be done by the customer.
- Processing of mechanical plan, working permit, electrical permit are to be done by the customer.
- Other concern: HAS CUSTOMER NEED TO PROVIDE POWER SUPPLY AT THE OUTDOOR REFRIGERANT?

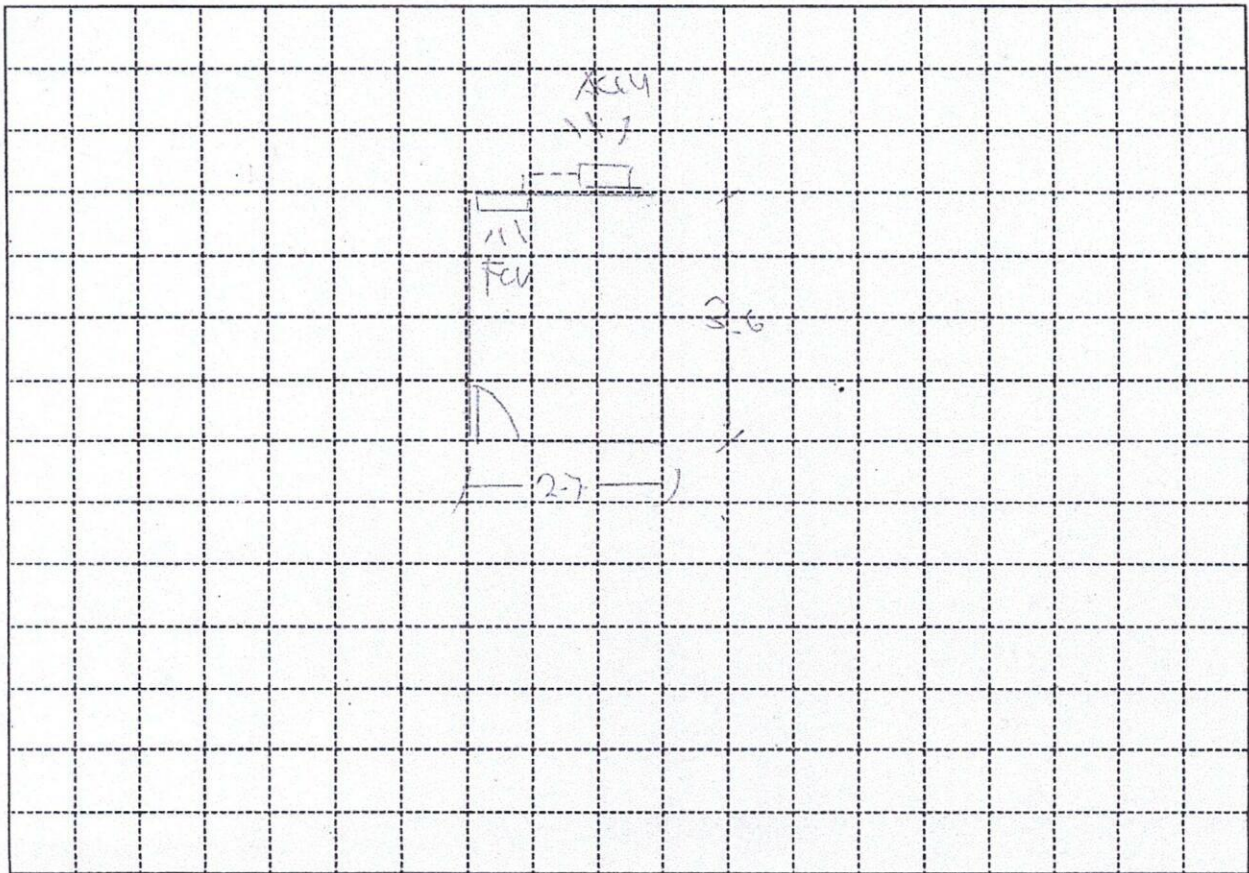

Indoor Unit Location : LEFT OF WINDOW, EXISTING
 Outdoor Unit Location : LOWEST OF WINDOW, EXISTING
 Pipe Length : 10 FT
 Special Note : _____

Installation Cost Estimate				
Material Description	Qty.	Unit Cost	Total Cost	
Copper Tube (excess of 10 ft.)	2330, 2430, 2520, 3520, 4620			
Wire (Royal Cord-signal wire) (excess of 10ft.)	2.0mmx4C	75	100	7500
Wire (Royal Cord - Breaker to ODU)	3.5mm / 5.5mm x 3C	75	60	4500
Circuit Breaker	20A, 30A, 40A/1ph, 40A/3ph	1	100	1000
Bracket (ODU)	(Imptd. / Fabricated) : (Floor / Wall)			
Bracket (WAC)	Angle Type			
PVC Pipe (drain)	1/2", 3/4"	1	150	150
PVC Pipe (electrical)	3/4", 1"			
Drain Pump				
Drain Pump Hose	WHITE 1/2"	7 FT	25	175
Chipping Works	mtr.			
Dismantling Fee (existing air-conditioner)				
Initial Charge				7500
TOTAL ESTIMATE			P	9,925

Note :

- Initial Charge includes labor, 10ft. Copper tube, 10ft. Royal cord, Circuit breaker, Outdoor Bracket (SAC), Indoor Bracket (PAC) and Consumable materials.
- Survey fee will be **deducted** in the installation fee.

Prepared by:

JEFFREY D. D. 105
 Signature Over Printed Name

Customer Conforms:

Signature Over Printed Name