



May 7, 2025

MR. LUIS LICHAUCO  
3 OHIO ST BALETE DR., BRGY. NEW MANILA, QUEZON CITY  
TEL#: 0920-9530469

Dear Ma'am/Sir,

Kolin Marketing Inc., is extremely honored for your endorsement of Kolin brand and we are please to offer you with a special price/s for the following items.

A. EQUIPMENT & INSTALLATION

| QTY   | U/M    | MODEL / DESCRIPTION  | SRP       | DISCOUNTED PRICE |     | AMOUNT    |
|---|--------|--|-----------|------------------|-----|-----------|
| 1   | UNIT/S | MODEL: KSM-IW15-WCT10M1M32<br>KOLIN WALL MOUNTED CERTUS SERIES AIRCONDITIONER<br>12,660 Kj/h (1.5HP) REGULAR INVERTER R-32 | 32,995.00 | 21,076.20<br>7   | PHP | 21,076.20 |
| TOTAL UNIT COST   |        |  |           |                  | PHP | 21,076.20 |
| ESTIMATED COST OF INSTALLATION (please see attached) w/ dismantling of old unit |        |  |           |                  | PHP | 10,495.00 |
| OTHERS: DELIVERY CHARGE   |        |  |           |                  | PHP | 600.00    |
| TOTAL ESTIMATED COST OF THE PROJECT   |        |  |           |                  | PHP | 32,171.20 |

TERMS OF PAYMENT:

FULL PAYMENT OF UNIT AND DELIVERY CHARGE. IF CHECK, SUBJECT FOR 3 DAYS CLEARING.

WARRANTY:

FOR SPLIT TYPE : ONE (1) YEAR FREE PARTS AND LABOR, THREE YEARS (3) MAIN PCB , TEN (10) YEARS WARRANTY ON COMPRESSOR.

NOTES: PRICES ARE SUBJECT TO CHANGE WITHOUT PRIOR NOTICE.

PRICES IS VAT INCLUSIVE.

**\*\* Cost of Installation is Package with the Unit(s), this cost cannot avail separately.**

We thank you for giving opportunity to offer our product and services, hoping we receive your purchase order.

If you need assistance, don't hesitate to call the under signed at 0917-807-8607 or email at kmi\_asst@kolinphil.com.ph

Very Truly Yours,

JANELLEN S. LIM  
KMI-ASSISTANT

Noted by:

MART NATHANIEL R. FLORES  
KMI-SUPERVISOR

Approved By:

MS. EDITHA M. FLORES  
AVP - FINANCE

KMI-QUOTE-05-25-0357  
DCG-24%/4K

Conforme:

SIGNATURE OVER PRINTED NAME

Kolin Marketing, Inc.  
1854 Sta. Rita St., Guadalupe Nuevo, Makati City  
Tel.: (632) 8852-6473  
Fax: (632) 8852-2170 / (632) 8852-4792  
www.kolinphil.com.ph / kolinphilippines

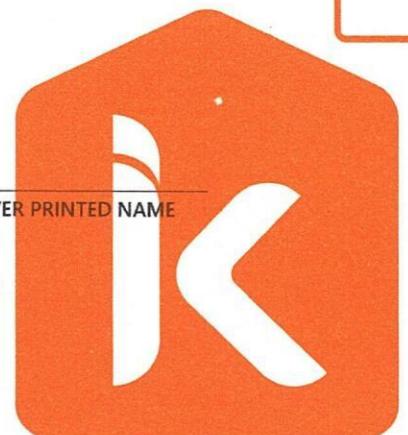



**KOLIN Philippines International Inc.**  
**Survey Form**

**No 003633**

Customer Name : LUIS LICHANCO Date : MAY 6, 2015  
 Address : 30110 ST. EXETER DRIVE RICH NEW MEXICO SJR No. : 259193  
QUICK CITY  
 Establishment Type : Residential ☒ Area Surveyed : BEDROOM 1  
 Commercial ☐ Area Surveyed : \_\_\_\_\_  
 Recommended Product Model : KSM-1WN-WCT10W1M31

**Cooling Capacity Computation**

Floor Area : 20 sqm.  
 Ceiling Height : 2.7 mtr.

note: add 20% per meter in excess of 3 meters in the initial cooling capacity computed.

|                                      |           |   |           |                    |
|--------------------------------------|-----------|---|-----------|--------------------|
| Floor Area :                         | <u>20</u> | x | 550 Btu/h | <u>11000</u> Btu/h |
| Ceiling Height (excess of 3 mtrs.) : |           | x | 20%       |                    |
| Window Direct Sunlight               |           | x | 20% - 50% |                    |
| Total Cooling Capacity               |           |   |           | <u>11000</u> Btu/h |

**Add : Additional Heat Load**

|                                  |          |   |            |                    |
|----------------------------------|----------|---|------------|--------------------|
| No. of Person                    | <u>2</u> | x | 300 Btu/h  | <u>600</u> Btu/h   |
| No. of Ordinary Light (<40w)     | <u>3</u> | x | 200 Btu/h  | <u>600</u> Btu/h   |
| No. of Special Light (>40w)      |          | x | 400 Btu/h  |                    |
| No. of Refrigerator (< 6 cu.ft.) |          | x | 400 Btu/h  |                    |
| No. of Refrigerator (> 6 cu.ft.) |          | x | 800 Btu/h  |                    |
| No. of Cooking Range             |          | x | 1500 Btu/h |                    |
| No. of Laptop Computer           |          | x | 150 Btu/h  |                    |
| No. of Desktop Computer          |          | x | 400 Btu/h  |                    |
| No. of Printer                   |          | x | 500 Btu/h  |                    |
| No. of Photocopier               |          | x | 1000 Btu/h |                    |
| Total Cooling Capacity           |          |   |            | <u>12000</u> Btu/h |

**Recommended Cooling Capacity**

1.3  
12,200 Btu/h

Note : Compressor warranty will be reduced to \_\_\_\_ yr. if air-conditioner purchased is lower than the recommended cooling capacity or pipe lay-out is beyond the maximum allowable length.

**Scope of Work Agreement**

- |                                   |  |  |
|-----------------------------------|--|--|
| 1. Copper tube lay-out            | <input checked="" type="checkbox"/> Expose                 | <input type="checkbox"/> Embedded                                    |
| 2. Chipping                       | <input type="checkbox"/> Included                          | <input checked="" type="checkbox"/> Not Included                     |
| 3. Fabricated Bracket             | <input type="checkbox"/> Yes <input type="checkbox"/> Shop | <input type="checkbox"/> Site <input checked="" type="checkbox"/> No |
| 4. Service Ledge                  | <input type="checkbox"/> Yes                               | <input checked="" type="checkbox"/> No                               |
| 5. Dismantling of existing Aircon | <input checked="" type="checkbox"/> Included               | <input type="checkbox"/> Not Included                                |
| 6. Ducting                        | <input type="checkbox"/> Yes                               | <input checked="" type="checkbox"/> No                               |

**Dimension :**

- Plastering, carpentry and restoration works are to be done by the customer.
- Wiring of electrical supply from main panel to air-conditioning unit are to be done by the customer.
- Processing of mechanical plan, working permit, electrical permit are to be done by the customer.
- Other concern:

DISMANTLE & INSTALL NEW UNIT  
REMOVE CONDENSATE AND WITH COMMUNICATION  
USE EXISTING OUTDOOR BRACKET & PIPING



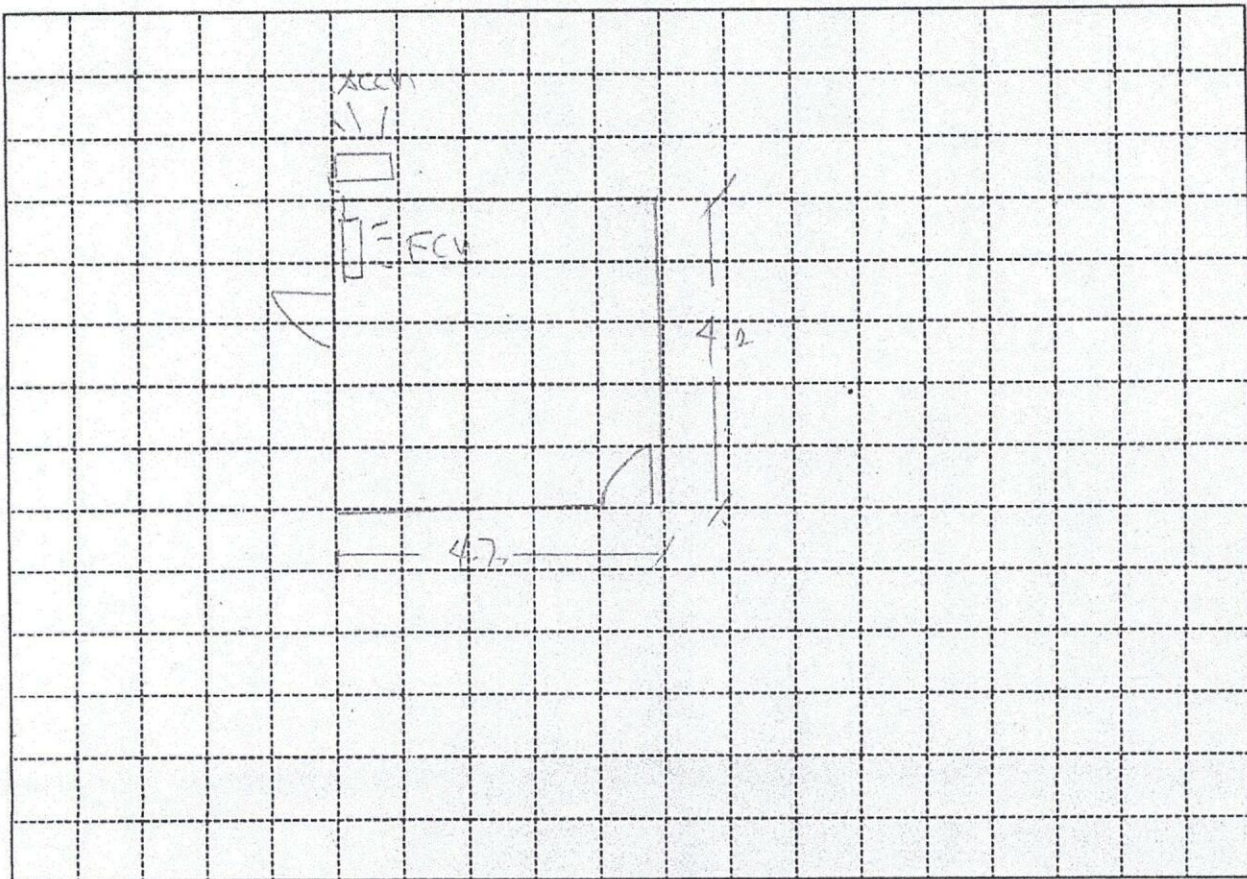

Indoor Unit Location : LEFT CORNER OF AREA, SAME LOCATION  
 Outdoor Unit Location : AT THE BACK, SAME LOCATION  
 Pipe Length : 10 FT  
 Special Note : \_\_\_\_\_

## Installation Cost Estimate

| Material Description  | Qty. | Unit Cost | Total Cost |
|---|------|-----------|------------|
| Copper Tube (excess of 10 ft.) 2330, 2430, 2520, 3520, 4620 |      |           |            |
| Wire (Royal Cord-signal wire) (excess of 10ft.) 2.0mmx4C    | 7 FT | 100       | 700        |
| Wire (Royal Cord - Breaker to ODU) 3.5mm / 5.5mm x 3C       | 7 FT | 60        | 420        |
| Circuit Breaker 20A, 30A, 40A/1ph, 40A/3ph                  |      |           |            |
| Bracket (ODU) (Imptd. / Fabricated) ; (Floor / Wall)        |      |           |            |
| Bracket (WAC) Angle Type                                    |      |           |            |
| PVC Pipe (drain) 1/2" - 3/4"                                |      |           |            |
| PVC Pipe (electrical) 3/4", 1"                              |      |           |            |
| Drain Pump  |      |           |            |
| Drain Pump Hose   | 7 FT | 20        | 140        |
| Chipping Works mtr.   |      |           |            |
| Dismantling Fee (existing air-conditioner)                  |      |           | 1,200      |
| Initial Charge  |      |           | 1,600      |
| TOTAL ESTIMATE  |      |           | P 10,495 - |

## Note :

1. Initial Charge includes labor, 10ft. Copper tube, 10ft. Royal cord, Circuit breaker, Outdoor Bracket (SAC), Indoor Bracket (PAC) and Consumable materials.
2. Survey fee will be **deducted** in the installation fee.

Prepared by:

Signature Over Printed Name

Customer Conforms:

Signature Over Printed Name