

ASTON CONDO TAFT
UNIT 1921, THE ASTON PLACE CONDO, 1862-B DOMINGA ST., BRGY. 45 PASAY CITY
ATTN: MS. PATTY MARASIGAN
TEL#: 0926-7185279

Dear Ma'am/Sir,

Kolin Marketing Inc., is extremely honored for your endorsement of Kolin brand and we are please to offer you with a special price/s for the following items.

A. EQUIPMENT & INSTALLATION

* OPTION 2 *

QTY	U/M	MODEL / DESCRIPTION	SRP	DISCOUNTED PRICE		AMOUNT
1	UNIT/S	MODEL: KS-IW20-MCAI1201M32 KOLIN WALL MOUNTED CERTUS A/ SERIES AIRCONDITIONER 19,000 Kj/h (2.0HP) FULL DC INVERTER W/ WIFI R-32	42,995.00	26,176.20	PHP	26,176.20
1	UNIT/S	MODEL: KA-100MCARINV32 KOLIN WINDOW TYPE CREO SERIES AIRCONDITIONER 9,700 Kj/h (1.0HP) FULL DC INVERTER R-32 WITH REMOTE (WxDxH) 17.7"x26.6"x13.8"	24,995.00	18,196.20	PHP	18,196.20
1	UNIT/S	MODEL: KA-75MCARINV32 KOLIN WINDOW TYPE CREO SERIES AIRCONDITIONER 8,400 Kj/h (.75HP) FULL DC INVERTER R-32 WITH REMOTE (WxDxH) 17.7"x26.6"x13.8"	22,495.00	16,496.20	PHP	16,496.20
TOTAL UNIT COST					PHP	60,868.60
ESTIMATED COST OF INSTALLATION (please see attached)					PHP	16,550.00
OTHERS: DELIVERY CHARGE					PHP	600.00
TOTAL ESTIMATED COST OF THE PROJECT					PHP	78,018.60

TERMS OF PAYMENT:

FULL PAYMENT OF UNIT AND DELIVERY CHARGE. IF CHECK, SUBJECT FOR 3 DAYS CLEARING.

BANK DETAILS:

- * Unit/s & Delivery: Account Name - KOLIN MARKETING INC. / Account# - 011808002307 (BDO-KALAYAAN)
- * Installation: Will be provided by assigned installer.
- ** You may settle first payment for unit/s & delivery. Installation payment can be settled directly to installer after actual works.

WARRANTY:

FOR SPLIT TYPE : ONE (1) YEAR FREE PARTS AND LABOR, THREE YEARS (3) MAIN PCB , TEN (10) YEARS WARRANTY ON COMPRESSOR.
FOR WINDOW TYPE: ONE (1) YEAR FREE PARTS AND LABOR, THREE YEARS (3) MAIN PCB, TEN (10) YEARS WARRANTY ON COMPRESSOR.

NOTES: PRICES ARE SUBJECT TO CHANGE WITHOUT PRIOR NOTICE.

PRICES IS VAT INCLUSIVE.

** Cost of Installation is Package with the Unit(s), this cost cannot avail separately (cost will be based on actual works).

We thank you for giving opportunity to offer our product and services, hoping we receive your purchase order.

If you need assistance, don't hesitate to call the under signed at 0917-807-8607 or email at kmi_asst@kolinphil.com.ph

Very Truly Yours,

JANELLEN S. LIM
KMI-ASSISTANT

Noted By:
MART NATHANIEL R. FLORES
KMI-SUPERVISOR

Approved By: 11/10/25
MS. EDITHA M. FLORES
AVP - FINANCE

KMI-QUOTE-11-25-0787
OMF-24%/6.5K/800/600

Conforme: _____
SIGNATURE OVER PRINTED NAME



November 10, 2025

ASTON CONDO TAFT

Unit 1921, The Aston Place Condo, Dominga St. Brgy 45, Pasay City

0926-7185279

KSG-IWF-20WFFY-8K1M32	1
KAG-100WCINV	1
KAG-75WCINV	1

LIVING, DINING, KITCHEN	Area ≈ 22 sq.m
--------------------------------	----------------

ACU 1	2.0hp Wallmounted Inverter	KSG-IWF-20WFFY-8K1M32	
Estimated Pipe Length :	20	ft	
Estimated Royal Cord Length :	25	ft	
Initial Charge			P 7,500.00

Includes:

- Labor
- 10ft Copper Tube
- 10ft Royal Cord
- Outdoor Bracket (FLOOR)
- Other Consumables

Additional Charges	Description	Unit	Price Per Unit	Subtotal
Copper Tube	1/4"x 1/2"	10 ft	P 350.00 / ft	P 3,500.00
Royal Cord	2.mm2 x 4C	15 ft	P 100.00 / ft	P 1,500.00
Royal Cord (ODU-Breaker)	3.5mm2 x 3C	5 ft	P 60.00 / ft	P 300.00
Circuit Breaker(NEMA)	20A/ 1Ph	1 pc(s)	P 1,000.00 / pc	P 1,000.00
				P 6,300.00

Estimated Charges	P 13,800.00
--------------------------	--------------------

BEDROOM1	Area ≈ 10 sq.m
-----------------	----------------

ACU2	1.0hp Windowtype Inverter	KAG-100WCINV	
Initial charge			P 1,200.00
Drain Hose	White -1/2"	7 ft	P 25.00 / ft P 175.00 P 175.00

Estimated charges	P 1,375.00
--------------------------	-------------------

BEDROOM 2	Area ≈ 8.5 sq.m
------------------	-----------------

ACU3	0.75hp Windowtype Inverter	KAG-75WCINV	
Initial charge			P 1,200.00
Drain Hose	White -1/2"	7 ft	P 25.00 / ft P 175.00 P 175.00

Estimated charges	P 1,375.00
--------------------------	-------------------

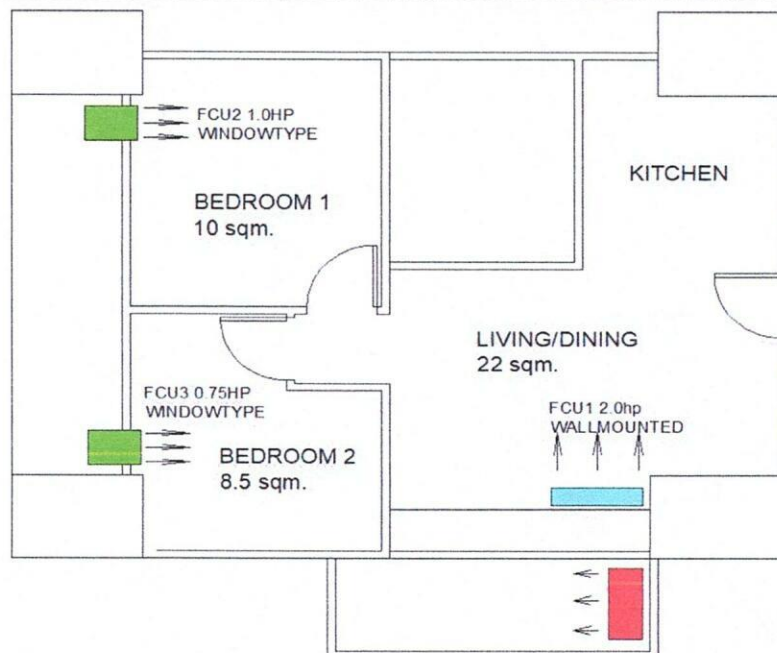

Validity: This quotation is valid for a period of fifteen (15) days from the date thereof, subject to our confirmation thereafter.

Note:

- 1 Location of indoor and outdoor units were agreed by the customer and Kolin's surveyor.
- 2 **KAG-100WCINV and KAG-75WCINV Dimension: $W \times D \times H$, = 450 X 640 x 350 mm. (18 x 25 x 14 inches)**
- 3 AC drain line will be tapped to the nearest drain provision provided by the customer's contractor.
- 4 Expose coppertube in the area.
- 5 Working days: Monday to Saturday, 8am- 5pm without parking for confirmation. Need working permit.
- 6 Mechanical Plans, Permits, Electrical permits not included.
- 7 Deflectors, masonry, carpentry, chipping & plastering (finishing & restoration) are not included in the installation.
- 8 Electrical power supply (feeder line) **220v/ 60hz/ 1ph**, is not included in the scope of work of Kolin.
- 9 **Final charges will be based on actual installation.**

Prepared by:

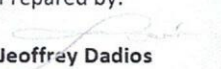
Jeffrey Dadios
Field Surveyor

Customer Conformance:

Signature Over Printed Name

Reviewed by:

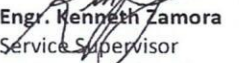
Engr. Kenneth Zamora
Service Supervisor
Field and Shop Operation