

FANTASTIC GOOD FOOD, INC.
ATTN: MR. KELVIN PETER YU
UNIT 31F, 8 WACK WACK CONDOMINIUM, WACK WACK ROAD, MANDALUYONG CITY
TEL#: 0917-3060428

Dear Ma'am/Sir,

Kolin Marketing Inc., is extremely honored for your endorsement of Kolin brand and we are please to offer you with a special price/s for the following items.

A. EQUIPMENT & INSTALLATION

* OPTION 1 *

QTY	U/M	MODEL / DESCRIPTION	SRP	DISCOUNTED PRICE		AMOUNT
2	UNIT/S	MODEL: KSG-IWF-20WFF-8K1M32 KOLIN WALL MOUNTED PRIMUS GOLD AIRCONDITIONER 19,000 KJ/h (2.0HP) FULL DC INVERTER W/ WIFI R-32	59,595.00	38,292.20	PHP	76,584.40
1	UNIT/S	MODEL: KAG-200WCINV KOLIN WINDOW TYPE QUAD SERIES AIRCONDITIONER 19,080 KJ/h (2.0HP) FULL DC INVERTER W/ WIFI R-32 (WxDxH) 26"x28"x17"	43,595.00	31,332.20	PHP	31,332.20
1	UNIT/S	MODEL: KAG-145WCINV KOLIN WINDOW TYPE QUAD SERIES AIRCONDITIONER 13,210 KJ/h (1.5HP) FULL DC INVERTER W/ WIFI R-32 (WxDxH) 22"x28"x15"	32,995.00	23,776.20	PHP	23,776.20
1	UNIT/S	MODEL: KAG-100WCINV KOLIN WINDOW TYPE QUAD SERIES AIRCONDITIONER 10,200 KJ/h (1.0HP) FULL DC INVERTER W/ WIFI R-32 (WxDxH) 18"x25"x14"	28,995.00	20,736.20	PHP	20,736.20
TOTAL UNIT COST					PHP	152,429.00
ESTIMATED COST OF INSTALLATION (please see attached)					PHP	27,975.00
OTHERS: DELIVERY CHARGE					PHP	600.00
TOTAL ESTIMATED COST OF THE PROJECT					PHP	181,004.00

TERMS OF PAYMENT:

FULL PAYMENT OF UNIT AND DELIVERY CHARGE. IF CHECK, SUBJECT FOR 3 DAYS CLEARING.

BANK DETAILS:

- * Unit/s & Delivery: Account Name - KOLIN MARKETING INC. / Account# - 011808002307 (BDO-KALAYAAN)
- * Installation: Will be provided by assigned installer.
- ** You may settle first payment for unit/s & delivery. Installation payment can be settled directly to installer after actual works.

WARRANTY:

FOR SPLIT TYPE : ONE (1) YEAR FREE PARTS AND LABOR, THREE YEARS (3) MAIN PCB, TEN (10) YEARS WARRANTY ON COMPRESSOR.
FOR WINDOW TYPE: ONE (1) YEAR FREE PARTS AND LABOR, THREE YEARS (3) MAIN PCB, TEN (10) YEARS WARRANTY ON COMPRESSOR.

NOTES: PRICES ARE SUBJECT TO CHANGE WITHOUT PRIOR NOTICE.

PRICES IS VAT INCLUSIVE.
** Cost of Installation is Package with the Unit(s), this cost cannot avail separately (cost will be based on actual works).

We thank you for giving opportunity to offer our product and services, hoping we receive your purchase order.

If you need assistance, don't hesitate to call the under signed at 0917-807-8607 or email at kmi_asst@kolinphil.com.ph

Very Truly Yours,

JANELLEN S. LIM
KMI-ASSISTANT

Noted By:
MART NATHANIEL R. FLORES
KMI-SUPERVISOR

Approved By:
MS. EDITHA M. FLORES
AVP - FINANCE

KMI-QUOTE-11-25-0774
REG-24%/7K/1.8K/1.3K

Conforme: _____
SIGNATURE OVER PRINTED NAME



NOVEMBER 03, 2025
 Fantastic Food, Inc
 Unit 31F 8Wack Wack Road, Wack Wack Mandaluyong City
 0917-3060428

MODEL	Qty
KSG-IWF-20Wfy8K1M32	2
KAG-200WCINV	1
KAG-145WCINV	1
KAG-100WCINV	1

OPTION 1- PRIMUS

LIVING,DINING	Area	45 sqm
----------------------	------	--------

ACU 1	2.0 HP Wall Mounted Inverter	KSG-IWF-20Wfy8K1M32			
	Estimated Pipe Length =	13 ft			
	Estimated Royal Cord Length =	18 ft			
	Initial Charge				₱ 7,500.00
	Includes:				
	Labor				
	10ft Copper Tube				
	10ft Royal Cord				
	Outdoor Bracket (FLOOR)				
	Consumables				
	Installation Materials	Description	Qty	Price per qty	Subtotal
	Copper Tube	Ø 1/4" x Ø 1/2"	3 ft	₱ 350.00/ft	₱ 1,050.00
	Royal Cord (comm. wire)	2.mm2 x 4C	8 ft	₱ 100.00/ft	₱ 800.00
	Royal Cord (ACCU-Breaker)	3.5mm x 3c	5 ft	₱ 60.00/ft	₱ 300.00
	Circuit Breaker waterproof	20A/ 1Ph	1 pc/s	₱ 1,000.00/pc	₱ 1,000.00
	PVC blue	3/4" x 10'	4 pc/s	₱ 150.00/pc	₱ 600.00
					₱ 3,750.00

Estimated Charges	₱ 11,250.00
-------------------	-------------

ACU 2	2.0 HP Wall Mounted Inverter	KSG-IWF-20Wfy8K1M32			
	Estimated Pipe Length =	13 ft			
	Estimated Royal Cord Length =	18 ft			
	Initial Charge				₱ 7,500.00
	Includes:				
	Labor				
	10ft Copper Tube				
	10ft Royal Cord				
	Outdoor Bracket (FLOOR)				
	Consumables				
	Installation Materials	Description	Qty	Price per qty	Subtotal
	Copper Tube	Ø 1/4" x Ø 1/2"	3 ft	₱ 350.00/ft	₱ 1,050.00
	Royal Cord (comm. wire)	2.mm2 x 4C	8 ft	₱ 100.00/ft	₱ 800.00
	Royal Cord (ACCU-Breaker)	3.5mm x 3c	5 ft	₱ 60.00/ft	₱ 300.00
	Circuit Breaker waterproof	20A/ 1Ph	1 pc/s	₱ 1,000.00/pc	₱ 1,000.00
	PVC blue	3/4" x 10'	4 pc/s	₱ 150.00/pc	₱ 600.00
					₱ 3,750.00

Estimated Charges	₱ 11,250.00
-------------------	-------------

BEDROOM2			Area	12 sqm
ACU 3	1.0 HP Window type Inverter	KAG-100WCINV		
	Initial Charge			₱ 1,200.00
	Includes:			
	Labor			
	Installation Materials			
	Window type bracket	1 pc/s	₱ 450.00/pc	₱ 450.00
	Drain Hose	White -1/2"	7 ft ₱ 25.00/ft	₱ 175.00
				₱ 625.00
Estimated Charges				₱ 1,825.00

BEDROOM1			Area	13 sqm
ACU 4	1.5 HP Window type Inverter	KAG-145WCINV		
	Initial Charge			₱ 1,200.00
	Includes:			
	Labor			
	Consumables			
	Installation Materials			
	Window type bracket	1 pc/s	₱ 450.00/pc	₱ 450.00
	Drain Hose	White -1/2"	7 ft ₱ 25.00/ft	₱ 175.00
				₱ 625.00
Estimated Charges				₱ 1,825.00

BEDROOM1			Area	24 sqm
ACU 5	2.0 HP Window type Inverter	KAG-200WCINV		
	Initial Charge			₱ 1,200.00
	Includes:			
	Labor			
	Consumables			
	Installation Materials			
	Window type bracket	1 pc/s	₱ 450.00/pc	₱ 450.00
	Drain Hose	White -1/2"	7 ft ₱ 25.00/ft	₱ 175.00
				₱ 625.00
Estimated Charges				₱ 1,825.00

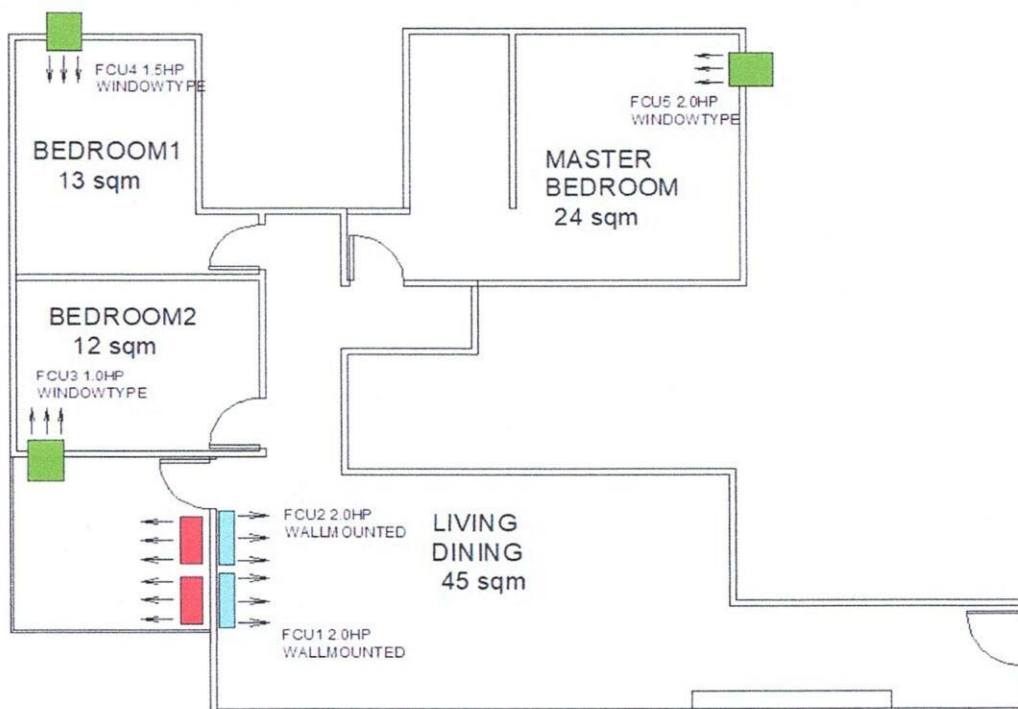

Validity: This quotation is valid for a period of fifteen (15) days from the date thereof, subject to our confirmation thereafter.

Installation notes:

- 1 Location of indoor and outdoor units were agreed by the customer and Kolin's surveyor.
- 2 AC drain line will be tapped to the nearest drain provision provided by the customer's contractor.
- 3 Need for site visit before installation.
- 4 Copper tube expose in the area. Cover the above window for the location of indoor units.
- 5 KAG-100WCINV Dimension: (WxDxH) 450 x 640 x 350 mm / 18 x 25 x 14 inches
- 6 KAG-145WCINV Dimension: (WxDxH) 560 x 708 x 375 mm / 22 x 28 x 15 inches
- 7 KAG-200WCINV Dimension: (WxDxH) 660 x 700 x 428 mm / 26 x 28 x 17 inches
- 8 Working days: Monday to Saturday, 8am- 5pm with parking. Need working permit.
- 9 Mechanical Plans, Permits, Electrical permits not included.
- 10 Deflectors, masonry, carpentry, chipping & plastering (finishing & restoration) are not included in the installation.
- 11 Air conditioning drain line and Electrical power supply (feeder line) **220v/ 60hz/ 1ph**, should be provided by customer's contractor.
- 12 **Final charges will be based on actual installation.**

Prepared by:

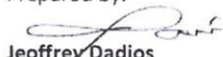
Jeffrey Dadios
Field Surveyor

Customer Conformer:

Signature Over Printed Name

Reviewed by:

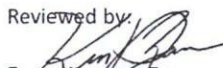
Engr. Kenneth Zamora
Service Supervisor Shop and
Field Operation