

THE BUILDING / MR. ROEL TUQUIB
148 D TUAZON AST. BRGY. LOURDES, QUEZON CITY
TEL#: 0917-3290668
Email: roeltuquib@yahoo.com / robynetuquib08@gmail.com

Dear Ma'am/Sir,

Kolin Marketing Inc., is extremely honored for your endorsement of Kolin brand and we are please to offer you with a special price/s for the following items.

A. EQUIPMENT & INSTALLATION

* OPTION 1 *

QTY	U/M	MODEL / DESCRIPTION	SRP	DISCOUNTED PRICE		AMOUNT
2	UNIT/S	MODEL: KSG-IWF-30WFF-8K1M32 KOLIN WALL MOUNTED PRIMUS GOLD AIRCONDITIONER 29,500 Kj/h (3.0HP) FULL DC INVERTER W/ WIFI R-32	76,595.00	51,212.20	PHP	102,424.40
1	UNIT/S	MODEL: KSG-IWF-10WFF-8K1M32 KOLIN WALL MOUNTED PRIMUS GOLD AIRCONDITIONER 11,484 Kj/h (1.0HP) FULL DC INVERTER W/ WIFI R-32	42,595.00	25,372.20	PHP	25,372.20
TOTAL UNIT COST					PHP	127,796.60
ESTIMATED COST OF INSTALLATION (please see attached)					PHP	94,115.00
OTHERS: DELIVERY CHARGE					PHP	600.00
TOTAL ESTIMATED COST OF THE PROJECT					PHP	222,511.60

* OPTION 2 *

QTY	U/M	MODEL / DESCRIPTION	SRP	DISCOUNTED PRICE		AMOUNT
2	UNIT/S	MODEL: KSG-IWF-30WFF-8K1M32 KOLIN WALL MOUNTED PRIMUS GOLD AIRCONDITIONER 29,500 Kj/h (3.0HP) FULL DC INVERTER W/ WIFI R-32	76,595.00	51,212.20	PHP	102,424.40
1	UNIT/S	MODEL: KS-IW10-MCA1201M32 KOLIN WALL MOUNTED CERTUS AI SERIES AIRCONDITIONER 9,800 Kj/h (1.0HP) FULL DC INVERTER W/ WIFI R-32	30,995.00	17,056.20	PHP	17,056.20
TOTAL UNIT COST					PHP	119,480.60
ESTIMATED COST OF INSTALLATION (please see attached)					PHP	94,115.00
OTHERS: DELIVERY CHARGE					PHP	600.00
TOTAL ESTIMATED COST OF THE PROJECT					PHP	214,195.60

TERMS OF PAYMENT:

FULL PAYMENT OF UNIT AND DELIVERY CHARGE. IF CHECK, SUBJECT FOR 3 DAYS CLEARING.

BANK DETAILS:

* Unit/s & Delivery: Account Name - KOLIN MARKETING INC. / Account# - 011808002307 (BDO-KALAYAAN)

* Installation: Will be provided by assigned installer.

** You may settle first payment for unit/s & delivery. Installation payment can be settled directly to installer after actual works.

WARRANTY:

FOR SPLIT TYPE : ONE (1) YEAR FREE PARTS AND LABOR, THREE YEARS (3) MAIN PCB , TEN (10) YEARS WARRANTY ON COMPRESSOR.

NOTES: PRICES ARE SUBJECT TO CHANGE WITHOUT PRIOR NOTICE.

PRICES IS VAT INCLUSIVE.

** Cost of Installation is Package with the Unit(s), this cost cannot avail separately (cost will be based on actual works).

We thank you for giving opportunity to offer our product and services, hoping we receive your purchase order.

If you need assistance, don't hesitate to call the under signed at 0917-807-8607 or email at kmi_asst@kolinphil.com.ph

Very Truly Yours,

JANELLEN S. LIM
KMI-ASSISTANT

Noted By:

MARTIN KRIVEL B. FLORES
KMI-SUPERVISOR

Approved By:

MS. EDITHA M. FLORES
AVP - FINANCE

Conforme:

SIGNATURE OVER PRINTED NAME

KMI-QUOTE-11-25-0812
REG-24%/7K/6.5K

Kolin Marketing, Inc.

1854 Sta. Rita St., Guadalupe Nuevo, Makati City

Tel.: (632) 8852-6473

Fax: (632) 8852-2170 / (632) 8852-4792

www.kolinphil.com.ph / kolinphilippines



NOVEMBER 24, 2025

Roel Tuquib

148D Tuazon Ast. Brgy Lourdes, Quezon City

0917-3290668

roeltuquib@yahoo.com / robynetuquib08@gmail.com

MODEL	Qty
KSG-IWF-30Wfy8K1M32	2
KSG-IWF-10Wfy8K1M32	1

RECEPTION AREA		Area	67 sqm
----------------	--	------	--------

ACU 1	3.0 HP Wall Mounted Inverter	KSG-IWF-30Wfy8K1M32
	Estimated Pipe Length = 56 ft	
	Estimated Royal Cord Length = 61 ft	
	Initial Charge	₱ 8,500.00

Includes:

- 10ft Copper Tube
- 10ft Royal Cord
- Outdoor Bracket (Wall)
- Consumables

Installation Materials	Description	Qty	Price per qty	Subtotal
Copper Tube	Ø 1/4" x Ø 5/8"	46 ft	₱ 400.00/ft	₱ 18,400.00
Royal Cord (comm. wire)	2.mm2 x 4C	51 ft	₱ 100.00/ft	₱ 5,100.00
Royal Cord (ACCU-Breaker)	3.5mm x 3c	7 ft	₱ 60.00/ft	₱ 420.00
Circuit Breaker waterproof	30A	1 pc/s	₱ 1,000.00/pc	₱ 1,000.00
Rubber Insulation	2 1/8" x 3/4" x 6'	8 pc/s	₱ 350.00/pc	₱ 2,800.00
Full thread	3/8" x 10'	2 pc/s	₱ 150.00/pc	₱ 300.00
Metal Clamp	3"	12 pc/s	₱ 120.00/pc	₱ 1,440.00
Outdoor bracket	Fabricated floor	1 pc/s	₱ 2,500.00/pc	₱ 2,500.00
PVC blue	3/4" x 10'	3 pc/s	₱ 150.00/pc	₱ 450.00
Drain Hose	White -1/2"	7 ft	₱ 25.00/ft	₱ 175.00
				₱ 32,585.00

Estimated Charges	₱ 41,085.00
-------------------	-------------

ACU 2	3.0 HP Wall Mounted Inverter	KSG-IWF-30Wfy8K1M32
	Estimated Pipe Length = 53 ft	
	Estimated Royal Cord Length = 58 ft	
	Initial Charge	₱ 7,700.00

Includes:

- Labor
- 10ft Copper Tube
- 10ft Royal Cord
- Consumables
- Less Outdoor bracket

Installation Materials	Description	Qty	Price per qty	Subtotal
Copper Tube	Ø 1/4" x Ø 5/8"	43 ft	₱ 400.00/ft	₱ 17,200.00
Royal Cord (comm. wire)	2.mm2 x 4C	48 ft	₱ 100.00/ft	₱ 4,800.00
Royal Cord (ACCU-Breaker)	3.5mm x 3c	7 ft	₱ 60.00/ft	₱ 420.00
Circuit Breaker waterproof	30A	1 pc/s	₱ 1,000.00/pc	₱ 1,000.00
Rubber Insulation	2 1/8" x 3/4" x 6'	8 pc/s	₱ 350.00/pc	₱ 2,800.00
Full thread	3/8" x 10'	2 pc/s	₱ 150.00/pc	₱ 300.00
Metal Clamp	3"	12 pc/s	₱ 120.00/pc	₱ 1,440.00
Outdoor bracket	Fabricated wall	1 pc/s	₱ 5,000.00/pc	₱ 5,000.00
PVC blue	3/4" x 10'	3 pc/s	₱ 150.00/pc	₱ 450.00
Drain Hose	White -1/2"	7 ft	₱ 25.00/ft	₱ 175.00
				₱ 33,585.00

Estimated Charges	₱ 41,285.00
-------------------	-------------

DESIGNER ROOM

Area 10 sqm

ACU 3 1.0 HP Wall Mounted Inverter**KSG-IWF-10Wfy8K1M32**

Estimated Pipe Length = 14 ft

Estimated Royal Cord Length = 19 ft

Initial Charge

₱ 7,500.00

Includes:

Labor

10ft Copper Tube

10ft Royal Cord

Outdoor Bracket (Wall)

Consumables

Installation Materials

Description	Qty	Price per qty	Subtotal
Copper Tube	4 ft	₱ 400.00/ft	₱ 1,600.00
Royal Cord (comm. wire)	9 ft	₱ 100.00/ft	₱ 900.00
Royal Cord (ACCU-Breaker)	7 ft	₱ 60.00/ft	₱ 420.00
Circuit Breaker waterproof	20A	1 pc/s ₱ 1,000.00/pc	₱ 1,000.00
PVC blue	3/4" x 10'	1 pc/s ₱ 150.00/pc	₱ 150.00
Drain Hose	White -1/2"	7 ft ₱ 25.00/ft	₱ 175.00
			₱ 4,245.00

Estimated Charges

₱ 11,745.00

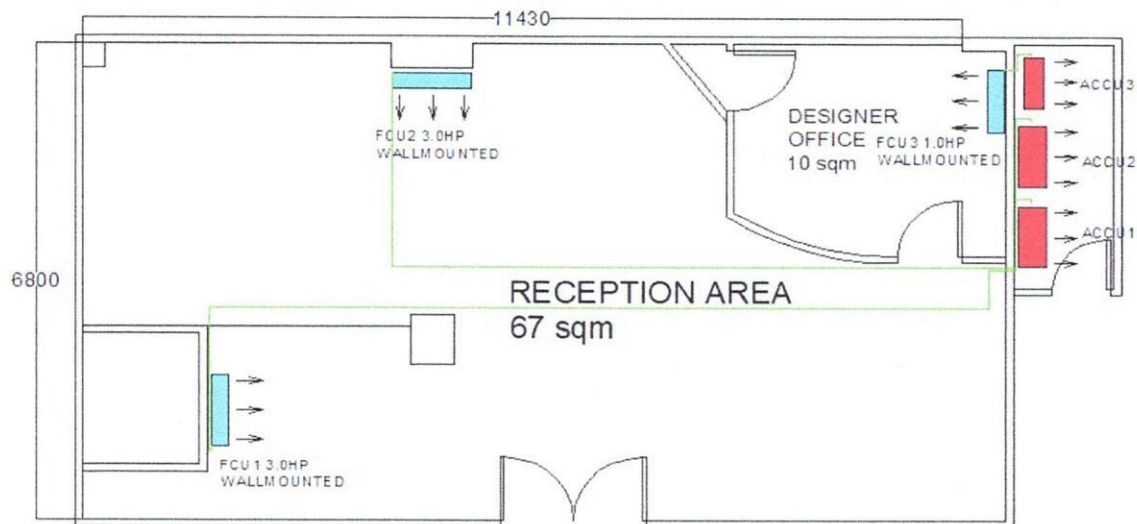

Total Estimated Charges

P 94,115.00

Validity: This quotation is valid for a period of fifteen (15) days from the date thereof, subject to our confirmation thereafter.

Installation notes:

- 1 Location of indoor and outdoor units were agreed by the customer and Kolin's surveyor.
- 2 Mechanical Plans, Permits, Electrical permits not included.
- 3 All Units Need backing for indoor. Customer contractor will chip the floor and wall for drainline.
- 4 ACU1 need wall from ceiling to lower of unit are 45cm, need also a clearance from lower of unit 30cm.
- 5 Need for site visit, and marking, for the lay out of drainline and coppertube expose coppertube in the area.
- 6 Deflectors, masonry, carpentry, chipping & plastering (finishing & restoration) are not included in the installation.
- 7 Air conditioning drain line and Electrical power supply (feeder line) 220v/ 60hz/ 1ph , should be provided by customer's contractor.
- 8 Final charges will be based on actual installation.

Prepared by:

Jeoffrey T. Dadios

Field Surveyor

Customer Conformance:

Signature Over Printed Name

Reviewed by:

Engr. Kenneth Zamora