



November 3, 2025

LOPA COMPOUND DEVELOPMENT / HOUSE #4 RAPA
LOPA FARM MARILAQUE HIWAY, SITIO MAYAGAY, BRGY. SAMPALOC TANAY RIZAL
Email: mereyes@foro.ph

Dear Ma'am/Sir,

Kolin Marketing Inc., is extremely honored for your endorsement of Kolin brand and we are please to offer you with a special price/s for the following items.

A. EQUIPMENT & INSTALLATION

QTY	U/M	MODEL / DESCRIPTION	SRP	DISCOUNTED PRICE		AMOUNT
2	UNIT/S	MODEL: KSG-IWF-25WFY-8K1M32 KOLIN WALL MOUNTED PRIMUS GOLD AIRCONDITIONER 25,560 Kj/h (2.5HP) FULL DC INVERTER W/ WIFI R-32	68,995.00	45,436.20	PHP	90,872.40
1	UNIT/S	MODEL: KA-200MCARINV32 KOLIN WINDOW TYPE CREO SERIES AIRCONDITIONER 19,800 Kj/h (2.0HP) FULL DC INVERTER R-32 WITH REMOTE (WxDxH) 26"x30.7"x16.8"	36,995.00	26,916.20	PHP	26,916.20
3	UNIT/S	MODEL: KA-150MCARINV32 KOLIN WINDOW TYPE CREO SERIES AIRCONDITIONER 12,800 Kj/h (1.5HP) FULL DC INVERTER R-32 WITH REMOTE (WxDxH) 17.7"x26.6"x13.8"	27,995.00	20,276.20	PHP	60,828.60
TOTAL UNIT COST					PHP	178,617.20
ESTIMATED COST OF INSTALLATION (please see attached)					PHP	71,620.00
TOTAL ESTIMATED COST OF THE PROJECT					PHP	250,237.20

TERMS OF PAYMENT:

FULL PAYMENT ON UNITS TO KOLIN MARKETING INC. - IF CHECK, SUBJECT FOR 3 DAYS CLEARING.
50% DOWNPAYMENT ON INSTALLATION - DIRECT TO ASSIGNED INSTALLER, REMAINING BALANCE - FOR PROGRESS BILLING.

WARRANTY:

FOR SPLIT TYPE : ONE (1) YEAR FREE PARTS AND LABOR, THREE YEARS (3) MAIN PCB , TEN (10) YEARS WARRANTY ON COMPRESSOR.
FOR WINDOW TYPE: ONE (1) YEAR FREE PARTS AND LABOR, THREE YEARS (3) MAIN PCB, TEN (10) YEARS WARRANTY ON COMPRESSOR.

NOTES: PRICES ARE SUBJECT TO CHANGE WITHOUT PRIOR NOTICE.

PRICES IS VAT INCLUSIVE.

**** Cost of Installation is Package with the Unit(s), this cost cannot avail separately (cost will be based on actual works).**

We thank you for giving opportunity to offer our product and services, hoping we receive your purchase order.

If you need assistance, don't hesitate to call the under signed at 0917-807-8607 or email at kmi_asst@kolinphil.com.ph

**** This quotation is based on provided floor plan & review notes. Installation scope of works can be found on attached survey quote.**

Very Truly Yours,

JANELLEN S. LIM
KMI-ASSISTANT

Noted by:
MART NATHANIEL R. FLORES
KMI-SUPERVISOR

Approved By:
MS. EDITHA M. FLORES
AVP - FINANCE

KMI-QUOTE-04-25-0267-rev5
DCG-24%/7K/1.2K/1K

Conforme: _____
SIGNATURE OVER PRINTED NAME

Kolin Marketing, Inc.
1854 Sta. Rita St., Guadalupe Nuevo, Makati City
Tel.: (632) 8852-6473
Fax: (632) 8852-2170 / (632) 8852-4792
www.kolinphil.com.ph / kolinphilippines



October 14, 2025

LOPA COMPOUND DEVELOPMENT/ HOUSE #4/ RAPA

Lopa Farm Marilaque Hiway Sitio Mayagay, Brgy Sampaloc Tanay Rizal

MODEL	QUANTITY
KSG-IWF-25Wfy8K1M32	2
KA-200MCARINV32	1
KA-150MCARINV32	3

REV5

GROUND FLOOR

FOYER/LIVING AREA	Area	≈ 47 sq.m
--------------------------	------	-----------

ACU 1	2.5hp Wall mounted Inverter	KSG-IWF-25Wfy8K1M32				
	Estimated Pipe Length :	50	ft			
	Estimated Royal Cord Length :	55	ft			
	Initial Charge					P 8,500.00
	Includes:					
	Labor					
	10ft Copper Tube					
	10ft Royal Cord					
	Outdoor Bracket					
	Other Consumables					
	Additional Charges	Description	Unit	Price Per Unit	Subtotal	
	Copper Tube	1/4"x 5/8"	40 ft	P 400.00 / ft	P 16,000.00	
	Royal Cord	2.mm2 x 4C	45 ft	P 100.00 / ft	P 4,500.00	
	Royal Cord (ODU-Breaker)	3.5mm2 x 3C	5 ft	P 60.00 / ft	P 300.00	
	Circuit Breaker(NEMA)	30A/ 1Ph	1 pc(s)	P 1,000.00 / pc	P 1,000.00	
	PVC(Drainline)	Blue 3/4"	3 pc(s)	P 150.00 / pc	P 450.00	
	Rubber Insulation	2 1/8"x3/4" x 6'	6 pc(s)	P 350.00 / pc	P 2,100.00	
	Full Thread	3 meters	1 pc(s)	P 150.00 / pc	P 150.00	
	Pipe hanger	3 inches	8 pc(s)	P 120.00 / pc	P 960.00	P 25,460.00

Estimated Charges	P 33,960.00
--------------------------	--------------------

ACU 2	2.5hp Wall mounted Inverter	KSG-IWF-25Wfy8K1M32				
	Estimated Pipe Length :	43	ft			
	Estimated Royal Cord Length :	48	ft			
	Initial Charge					P 8,500.00
	Includes:					
	Labor					
	10ft Copper Tube					
	10ft Royal Cord					
	Outdoor Bracket					
	Other Consumables					
	Additional Charges	Description	Unit	Price Per Unit	Subtotal	
	Copper Tube	1/4"x 5/8"	33 ft	P 400.00 / ft	P 13,200.00	
	Royal Cord	2.mm2 x 4C	38 ft	P 100.00 / ft	P 3,800.00	
	Royal Cord (ODU-Breaker)	3.5mm2 x 3C	5 ft	P 60.00 / ft	P 300.00	
	Circuit Breaker(NEMA)	30A/ 1Ph	1 pc(s)	P 1,000.00 / pc	P 1,000.00	
	PVC(Drainline)	Blue 3/4"	3 pc(s)	P 150.00 / pc	P 450.00	
	Rubber Insulation	2 1/8"x3/4" x 6'	6 pc(s)	P 350.00 / pc	P 2,100.00	
	Full Thread	3 meters	1 pc(s)	P 150.00 / pc	P 150.00	
	Pipe hanger	3 inches	8 pc(s)	P 120.00 / pc	P 960.00	P 21,960.00

Estimated Charges	P 30,460.00
--------------------------	--------------------

MASTER BEDROOM		Area	≈ 23.4 sq.m
-----------------------	--	------	-------------

ACU3 2.0hp Windowtype Inverter KA-200MCARINV32

Initial charge	P	1,200.00
Angle Bracket	P	600.00

Estimated charges	P	1,800.00
-------------------	---	----------

BEDROOM 2		Area	≈ 14 sq.m
------------------	--	------	-----------

ACU4 1.5hp Windowtype Inverter KA-150MCARINV32

Initial charge	P	1,200.00
Angle Bracket	P	600.00

Estimated charges	P	1,800.00
-------------------	---	----------

BEDROOM 1		Area	≈ 14 sq.m
------------------	--	------	-----------

ACU5 1.5hp Windowtype Inverter KA-150MCARINV32

Initial charge	P	1,200.00
Angle Bracket	P	600.00

Estimated charges	P	1,800.00
-------------------	---	----------

STUDIO		Area	≈ 13 sq.m
---------------	--	------	-----------

ACU6 1.5hp Windowtype Inverter KA-150MCARINV32

Initial charge	P	1,200.00
Angle Bracket	P	600.00

Estimated charges	P	1,800.00
-------------------	---	----------

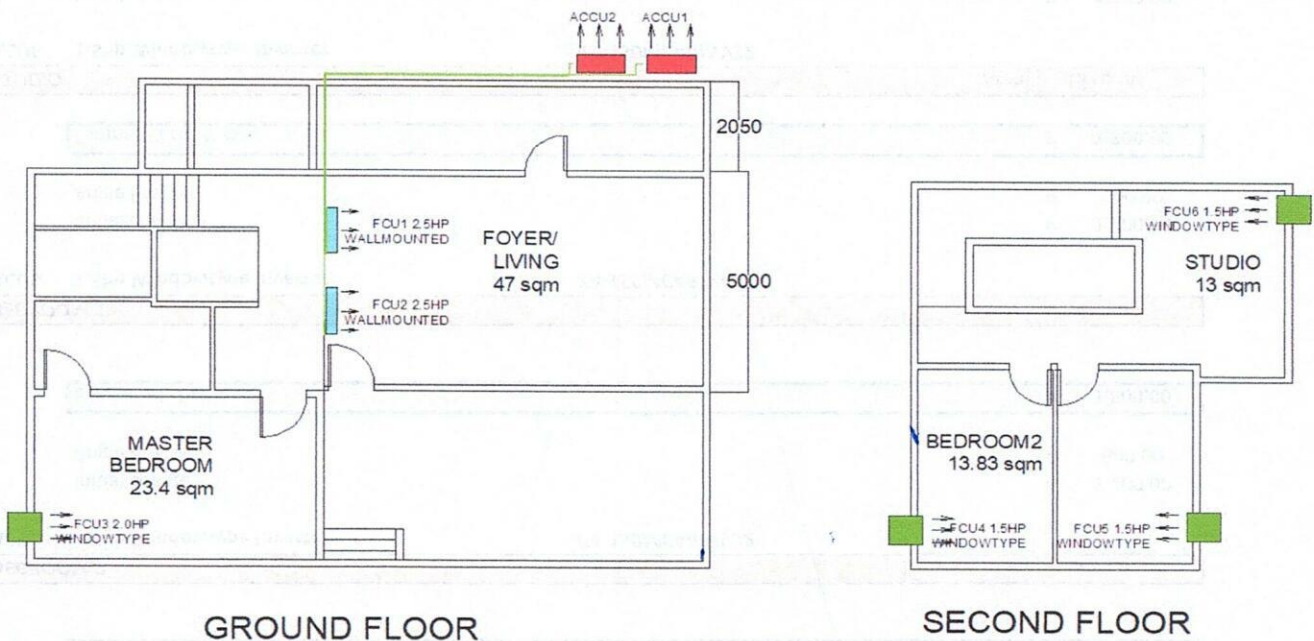

Validity: This quotation is valid for a period of fifteen (15) days from the date thereof, subject to our confirmation thereafter.

Note:

- 1 Location of indoor and outdoor units base in floor plan.
- 2 AC drain line will be tapped to the nearest drain provision provided by the customer's contractor.
- 3 Need for site visit before installation and for final location of units.
- 4 Customer need to cover the side of windowtype if unit is smaller than existing hole.
- 5 KA-150MCARINV32 Dimension: W x D x H, = 450.6 X 675 x 350 mm. (17.7 x 26.6 x 13.8 inches)
- 6 KA-200MCARINV32 Dimension: W x D x H, = 660 X 780 x 428 mm. (26 x 30.7 x 16.8 inches)
- 7 Working days: Monday to Saturday, 8am- 5pm with parking.Need working permit.
- 8 Mechanical Plans, Permits, Electrical permits not included.
- 9 Deflectors, masonry, carpentry, chipping & plastering (finishing & restoration) are not included in the installation.
- 10 Electrical power supply (feeder line) **220v/ 60hz/ 1ph** , is not included in the scope of work of Kolin.
- 11 **Final charges will be based on actual installation.**

Prepared by:

Jeffrey Dadios
Field Surveyor

Customer Conformance:

Signature Over Printed Name

Reviewed by:

Engr. Kenneth Zamora
Service Supervisor
Field and Shop Operation