



November 3, 2025

LOPA COMPOUND DEVELOPMENT / HOUSE #5 JAMIKE
LOPA FARM MARILAQUE HIWAY, SITIO MAYAGAY, BRGY. SAMPALOC TANAY RIZAL
Email: mereyes@foro.ph

Dear Ma'am/Sir,

Kolin Marketing Inc., is extremely honored for your endorsement of Kolin brand and we are please to offer you with a special price/s for the following items.

A. EQUIPMENT & INSTALLATION

QTY	U/M	MODEL / DESCRIPTION	SRP	DISCOUNTED PRICE		AMOUNT
2	UNIT/S	MODEL: KSG-IWF-25WFF-8K1M32 KOLIN WALL MOUNTED PRIMUS GOLD AIRCONDITIONER 25,560 Kj/h (2.5HP) FULL DC INVERTER W/ WIFI R-32	68,995.00	45,436.20	PHP	90,872.40
2	UNIT/S	MODEL: KA-200MCARINV32 KOLIN WINDOW TYPE CREO SERIES AIRCONDITIONER 19,800 Kj/h (2.0HP) FULL DC INVERTER R-32 WITH REMOTE (WxDxH) 26"x30.7"x16.8"	36,995.00	26,916.20	PHP	53,832.40
1	UNIT/S	MODEL: KA-150MCARINV32 KOLIN WINDOW TYPE CREO SERIES AIRCONDITIONER 12,800 Kj/h (1.5HP) FULL DC INVERTER R-32 WITH REMOTE (WxDxH) 17.7"x26.6"x13.8"	27,995.00	20,276.20	PHP	20,276.20
TOTAL UNIT COST					PHP	164,981.00
ESTIMATED COST OF INSTALLATION (please see attached)					PHP	58,140.00
OTHERS: DELIVERY CHARGE					PHP	600.00
TOTAL ESTIMATED COST OF THE PROJECT					PHP	223,721.00

TERMS OF PAYMENT:

FULL PAYMENT ON UNITS TO KOLIN MARKETING INC. - IF CHECK, SUBJECT FOR 3 DAYS CLEARING.

50% DOWNPAYMENT ON INSTALLATION - DIRECT TO ASSIGNED INSTALLER, REMAINING BALANCE - FOR PROGRESS BILLING.

WARRANTY:

FOR SPLIT TYPE : ONE (1) YEAR FREE PARTS AND LABOR, THREE YEARS (3) MAIN PCB , TEN (10) YEARS WARRANTY ON COMPRESSOR.

FOR WINDOW TYPE: ONE (1) YEAR FREE PARTS AND LABOR, THREE YEARS (3) MAIN PCB, TEN (10) YEARS WARRANTY ON COMPRESSOR.

NOTES: PRICES ARE SUBJECT TO CHANGE WITHOUT PRIOR NOTICE.

PRICES IS VAT INCLUSIVE.

**** Cost of Installation is Package with the Unit(s), this cost cannot avail separately (cost will be based on actual works).**

We thank you for giving opportunity to offer our product and services, hoping we receive your purchase order.

If you need assistance, don't hesitate to call the under signed at 0917-807-8607 or email at kmi_asst@kolinphil.com.ph

**** This quotation is based on provided floor plan & review notes. Installation scope of works can be found on attached survey quote.**

Very Truly Yours,

JANELLEN S. LIM
KMI-ASSISTANT

Noted by;

MART NATHANIEL R. FLORES
KMI-SUPERVISOR

Approved By:

MS. EDITHA M. FLORES
AVP - FINANCE

KMI-QUOTE-04-25-0268-rev3
DCG-24%/7K/1.2K/1K

Conforme:

SIGNATURE OVER PRINTED NAME

Kolin Marketing, Inc.

1854 Sta. Rita St., Guadalupe Nuevo, Makati City

Tel.: (632) 8852-6473

Fax: (632) 8852-2170 / (632) 8852-4792

www.kolinphil.com.ph / kolinphilippines

June 4, 2025

LOPA COMPOUND DEVELOPMENT/ HOUSE #5/ JAMIKE

Lopa Farm Marilaque Hiway Sitio Mayagay, Brgy Sampaloc Tanay Rizal

MODEL	QUANTITY
KSG-IWF-25WY8K1M32	2
KA-200MCARINV32	2
KA-150MCARINV32	1

REV3

GROUND FLOOR

FOYER/LIVING AREA	Area ≈ 47 sq.m
-------------------	----------------

ACU 1	2.5hp Wall mounted Inverter	KSG-IWF-25WY8K1M32				
	Estimated Pipe Length :	33	ft			
	Estimated Royal Cord Length :	38	ft			
	Initial Charge				P	8,500.00
	Includes:					
	Labor					
	10ft Copper Tube					
	10ft Royal Cord					
	Outdoor Bracket					
	Other Consumables					
	Additional Charges	Description	Unit	Price Per Unit	Subtotal	
	Copper Tube	1/4"x 5/8"	23 ft	P 400.00 / ft	P 9,200.00	
	Royal Cord	2.mm2 x 4C	28 ft	P 100.00 / ft	P 2,800.00	
	Royal Cord (ODU-Breaker)	3.5mm2 x 3C	7 ft	P 60.00 / ft	P 420.00	
	Circuit Breaker(NEMA)	30A/ 1Ph	1 pc(s)	P 1,000.00 / pc	P 1,000.00	
	PVC(Drainline)	Blue 3/4"	2 pc(s)	P 150.00 / pc	P 300.00	
	Rubber Insulation	2 1/8"x3/4" x 6'	5 pc(s)	P 350.00 / pc	P 1,750.00	
	Full Thread	3 meters	1 pc(s)	P 150.00 / pc	P 150.00	
	Pipe hanger	3 inches	7 pc(s)	P 120.00 / pc	P 840.00	P 16,460.00

Estimated Charges	P 24,960.00
--------------------------	--------------------

ACU 2	2.5hp Wall mounted Inverter	KSG-IWF-25WY8K1M32				
	Estimated Pipe Length :	37	ft			
	Estimated Royal Cord Length :	42	ft			
	Initial Charge				P	8,500.00
	Includes:					
	Labor					
	10ft Copper Tube					
	10ft Royal Cord					
	Outdoor Bracket					
	Other Consumables					
	Additional Charges	Description	Unit	Price Per Unit	Subtotal	
	Copper Tube	1/4"x 5/8"	27 ft	P 400.00 / ft	P 10,800.00	
	Royal Cord	2.mm2 x 4C	32 ft	P 100.00 / ft	P 3,200.00	
	Royal Cord (ODU-Breaker)	3.5mm2 x 3C	5 ft	P 60.00 / ft	P 300.00	
	Circuit Breaker(NEMA)	30A/ 1Ph	1 pc(s)	P 1,000.00 / pc	P 1,000.00	
	PVC(Drainline)	Blue 3/4"	2 pc(s)	P 150.00 / pc	P 300.00	
	Rubber Insulation	2 1/8"x3/4" x 6'	7 pc(s)	P 350.00 / pc	P 2,450.00	
	Full Thread	3 meters	1 pc(s)	P 150.00 / pc	P 150.00	
	Pipe hanger	3 inches	9 pc(s)	P 120.00 / pc	P 1,080.00	P 19,280.00

Estimated Charges	P 27,780.00
--------------------------	--------------------

BEDROOM 1	Area ≈ 18.4 sq.m
-----------	------------------

ACU3	1.5hp Windowtype Inverter	KA-150MCARINV32				
	Initial charge				P	1,200.00
	Angle Bracket				P	600.00
	Estimated charges				P	1,800.00

MASTER BEDROOM	Area ≈ 21 sq.m
----------------	----------------

ACU4	2.0hp Windowtype Inverter	KA-200MCARINV32				
	Initial charge				P	1,200.00
	Angle Bracket				P	600.00
	Estimated charges				P	1,800.00

GUESTROOM		Area ≈ 20.1 sq.m
------------------	--	------------------

ACU5 2.0hp Windowtype Inverter KA-200MCARINV32

Initial charge P 1,200.00
Angle Bracket P 600.00

Estimated charges P 1,800.00

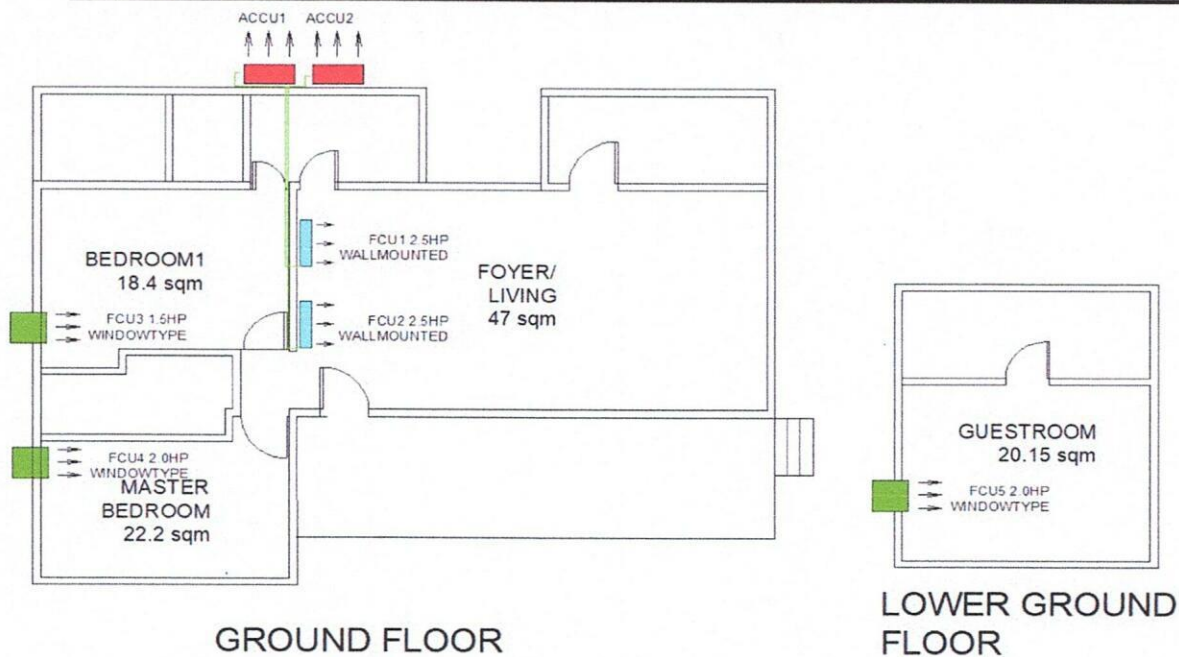

Total Estimated Charges P 58,140.00

Validity: This quotation is valid for a period of fifteen (15) days from the date thereof, subject to our confirmation thereafter.

Note:

- 1 Location of indoor and outdoor units base in floor plan.
- 2 AC drain line will be tapped to the nearest drain provision provided by the customer's contractor.
- 3 Need for site visit before installation and for final location of units.
- 4 Customer need to cover the side of windowtype if unit is smaller than existing hole.
- 5 KA-150MCARINV32 Dimension: W x D x H, = 450.6 X 675 x 350 mm. (17.7 x 26.6 x 13.8 inches)
- 6 KA-200MCARINV32 Dimension: W x D x H, = 660 X 780 x 428 mm. (26 x 30.7 x 16.8 inches)
- 7 Working days: Monday to Saturday, 8am- 5pm with parking. Need working permit.
- 8 Mechanical Plans, Permits, Electrical permits not included.
- 9 Deflectors, masonry, carpentry, chipping & plastering (finishing & restoration) are not included in the installation.
- 10 Electrical power supply (feeder line) **220v/ 60hz/ 1ph** , is not included in the scope of work of Kolin.
- 11 Final charges will be based on actual installation.

Prepared by:

Jeffrey Dadios
Field Surveyor

Customer Conformer:

Signature Over Printed Name

Reviewed by:

Engr. Kenneth Zamora
Service Supervisor
Field and Shop Operation