



October 14, 2025

LOPA COMPOUND DEVELOPMENT / HOUSE #6 JOEL  
LOPA FARM MARILAQUE HIWAY, SITIO MAYAGAY, BRGY. SAMPALOC TANAY RIZAL  
Email: mereyes@foro.ph

Dear Ma'am/Sir,

Kolin Marketing Inc., is extremely honored for your endorsement of Kolin brand and we are please to offer you with a special price/s for the following items.

A. EQUIPMENT & INSTALLATION

QTY	U/M	MODEL / DESCRIPTION	SRP	DISCOUNTED PRICE		AMOUNT
2	UNIT/S	MODEL: KSG-IWF-25WYF-8KIM32 KOLIN WALL MOUNTED PRIMUS GOLD AIRCONDITIONER 25,560 Kj/h (2.5HP) FULL DC INVERTER W/ WIFI R-32	68,995.00	45,436.20	PHP	90,872.40
1	UNIT/S	MODEL: KA-200MCARINV32 KOLIN WINDOW TYPE CREO SERIES AIRCONDITIONER 19,800 Kj/h (2.0HP) FULL DC INVERTER R-32 WITH REMOTE (WxDxH) 26"x30.7"x16.8"	36,995.00	26,916.20	PHP	26,916.20
2	UNIT/S	MODEL: KA-150MCARINV32 KOLIN WINDOW TYPE CREO SERIES AIRCONDITIONER 12,800 Kj/h (1.5HP) FULL DC INVERTER R-32 WITH REMOTE (WxDxH) 17.7"x26.6"x13.8"	27,995.00	20,276.20	PHP	40,552.40
TOTAL UNIT COST					PHP	158,341.00
ESTIMATED COST OF INSTALLATION (please see attached)					PHP	50,030.00
TOTAL ESTIMATED COST OF THE PROJECT					PHP	208,371.00

TERMS OF PAYMENT:

FULL PAYMENT ON UNITS TO KOLIN MARKETING INC. - IF CHECK, SUBJECT FOR 3 DAYS CLEARING.

50% DOWNPAYMENT ON INSTALLATION - DIRECT TO ASSIGNED INSTALLER, REMAINING BALANCE - FOR PROGRESS BILLING.

WARRANTY:

FOR SPLIT TYPE : ONE (1) YEAR FREE PARTS AND LABOR, THREE YEARS (3) MAIN PCB, TEN (10) YEARS WARRANTY ON COMPRESSOR.

FOR WINDOW TYPE: ONE (1) YEAR FREE PARTS AND LABOR, THREE YEARS (3) MAIN PCB, TEN (10) YEARS WARRANTY ON COMPRESSOR.

NOTES: PRICES ARE SUBJECT TO CHANGE WITHOUT PRIOR NOTICE.

PRICES IS VAT INCLUSIVE.

**\*\* Cost of Installation is Package with the Unit(s), this cost cannot avail separately (cost will be based on actual works).**

We thank you for giving opportunity to offer our product and services, hoping we receive your purchase order.

If you need assistance, don't hesitate to call the under signed at 0917-807-8607 or email at kmi\_asst@kolinphil.com.ph

**\*\* This quotation is based on provided floor plan & review notes. Installation scope of works can be found on attached survey quote.**

Very Truly Yours,

JANELLEN S. LIM  
KMI-ASSISTANT

Noted by:

MART NATHANIEL R. FLORES  
KMI-SUPERVISOR

Approved By:

MS. EDITHA M. FLORES  
AVP - FINANCE

KMI-QUOTE-04-25-0269-rev4  
DCG-24%/7K/1.2K/1K

Conforme:

SIGNATURE OVER PRINTED NAME

Kolin Marketing, Inc.

1854 Sta. Rita St., Guadalupe Nuevo, Makati City

Tel.: (632) 8852-6473

Fax: (632) 8852-2170 / (632) 8852-4792

www.kolinphil.com.ph / kolinphilippines

October 14, 2025

**LOPA COMPOUND DEVELOPMENT/ HOUSE #6 JOEL**

Lopa Farm Marilague Hiway Sitio Mayagay, Brgy Sampaloc Tanay Rizal

MODEL	QUANTITY
KSG-IWF-25Wfy8K1M32	2
KA-200MCARINV32	1
KA-150CARINV32	2

REV4

**GROUND FLOOR**

<b>FOYER/LIVING AREA</b>	Area ≈ 57 sq.m
--------------------------	----------------

<b>ACU 1</b>	<b>2.5hp Wall mounted Inverter</b>	<b>KSG-IWF-25Wfy8K1M32</b>	
	Estimated Pipe Length :	33	ft
	Estimated Royal Cord Length :	38	ft
	Initial Charge		P 8,500.00

Includes:

- Labor
- 10ft Copper Tube
- 10ft Royal Cord
- Outdoor Bracket
- Other Consumables

Additional Charges	Description	Unit	Price Per Unit	Subtotal
Copper Tube	1/4"x 5/8"	23 ft	P 400.00 / ft	P 9,200.00
Royal Cord	2.mm2 x 4C	28 ft	P 100.00 / ft	P 2,800.00
Royal Cord (ODU-Breaker)	3.5mm2 x 3C	5 ft	P 60.00 / ft	P 300.00
Circuit Breaker(NEMA)	30A/ 1Ph	1 pc(s)	P 1,000.00 / pc	P 1,000.00
PVC(Drainline)	Blue 3/4"	3 pc(s)	P 150.00 / pc	P 450.00
Rubber Insulation	2 1/8"x3/4" x 6'	5 pc(s)	P 350.00 / pc	P 1,750.00
Full Thread	3 meters	1 pc(s)	P 150.00 / pc	P 150.00
Pipe hanger	3 inches	8 pc(s)	P 120.00 / pc	P 960.00
				P 16,610.00

<b>Estimated Charges</b>	<b>P 25,110.00</b>
--------------------------	--------------------

<b>ACU 2</b>	<b>2.5hp Wall mounted Inverter</b>	<b>KSG-IWF-25Wfy8K1M32</b>	
	Estimated Pipe Length :	23	ft
	Estimated Royal Cord Length :	28	ft
	Initial Charge		P 8,500.00

Includes:

- Labor
- 10ft Copper Tube
- 10ft Royal Cord
- Outdoor Bracket
- Other Consumables

Additional Charges	Description	Unit	Price Per Unit	Subtotal
Copper Tube	1/4"x 5/8"	13 ft	P 400.00 / ft	P 5,200.00
Royal Cord	2.mm2 x 4C	18 ft	P 100.00 / ft	P 1,800.00
Royal Cord (ODU-Breaker)	3.5mm2 x 3C	5 ft	P 60.00 / ft	P 300.00
Circuit Breaker(NEMA)	30A/ 1Ph	1 pc(s)	P 1,000.00 / pc	P 1,000.00
PVC(Drainline)	Blue 3/4"	3 pc(s)	P 150.00 / pc	P 450.00
Rubber Insulation	2 1/8"x3/4" x 6'	4 pc(s)	P 350.00 / pc	P 1,400.00
Full Thread	3 meters	1 pc(s)	P 150.00 / pc	P 150.00
Pipe hanger	3 inches	6 pc(s)	P 120.00 / pc	P 720.00
				P 11,020.00

<b>Estimated Charges</b>	<b>P 19,520.00</b>
--------------------------	--------------------

<b>MASTER BEDROOM</b>	Area ≈ 23.4 sq.m
-----------------------	------------------

<b>ACU3</b>	<b>2.0hp Windowtype Inverter</b>	<b>KA-200MCARINV32</b>	
	Initial charge		P 1,200.00
	Angle Bracket		P 600.00

<b>Estimated charges</b>	<b>P 1,800.00</b>
--------------------------	-------------------



<b>BEDROOM 2</b>	Area ≈ 14 sq.m
------------------	----------------

ACU4 1.5hp Windowtype Inverter KA-150MCARINV32

Initial charge	P	1,200.00
Angle Bracket	P	600.00

Estimated charges	P	1,800.00
-------------------	---	----------

<b>BEDROOM 1</b>	Area ≈ 14 sq.m
------------------	----------------

ACU5 1.5hp Windowtype Inverter KA-150MCARINV32

Initial charge	P	1,200.00
Angle Bracket	P	600.00

Estimated charges	P	1,800.00
-------------------	---	----------

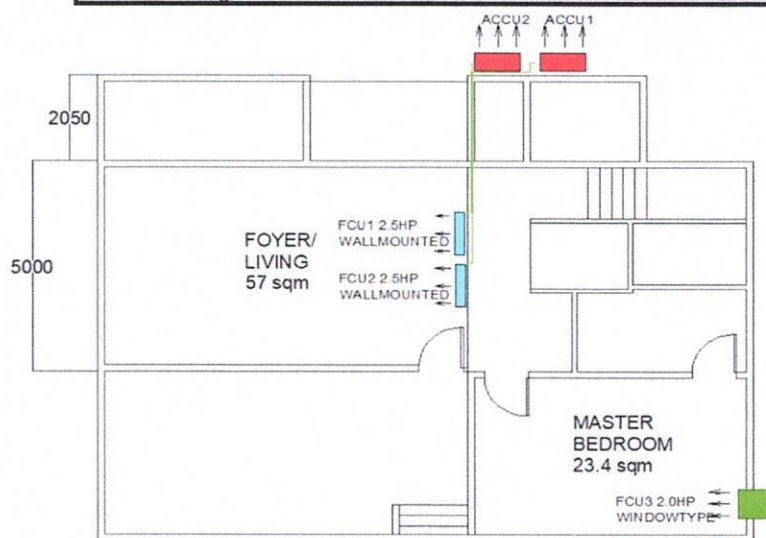

GROUND FLOOR

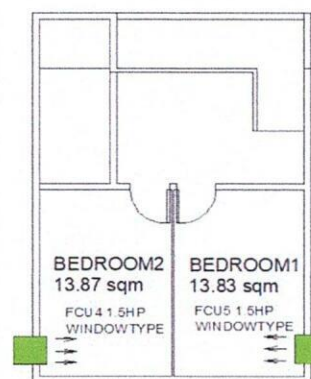

SECOND FLOOR

<b>Total Estimated Charges</b>	P	50,030.00
--------------------------------	---	-----------

Validity: This quotation is valid for a period of fifteen (15) days from the date thereof, subject to our confirmation thereafter.

**Note:**

- 1 Location of indoor and outdoor units base in floor plan.
- 2 AC drain line will be tapped to the nearest drain provision provided by the customer's contractor.
- 3 Need for site visit before installation and for final location of units.
- 4 Customer need to cover the side of windowtype if unit is smaller than existing hole.
- 5 KA-150MCARINV32 Dimension: W x D x H, = 450.6 X 675 x 350 mm. (17.7 x 26.6 x 13.8 inches)
- 6 KA-200MCARINV32 Dimension: W x D x H, = 660 X 780 x 428 mm. (26 x 30.7 x 16.8 inches)
- 7 Working days: Monday to Saturday, 8am- 5pm with parking. Need working permit.
- 8 Mechanical Plans, Permits, Electrical permits not included.
- 9 Deflectors, masonry, carpentry, chipping & plastering (finishing & restoration) are not included in the installation.
- 10 Electrical power supply (feeder line) 220v/ 60hz/ 1ph , is not included in the scope of work of Kolin.
- 11 Final charges will be based on actual installation.

Prepared by:

**Jeffrey Dadios**

Field Surveyor

Customer Conformer:

\_\_\_\_\_  
Signature Over Printed Name

Reviewed by:

**Engr. Kenneth Zamora**

Service Supervisor

Field and Shop Operation