



October 20, 2025

ATTN: MR. MALVIN VILLAPANDO  
U-1216, THE ASTON PLACE CONDO, DOMINGA ST. BRGY 45, PASAY CITY  
TEL#: 0926-612-9591

Dear Ma'am/Sir,

Kolin Marketing Inc., is extremely honored for your endorsement of Kolin brand and we are please to offer you with a special price/s for the following items.

A. EQUIPMENT & INSTALLATION

\* OPTION 1 \*

QTY	U/M	MODEL / DESCRIPTION	SRP	DISCOUNTED PRICE		AMOUNT
1	UNIT/S	MODEL: KSG-IWF-20WFF-8K1M32 KOLIN WALL MOUNTED PRIMUS GOLD AIRCONDITIONER 19,000 Kj/h (2.0HP) FULL DC INVERTER W/ WIFI R-32	59,595.00	38,292.20	PHP	38,292.20
2	UNIT/S	MODEL: KAG-100WCINV KOLIN WINDOW TYPE QUAD SERIES AIRCONDITIONER 10,200 Kj/h (1.0HP) FULL DC INVERTER W/ WIFI R-32 (WxDxH) 18"x25"x14"	28,995.00	20,736.20	PHP	41,472.40
TOTAL UNIT COST					PHP	79,764.60
ESTIMATED COST OF INSTALLATION (please see attached)					PHP	29,120.00
OTHERS: DELIVERY CHARGE					PHP	600.00
TOTAL UNIT COST					PHP	109,484.60

\* OPTION 2 \*

QTY	U/M	MODEL / DESCRIPTION	SRP	DISCOUNTED PRICE		AMOUNT
1	UNIT/S	MODEL: KS-IW20-MCAI1201M32 KOLIN WALL MOUNTED CERTUS A/ SERIES AIRCONDITIONER 19,000 Kj/h (2.0HP) FULL DC INVERTER W/ WIFI R-32	42,995.00	28,676.20	PHP	28,676.20
2	UNIT/S	MODEL: KA-100MCARINV32 KOLIN WINDOW TYPE CREO SERIES AIRCONDITIONER 9,700 Kj/h (1.0HP) FULL DC INVERTER R-32 WITH REMOTE (WxDxH) 17.7"x26.6"x13.8"	24,995.00	18,196.20	PHP	36,392.40
TOTAL UNIT COST					PHP	65,068.60
ESTIMATED COST OF INSTALLATION (please see attached)					PHP	29,120.00
OTHERS: DELIVERY CHARGE					PHP	600.00
TOTAL UNIT COST					PHP	94,788.60

TERMS OF PAYMENT:

FULL PAYMENT OF UNIT AND DELIVERY CHARGE. IF CHECK, SUBJECT FOR 3 DAYS CLEARING.

WARRANTY:

FOR SPLIT TYPE : ONE (1) YEAR FREE PARTS AND LABOR, THREE YEARS (3) MAIN PCB , TEN (10) YEARS WARRANTY ON COMPRESSOR.  
FOR WINDOW TYPE: ONE (1) YEAR FREE PARTS AND LABOR, THREE YEARS (3) MAIN PCB, TEN (10) YEARS WARRANTY ON COMPRESSOR.

NOTES: PRICES ARE SUBJECT TO CHANGE WITHOUT PRIOR NOTICE.

PRICES IS VAT INCLUSIVE.

We thank you for giving opportunity to offer our product and services, hoping we receive your purchase order.

If you need assistance, don't hesitate to call the under signed at 0917-807-8607 or email at kmi\_asst@kolinphil.com.ph

Very Truly Yours,

JANELLEN S. LIM  
KMI ASSISTANT

Noted by:

MARTIN MANUEL R. FLORES  
KMI-SUPERVISOR

Approved By:

MS. EDITHA M. FLORES  
AVP - FINANCE

Conforme:

SIGNATURE OVER PRINTED NAME

KMI-QUOTE-10-25-0755  
EMF-24%/7K/1.3K/4K/800

Kolin Marketing, Inc.  
1854 Sta. Rita St., Guadalupe Nuevo, Makati City  
Tel.: (632) 8852-6473  
Fax: (632) 8852-2170 / (632) 8852-4792  
www.kolinphil.com.ph / kolinphilippines



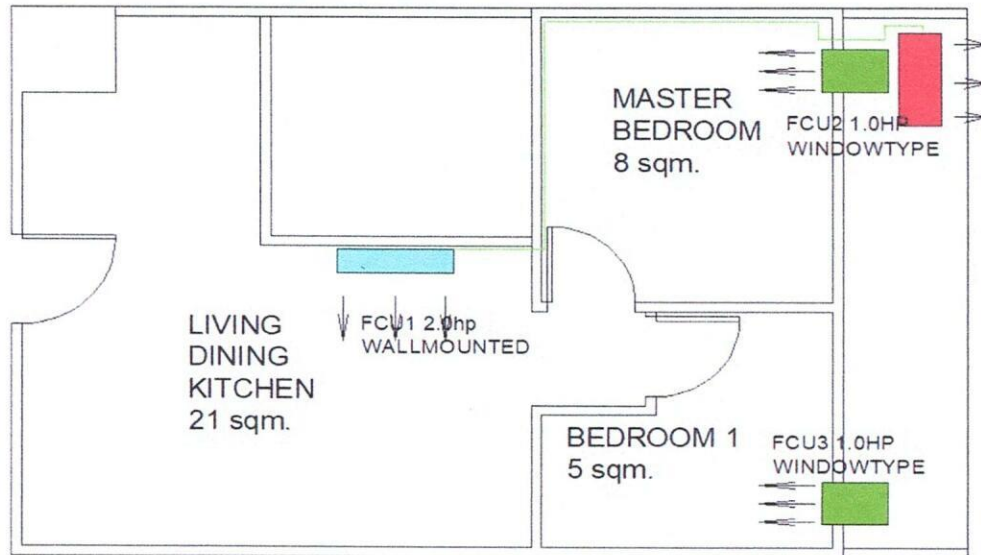

<b>Total Estimated Charges</b>	<b>P 29,120.00</b>
--------------------------------	--------------------

**Validity:** This quotation is valid for a period of fifteen (15) days from the date thereof, subject to our confirmation thereafter.

**Note:**

- 1 Location of indoor and outdoor units were agreed by the customer and Kolin's surveyor.
- 2 **KAG-100WCINV Dimension: W x D x H, = 450 X 640 x 350 mm. (18 x 25 x 14 inches)**
- 3 AC drain line will be tapped to the nearest drain provision provided by the customer's contractor.
- 4 Expose coppertube in the area.
- 5 Working days: Monday to Saturday, 8am- 5pm with parking for confirmation. Need working permit.
- 6 Mechanical Plans, Permits, Electrical permits not included.
- 7 Deflectors, masonry, carpentry, chipping & plastering (finishing & restoration) are not included in the installation.
- 8 Electrical power supply (feeder line) **220v/ 60hz/ 1ph** , is not included in the scope of work of Kolin.
- 9 **Final charges will be based on actual installation.**

Prepared by:

Jeffrey Dadios

Field Surveyor

Customer Conformance:

\_\_\_\_\_  
Signature Over Printed Name

Reviewed by:

Engr. Kenneth Zamora

Service Supervisor

Field and Shop Operation

October 20, 2025

Malvin Villapando

Unit 1216, The Aston Place Condo, Dominga St. Brgy 45, Pasay City

[0926-6129591](tel:0926-6129591)

Model	Qty
KSG-IWF-20Wfy-8K1M32	1
KAG-100WCINV	2

<b>LIVING, DINING, KITCHEN</b>	Area ≈ 21 sq.m
--------------------------------	----------------

**ACU 1 2.0hp Wallmounted Inverter** *KSG-IWF-20Wfy-8K1M32*

Estimated Pipe Length : 43 ft

Estimated Royal Cord Length : 48 ft

Initial Charge P 7,500.00

Includes:

Labor  
10ft Copper Tube  
10ft Royal Cord  
Outdoor Bracket (FLOOR)  
Other Consumables

Additional Charges	Description	Unit	Price Per Unit	Subtotal
Copper Tube	1/4"x 1/2"	33 ft	P 350.00 / ft	P 11,550.00
Royal Cord	2.mm2 x 4C	38 ft	P 100.00 / ft	P 3,800.00
Royal Cord (ODU-Breaker)	3.5mm2 x 3C	7 ft	P 60.00 / ft	P 420.00
Circuit Breaker(NEMA)	20A/ 1Ph	1 pc(s)	P 1,000.00 / pc	P 1,000.00
Rubber Insulation	2 1/8"x3/4" x 6'	6 pc(s)	P 350.00 / pc	P 2,100.00
				P 18,870.00

<b>Estimated Charges</b>	<b>P 26,370.00</b>
--------------------------	--------------------

<b>MASTER BEDROOM</b>	Area ≈ 8 sq.m
-----------------------	---------------

**ACU2 1.0hp Windowtype Inverter** *KAG-100WCINV*

Initial charge P 1,200.00

Drain Hose White -1/2" 7 ft P 25.00 / ft P 175.00 P 175.00

<b>Estimated charges</b>	<b>P 1,375.00</b>
--------------------------	-------------------

<b>BEDROOM 1</b>	Area ≈ 5 sq.m
------------------	---------------

**ACU3 1.0hp Windowtype Inverter** *KAG-100WCINV*

Initial charge P 1,200.00

Drain Hose White -1/2" 7 ft P 25.00 / ft P 175.00 P 175.00

<b>Estimated charges</b>	<b>P 1,375.00</b>
--------------------------	-------------------