

MR. RICHMOND JIMENEZ
938 QUIRINO AVE. BRGY DON GALO, PARAÑAQUE CITY
Email: rlozanojimenez@gmail.com
TEL#: 0917-8427460

Dear Ma'am/Sir,

Kolin Marketing Inc., is extremely honored for your endorsement of Kolin brand and we are please to offer you with a special price/s for the following items.

A. EQUIPMENT & INSTALLATION

* OPTION 1 *

QTY	U/M	MODEL / DESCRIPTION	SRP	DISCOUNTED PRICE		AMOUNT
1	UNIT/S	MODEL: KSG-IWF-30WFF-8KIM32 KOLIN WALL MOUNTED PRIMUS GOLD AIRCONDITIONER 29,500 Kj/h (3.0HP) FULL DC INVERTER W/ WIFI R-32	76,595.00	51,212.20	PHP	51,212.20
2	UNIT/S	MODEL: KSM-IW20-WCT10M1M32 KOLIN WALL MOUNTED CERTUS SERIES AIRCONDITIONER 18,990 Kj/h (2.0HP) REGULAR INVERTER W/ WIFI R-32	41,995.00	27,916.20	PHP	55,832.40
TOTAL UNIT COST					PHP	107,044.60
ESTIMATED COST OF INSTALLATION (please see attached)					PHP	74,520.00
OTHERS: DELIVERY CHARGE					PHP	600.00
TOTAL ESTIMATED COST OF THE PROJECT					PHP	182,164.60

* OPTION 2 *

QTY	U/M	MODEL / DESCRIPTION	SRP	DISCOUNTED PRICE		AMOUNT
1	UNIT/S	MODEL: KSG-IWF-30WFF-8KIM32 KOLIN WALL MOUNTED PRIMUS GOLD AIRCONDITIONER 29,500 Kj/h (3.0HP) FULL DC INVERTER W/ WIFI R-32	76,595.00	51,212.20	PHP	51,212.20
2	UNIT/S	MODEL: KSG-IWF-20WFF-8KIM32 KOLIN WALL MOUNTED PRIMUS GOLD AIRCONDITIONER 19,000 Kj/h (2.0HP) FULL DC INVERTER W/ WIFI R-32	59,595.00	38,292.20	PHP	76,584.40
TOTAL UNIT COST					PHP	127,796.60
ESTIMATED COST OF INSTALLATION (please see attached)					PHP	74,520.00
OTHERS: DELIVERY CHARGE					PHP	600.00
TOTAL ESTIMATED COST OF THE PROJECT					PHP	202,916.60

TERMS OF PAYMENT:

FULL PAYMENT OF UNIT AND DELIVERY CHARGE. IF CHECK, SUBJECT FOR 3 DAYS CLEARING.

WARRANTY:

FOR SPLIT TYPE : ONE (1) YEAR FREE PARTS AND LABOR, THREE YEARS (3) MAIN PCB , TEN (10) YEARS WARRANTY ON COMPRESSOR.

NOTES: PRICES ARE SUBJECT TO CHANGE WITHOUT PRIOR NOTICE.

PRICES IS VAT INCLUSIVE.

** Cost of Installation is Package with the Unit(s), this cost cannot avail separately (cost will be based on actual works).

*** You may settle first payment for unit/s & delivery. Installation payment can be settled directly to installer after actual works.

We thank you for giving opportunity to offer our product and services, hoping we receive your purchase order.

If you need assistance, don't hesitate to call the under signed at 0917-807-8607 or email at kmi_asst@kolinphil.com.ph

Very Truly Yours,

JANELLEN S. LIM
KMI-ASSISTANT

Noted by:

MART MATTHEW R. FLORES
KMI-SUPERVISOR

Approved By:

MS. EDITHA M. FLORES
AVP - FINANCE

Conforme:

SIGNATURE OVER PRINTED NAME

KMI-QUOTE-09-25-0648
REG-24%/4K/7K

Kolin Marketing, Inc.

1854 Sta. Rita St., Guadalupe Nuevo, Makati City

Tel.: (632) 8852-6473

Fax: (632) 8852-2170 / (632) 8852-4792

www.kolinphil.com.ph / kolinphilippines



September 1, 2025
 RICHMOND JIMENEZ
 938 Quirino Ave. Brgy Dongalo Paranaque City
 0917-8427460
rlozanojimenez@gmail.com

MODEL	Qty
KSG-IWF-30Wfy8K1M32	1
KSM-IW20-WCT10M1M32	2

LIVING,DINING,KITCHEN	Area	32 sqm
------------------------------	------	--------

ACU 1	3.0 HP Wall Mounted Inverter	KSG-IWF-30Wfy8K1M32			
	Estimated Pipe Length =	50 ft			
	Estimated Royal Cord Length =	55 ft			
	Initial Charge				₱ 8,500.00
	Includes:				
	Labor				
	10ft Copper Tube				
	10ft Royal Cord				
	Outdoor Bracket (Wall)				
	Consumables				
	Installation Materials	Description	Qty	Price per qty	Subtotal
	Copper Tube	Ø 1/4" x Ø 5/8"	40 ft	₱ 400.00/ft	₱ 16,000.00
	Royal Cord (comm. wire)	2.mm2 x 4C	45 ft	₱ 100.00/ft	₱ 4,500.00
	Royal Cord (ACCU-Breaker)	3.5mm x 3c	5 ft	₱ 60.00/ft	₱ 300.00
	Circuit Breaker waterproof	30A / 1Ph	1 pc/s	₱ 1,000.00/pc	₱ 1,000.00
	Rubber Insulation	2 1/8" x 3/4" x 6'	3 pc/s	₱ 350.00/pc	₱ 1,050.00
	Full thread	3/8" x 10'	2 pc/s	₱ 150.00/pc	₱ 300.00
	Metal Clamp	3"	6 pc/s	₱ 120.00/pc	₱ 720.00
	PVC blue	3/4" x 10'	2 pc/s	₱ 150.00/pc	₱ 300.00
					₱ 24,170.00
	Estimated Charges				₱ 32,670.00

BEDROOM	Area	47 sqm
----------------	------	--------

ACU 2	2.0 HP Wall Mounted Inverter	KSM-IW20-WCT10M1M32			
	Estimated Pipe Length =	37 ft			
	Estimated Royal Cord Length =	42 ft			
	Initial Charge				₱ 7,500.00
	Includes:				
	Labor				
	10ft Copper Tube				
	10ft Royal Cord				
	Outdoor Bracket (Wall)				
	Consumables				
	Installation Materials	Description	Qty	Price per qty	Subtotal
	Copper Tube	Ø 1/4" x Ø 1/2"	27 ft	₱ 350.00/ft	₱ 9,450.00
	Royal Cord (comm. wire)	2.mm2 x 4C	32 ft	₱ 100.00/ft	₱ 3,200.00
	Royal Cord (ACCU-Breaker)	3.5mm x 3c	5 ft	₱ 60.00/ft	₱ 300.00
	Circuit Breaker waterproof	30A / 1Ph	1 pc/s	₱ 1,000.00/pc	₱ 1,000.00
	PVC blue	3/4" x 10'	3 pc/s	₱ 150.00/pc	₱ 450.00
					₱ 14,400.00
	Estimated Charges				₱ 21,900.00

ACU 3 2.0 HP Wall Mounted Inverter**KSM-IW20-WCT10M1M32**

Estimated Pipe Length = 33 ft

Estimated Royal Cord Length = 38 ft

Initial Charge

₱ 7,500.00

Includes:

Labor

10ft Copper Tube

10ft Royal Cord

Outdoor Bracket (Wall)

Consumables

Installation Materials

Description	Qty	Price per qty	Subtotal
Copper Tube $\varnothing 1/4" \times \varnothing 1/2"$	23 ft	₱ 350.00/ft	₱ 8,050.00
Royal Cord (comm. wire) 2.mm2 x 4C	28 ft	₱ 100.00/ft	₱ 2,800.00
Royal Cord (ACCU-Breaker) 3.5mm x 3c	5 ft	₱ 60.00/ft	₱ 300.00
Circuit Breaker waterproof 30A / 1Ph	1 pc/s	₱ 1,000.00/pc	₱ 1,000.00
PVC blue 3/4" x 10'	2 pc/s	₱ 150.00/pc	₱ 300.00
			₱ 12,450.00

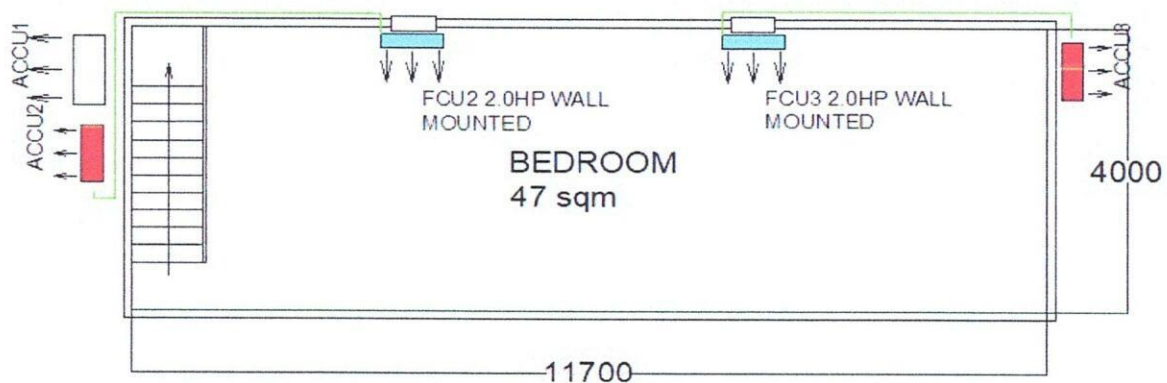
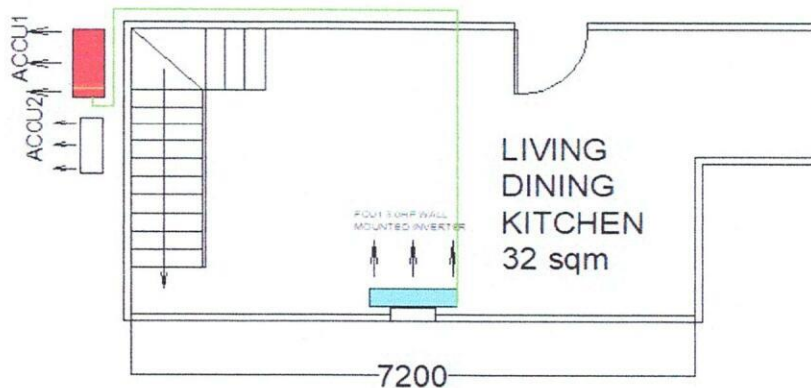
Estimated Charges**₱ 19,950.00****SECOND FLOOR****GROUND FLOOR**

Validity: This quotation is valid for a period of fifteen (15) days from the date thereof, subject to our confirmation thereafter.

Installation notes:

- 1 Location of indoor and outdoor units were agreed by the customer and Kolin's surveyor.
- 2 AC drain line will be tapped to the nearest drain provision provided by the customer's contractor.
- 3 Need for marking and site visit before installation.
- 4 Marking for the chip of wall lay out and drainline.
- 5 Working days: Monday to Saturday, 8am- 5pm with parking. Need working permit.
- 6 Mechanical Plans, Permits, Electrical permits not included.
- 7 Deflectors, masonry, carpentry, chipping & plastering (finishing & restoration) are not included in the installation.
- 8 Air conditioning drain line and Electrical power supply (feeder line) **220v/ 60hz/ 1ph** , should be provided by customer's contractor. **(OUTDOOR LOCATION)**
- 9 **Final charges will be based on actual installation.**

Prepared by:

Jeffrey Dadios

Field Surveyor

Customer Conformance:

Signature Over Printed Name

Reviewed by:

Engr. Kenneth Zamora

Service Supervisor Shop and
Field Operation