



September 15, 2025

MR. NICHOLAS CHUA  
LOPEZ JAENA ST., SAN JUAN CITY

Dear Ma'am/Sir,

Kolin Marketing Inc., is extremely honored for your endorsement of Kolin brand and we are please to offer you with a special price/s for the following items.

A. EQUIPMENT & INSTALLATION - ROOF DECK

QTY	U/M	MODEL / DESCRIPTION	SRP	DISCOUNTED PRICE		AMOUNT
2	UNIT/S	MODEL: KL-IF60-G6H1M32 KOLIN FLOOR MOUNTED AIRCONDITIONER 58,140 Kj/h (5.0TR) FULL DC INVERTER R32 SINGLE PHASE	165,995.00	112,156.20	PHP	224,312.40
TOTAL UNIT COST					PHP	224,312.40
ESTIMATED COST OF INSTALLATION (please see attached)					PHP	45,800.00
TOTAL ESTIMATED COST OF THE PROJECT					PHP	270,112.40

TERMS OF PAYMENT:

FULL PAYMENT OF UNIT AND DELIVERY CHARGE. IF CHECK, SUBJECT FOR 3 DAYS CLEARING.

WARRANTY:

FOR FLOOR MOUNTED (Inverter): ONE (1) YEAR FREE PARTS AND LABOR, FIVE (5) YEARS WARRANTY ON COMPRESSOR.

NOTES: PRICES ARE SUBJECT TO CHANGE WITHOUT PRIOR NOTICE.

PRICES IS VAT INCLUSIVE.

**\*\* Cost of Installation is Package with the Unit(s), this cost cannot avail separately (cost will be based on actual works).**

**\*\*\* You may settle first payment for unit/s & delivery. Installation payment can be settled directly to installer after actual works.**

We thank you for giving opportunity to offer our product and services, hoping we receive your purchase order.

If you need assistance, don't hesitate to call the under signed at 0917-807-8607 or email at [kmi\\_asst@kolinphil.com.ph](mailto:kmi_asst@kolinphil.com.ph)

\*\* This quotation is based on provided floor plan only, subject for actual survey once location is available.

Very Truly Yours,

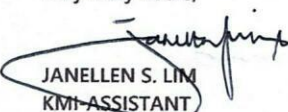
  
JANELLEN S. LIM  
KMI-ASSISTANT

Noted By:

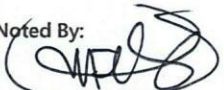
  
MART NATHANIEL R. FLORES  
KMI-SUPERVISOR

Approved By:

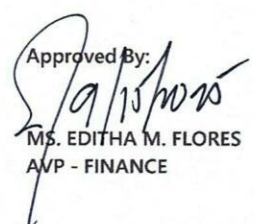
  
MS. EDITHA M. FLORES  
AVP - FINANCE

KMI-QUOTE-09-25-0689  
REG-24%/14K

Conforme:

SIGNATURE OVER PRINTED NAME

Kolin Marketing, Inc.

1854 Sta. Rita St., Guadalupe Nuevo, Makati City

Tel.: (632) 8852-6473

Fax: (632) 8852-2170 / (632) 8852-4792

 [www.kolinphil.com.ph](http://www.kolinphil.com.ph) / [kolinphilippines](http://kolinphilippines)



September 12, 2025  
NICOLAS CHUA

MODEL Qty  
KL-IF60-G6H1M32 2

ROOF DECK

FUNCTION ROOM	Area	41 sqm
---------------	------	--------

ACU 1 6.0 HP Floor Standing Inverter KL-IF60-G6H1M32  
Estimated Pipe Length = 17 ft  
Estimated Royal Cord Length = 22 ft  
Initial Charge ₱ 14,000.00

Includes:

Labor  
10ft Copper Tube  
10ft Royal Cord  
Indoor Bracket (Floor)  
Consumables

Installation Materials	Description	Qty	Price per qty	Subtotal
Copper Tube	Ø 3/8" x Ø 5/8"	7 ft	₱ 400.00/ft	₱ 2,800.00
Royal Cord (comm. wire)	2.mm2 x 4C	12 ft	₱ 100.00/ft	₱ 1,200.00
Royal Cord (ACCU-Breaker)	5.5mm x 3c	5 ft	₱ 70.00/ft	₱ 350.00
Outdoor bracket	Fabricated floor	1 pc/s	₱ 2,500.00/pc	₱ 2,500.00
PVC blue	3/4" x 10'	2 pc/s	₱ 150.00/pc	₱ 300.00
				₱ 7,150.00

Estimated Charges	₱ 21,150.00
-------------------	-------------

ACU 2 6.0 HP Floor Standing Inverter KL-IF60-G6H1M32  
Estimated Pipe Length = 17 ft  
Estimated Royal Cord Length = 22 ft  
Initial Charge ₱ 14,000.00

Includes:

Labor  
10ft Copper Tube  
10ft Royal Cord  
Indoor Bracket (Floor)  
Consumables

Installation Materials	Description	Qty	Price per qty	Subtotal
Copper Tube	Ø 3/8" x Ø 5/8"	7 ft	₱ 400.00/ft	₱ 2,800.00
Royal Cord (comm. wire)	2.mm2 x 4C	12 ft	₱ 100.00/ft	₱ 1,200.00
Royal Cord (ACCU-Breaker)	5.5mm x 3c	5 ft	₱ 70.00/ft	₱ 350.00
Circuit Breaker waterproof	60A / 1Ph	1 pc/s	₱ 1,000.00/pc	₱ 1,000.00
Outdoor bracket	Fabricated wall	1 pc/s	₱ 5,000.00/pc	₱ 5,000.00
PVC blue	3/4" x 10'	2 pc/s	₱ 150.00/pc	₱ 300.00
				₱ 10,650.00

Estimated Charges	₱ 24,650.00
-------------------	-------------

Total Estimated Charges

P 45,800.00

Validity: This quotation is valid for a period of fifteen (15) days from the date thereof, subject to our confirmation thereafter.

**Installation notes:**

- 1 Location based in floor plan only.
- 2 AC drain line will be tapped to the nearest drain provision provided by the customer's contractor.
- 3 Need for marking and site visit before installation.
- 3 Staff house 2nd floor need to have a manhole for lay out of copper tubes and wires.
- 4 Working days: Monday to Saturday, 8am- 5pm with parking. Need working permit.
- 5 Mechanical Plans, Permits, Electrical permits not included.
- 6 Deflectors, masonry, carpentry, chipping & plastering (finishing & restoration) are not included in the installation.
- 7 Air conditioning drain line and Electrical power supply (feeder line) **220v/ 60hz/ 1ph** should be provided by customer's contractor.
- 8 **Final charges will be based on actual installation.**

Prepared by:

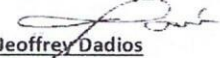
  
**Jeffrey Dadios**  
Field Surveyor

Customer Conformer:

\_\_\_\_\_  
Signature Over Printed Name

Reviewed by:

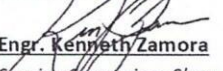
  
**Engr. Kenneth Zamora**  
Service Supervisor Shop and Field  
Operation



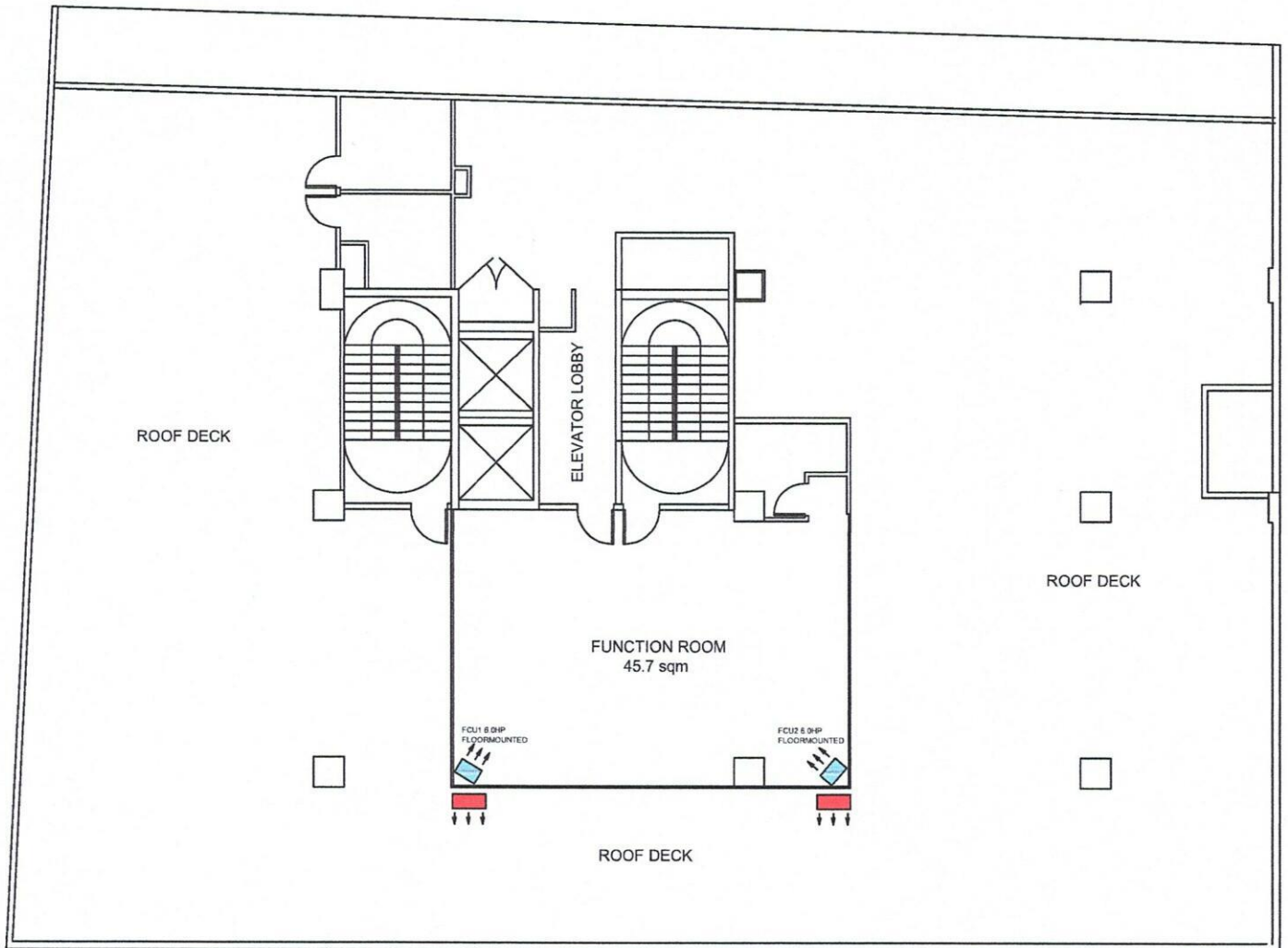

ROOF DECK PLAN