



September 16, 2025

3M DRAGON LOGISTICS CORPORATION  
3M STA. MARIA, CAMANGYANAN RD. STA. MARIA, BULACAN  
ATTN: MS. AIRA SISON  
TEL#: 0966-2579741

Dear Ma'am/Sir,

Kolin Marketing Inc., is extremely honored for your endorsement of Kolin brand and we are please to offer you with a special price/s for the following items.

A. EQUIPMENT & INSTALLATION

\* REGULAR INVERTER OPTION \*

QTY	U/M	MODEL / DESCRIPTION	SRP	DISCOUNTED PRICE		AMOUNT
1	UNIT/S	MODEL: KSM-IW20-WCT10M1M32 KOLIN WALL MOUNTED CERTUS SERIES AIRCONDITIONER 18,990 KJ/h (2.0HP) REGULAR INVERTER W/ WIFI R-32	41,995.00	27,916.20	PHP	27,916.20
TOTAL UNIT COST					PHP	27,916.20
ESTIMATED COST OF INSTALLATION (please see attached)					PHP	15,200.00
OTHERS: DELIVERY CHARGE					PHP	1,000.00
TOTAL ESTIMATED COST OF THE PROJECT					PHP	44,116.20

\* FULL DC INVERTER OPTION \*

QTY	U/M	MODEL / DESCRIPTION	SRP	DISCOUNTED PRICE		AMOUNT
1	UNIT/S	MODEL: KSG-IWF-20WFY-8K1M32 KOLIN WALL MOUNTED PRIMUS GOLD AIRCONDITIONER 19,000 KJ/h (2.0HP) FULL DC INVERTER W/ WIFI R-32	59,595.00	38,292.20	PHP	38,292.20
TOTAL UNIT COST					PHP	38,292.20
ESTIMATED COST OF INSTALLATION (please see attached)					PHP	15,200.00
OTHERS: DELIVERY CHARGE					PHP	1,000.00
TOTAL ESTIMATED COST OF THE PROJECT					PHP	54,492.20

TERMS OF PAYMENT:

FULL PAYMENT OF UNIT AND DELIVERY CHARGE. IF CHECK, SUBJECT FOR 3 DAYS CLEARING.

WARRANTY:

FOR SPLIT TYPE : ONE (1) YEAR FREE PARTS AND LABOR, THREE YEARS (3) MAIN PCB , TEN (10) YEARS WARRANTY ON COMPRESSOR.

NOTES: PRICES ARE SUBJECT TO CHANGE WITHOUT PRIOR NOTICE.

PRICES IS VAT INCLUSIVE.

\*\* Cost of Installation is Package with the Unit(s), this cost cannot avail separately (cost will be based on actual works).

\*\*\* You may settle first payment for unit/s & delivery. Installation payment can be settled directly to installer after actual works.

We thank you for giving opportunity to offer our product and services, hoping we receive your purchase order.

If you need assistance, don't hesitate to call the under signed at 0917-807-8607 or email at kmi\_asst@kolinphil.com.ph

Very Truly Yours,

JANELLEN S. LIM  
KMI-ASSISTANT

Noted By:

MARTIN MANUEL R. FLORES  
KMI-SUPERVISOR

Approved By:

MS. EDITHA M. FLORES  
AVP - FINANCE

Conforme:

SIGNATURE OVER PRINTED NAME

KMI-QUOTE-09-25-0690-rev  
REG-24%/4K/7K

Kolin Marketing, Inc.

1854 Sta. Rita St., Guadalupe Nuevo, Makati City

Tel.: (632) 8852-6473

Fax: (632) 8852-2170 / (632) 8852-4792

www.kolinphil.com.ph / kolinphilippines



# King's Aire Ref and Aircon Services

Customer Name : 3M Dragon Logistics Corporation Date : 09/09/2025  
 Address : 3M Sta. Maria Camangyanan Rd, Santa Maria, Bulacan SJR No : \_\_\_\_\_

Establishment Type: Residential ☐ Commercial ☐

Area Surveyed : Storage Cabinet Room

## Cooling Capacity Computation

Floor Area : 32.4 sqm. note: add 20% per meter in excess of 3 meters in the  
 Ceiling Height : 4.2 mtr. initial cooling capacity computed.

Floor Area :	<u>32.4</u>	x	550 Btu/hr	<u>17,820.00</u>	Btu/h
Ceiling Height (excess of 3 mtrs.) :	<u>4.2</u>	x	20%	<u>3,564.00</u>	Btu/h
Windows Direct Sunlight		<input type="checkbox"/>	20% Heat Load of Floor Area	<u>3,564.00</u>	Btu/h
Glass Wall Direct Sunlight		<input type="checkbox"/>	50% Heat Load of Floor Area	<u>3,564.00</u>	Btu/h
Total Cooling Capacity					Btu/h

### Add : Additional Heal Load

No. of Person	<u>6</u>	x	300 Btu/hr	<u>1,800.00</u>	Btu/h
No. of Ordinary Light (<40w)		x	200 Btu/hr		Btu/h
No. of Special Light (<40w)	<u>2</u>	x	400 Btu/hr	<u>800.00</u>	Btu/h
No. of Refrigerator (<6 cu.ft.)		x	400 Btu/hr		Btu/h
No. of Refrigerator (<6 cu.ft.)		x	800 Btu/hr		Btu/h
No. of Television		x	400 Btu/hr		Btu/h
No. of Cooking Range		x	1500 Btu/hr		Btu/h
No. of Laptop Computer		x	250 Btu/hr		Btu/h
No. of Desktop Computer		x	500 Btu/hr		Btu/h
No. of Printer		x	500 Btu/hr		Btu/h
No. of Photocopier		x	1000 Btu/hr		Btu/h
Others <b>CONTROL PANEL COMPUTER</b>	<u>6</u>	x	4000 Btu/hr	<u>24,000.00</u>	Btu/h
Total Cooling Capacity				<u>55,112.00</u>	Btu/h
Computed Cooling Capacity				<u>6.12</u>	HP

Recommended Product Model KSM-IW20-WTCM10 Recommended Capacity / Type 4HP

Note : Compressor warranty will be reduced to \_\_\_\_\_yr. If air-conditioner purchased is lower than the recommended cooling capacity or pipe lay-out is beyond the maximum allowable length.

## Scope of Agreement

- |                                      |  |  |
|--------------------------------------|--|--|
| 1. Copper tube lay-out               | <input checked="" type="checkbox"/> Expose | <input type="checkbox"/> Embedded                |
| 2. Chipping                          | <input type="checkbox"/> Included          | <input checked="" type="checkbox"/> Not Included |
| 3. Fabricated bracket                | <input checked="" type="checkbox"/> Yes    | <input type="checkbox"/> No                      |
| 4. Service Ledge                     | <input type="checkbox"/> Yes               | <input checked="" type="checkbox"/> No           |
| 5. Dismantling of existing Aircon    | <input type="checkbox"/> Included          | <input checked="" type="checkbox"/> c/o Customer |
| 6. Leak Test of existing Copper tube | <input type="checkbox"/> Yes               | <input checked="" type="checkbox"/> No           |
| 7. Duct works                        | <input type="checkbox"/> Yes               | <input checked="" type="checkbox"/> No           |

8. Location of indoor and outdoor units were agreed by the customer and surveyor.  
 9. Plastering, Carpentry and restoration works are to be done by the customer.  
 10. Wiring of electrical supply from main panel to air-conditioning unit are to be done by the customer.  
 11. Processing of mechanical plan, working permit are to be done by the customer.  
 12. Other concern; Hanging Plate indoor and Fabricated Bracket Provide by customer with existing unit 2.5HP  
(Option 1) 2units of 2HP wall mounted



## Plan Lay-out

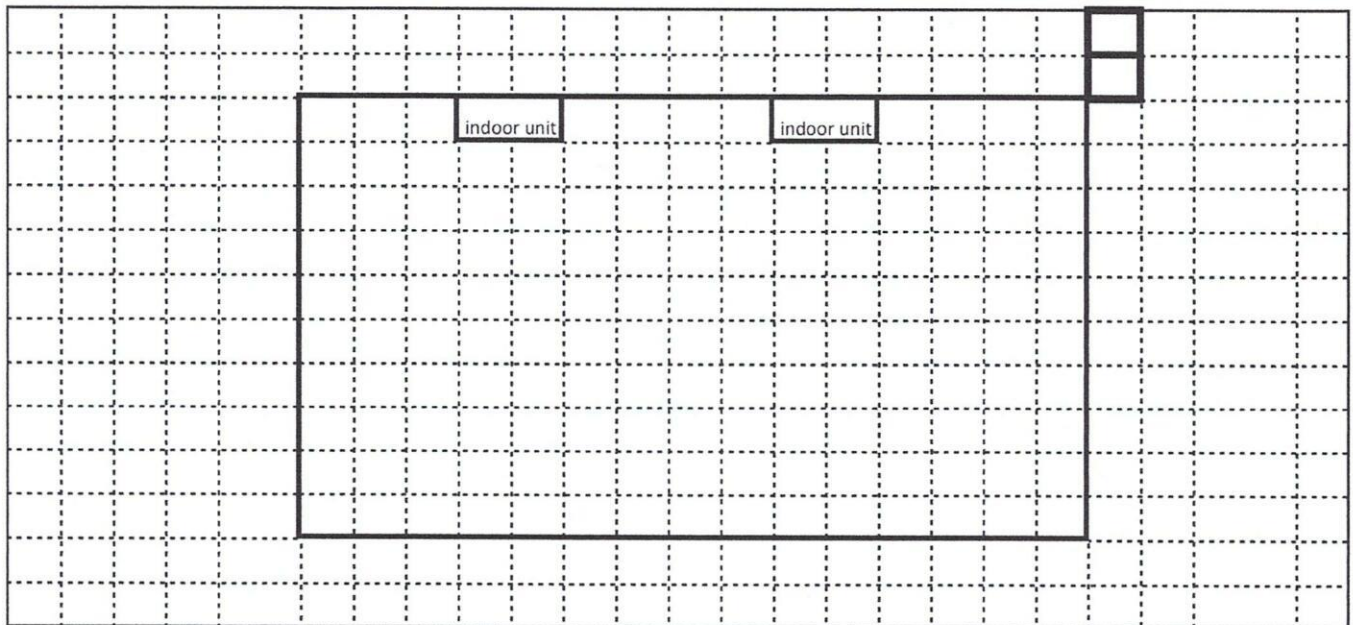

Indoor Unit Location : \_\_\_\_\_  
 Outdoor Unit Location : \_\_\_\_\_  
 Pipe Length : 26ft  
 Special Note : Hanging Plate indoor and Fabricated Bracket Provide by customer

**Instruction :** ☐ Encircle required specifications (copper tube size, power supply, circuit breaker and ODU bracket)

## Installation Cost Estimate

Material Description	Qty.	Unit Cost	Total Cost
Insu. Copper Tube (Excess of 10ft.) 3/8" x 1/4"   <u>1/2" x 1/4"</u>   5/8" x 1/4"   5/8" x 3/8"   7/8" x 3/8"	16	₱ 450.00	₱ 7,200.00
Communication Wire - Royal Cord (Excess 10ft.) 2.0sqmm x 4c			
Power Supply - Royal Cord (Breaker to ODU) 3.5sqmm x 3c   5.5sqmm x 3c   8.0sqmm x 3c			
Circuit Breaker 20Amps/1Ph   <u>40Amps/1Ph</u>   40Amps/Ph   60Amps/1Ph   40Amps/3Ph   100Amps/3Ph	1	1,000.00	1,000.00
Bracket (ODU) Kolin Wall   Kolin Floor   Fab. Floor   Fab. Wall   Fab. Wall w/ ledge			
Angel Bracket (WAC)			
PVC Pipe (Drain) 3/4" x 10'   1" x 10'			
Leaktest Existing Copper Tube ( $\phi$ dia ____ x ____, estimated length ____ ft )			
Dismantling Fee (Existing Air-Conditioning unit capacity ____ HP)			
Chipping Works			
Others __less Standard bracket____			-500.00
Initial Charge			₱ 7,500.00
<b>TOTAL ESTIMATE</b>			<b>₱ 15,200.00</b>

**Note:**

- Final charges will be based on actual installation.
- Survey fee will be **deducted** in the installation fee.

Prepared by:

Resty Mutuc

Signature Over Printed Name

Customer Conforme:

Signature Over Printed Name