

MR. WILLIE WISCO
3 JASMIN ST., JPA SUBD. BRGY. TUNASAN, MUNTINLUPA CITY
TEL#: 0917-5290736

Dear Ma'am/Sir,

Kolin Marketing Inc., is extremely honored for your endorsement of Kolin brand and we are please to offer you with a special price/s for the following items.

A. EQUIPMENT & INSTALLATION

* OPTION 1 *

QTY	U/M	MODEL / DESCRIPTION	SRP	DISCOUNTED PRICE		AMOUNT
1	UNIT/S	MODEL: KSM-IW20-WCT10M1M32 KOLIN WALL MOUNTED CERTUS SERIES AIRCONDITIONER 18,990 KJ/h (2.0HP) REGULAR INVERTER W/ WIFI R-32	41,995.00	27,916.20	PHP	27,916.20
1	UNIT/S	MODEL: KSM-IW25-WCT10M1M32 KOLIN WALL MOUNTED CERTUS AIRCONDITIONER 23,210 KJ/h (2.5HP) REGULAR INVERTER W/ WIFI R-32	49,995.00	33,996.20	PHP	33,996.20
TOTAL UNIT COST					PHP	61,912.40
ESTIMATED COST OF INSTALLATION (please see attached)					PHP	45,940.00
OTHERS: DELIVERY CHARGE					PHP	600.00
TOTAL UNIT COST					PHP	108,452.40

* OPTION 2 *

QTY	U/M	MODEL / DESCRIPTION	SRP	DISCOUNTED PRICE		AMOUNT
1	UNIT/S	MODEL: KSG-IWF-20WFF-8K1M32 KOLIN WALL MOUNTED PRIMUS GOLD AIRCONDITIONER 19,000 KJ/h (2.0HP) FULL DC INVERTER W/ WIFI R-32	59,595.00	38,292.20	PHP	38,292.20
1	UNIT/S	MODEL: KSG-IWF-25WFF-8K1M32 KOLIN WALL MOUNTED PRIMUS GOLD AIRCONDITIONER 25,560 KJ/h (2.5HP) FULL DC INVERTER W/ WIFI R-32	68,995.00	45,436.20	PHP	45,436.20
TOTAL UNIT COST					PHP	83,728.40
ESTIMATED COST OF INSTALLATION (please see attached)					PHP	45,940.00
OTHERS: DELIVERY CHARGE					PHP	600.00
TOTAL UNIT COST					PHP	130,268.40

TERMS OF PAYMENT:

FULL PAYMENT OF UNIT AND DELIVERY CHARGE. IF CHECK, SUBJECT FOR 3 DAYS CLEARING.

WARRANTY:

FOR SPLIT TYPE : ONE (1) YEAR FREE PARTS AND LABOR, THREE YEARS (3) MAIN PCB , TEN (10) YEARS WARRANTY ON COMPRESSOR.

NOTES: PRICES ARE SUBJECT TO CHANGE WITHOUT PRIOR NOTICE.

PRICES IS VAT INCLUSIVE.

** Cost of Installation is Package with the Unit(s), this cost cannot avail separately (cost will be based on actual works).

*** You may settle first payment for unit/s & delivery. Installation payment can be settled directly to installer after actual works.

We thank you for giving opportunity to offer our product and services, hoping we receive your purchase order.

If you need assistance, don't hesitate to call the under signed at 0917-807-8607 or email at kmi_asst@kolinphil.com.ph

Very Truly Yours,

JANELLEN S. LIM
KMI-ASSISTANT

Noted by:

MARTIN HANIEL R. FLORES
KMI-SUPERVISOR

Approved By:

MS. EDITHA M. FLORES
AVP - FINANCE

Conforme:

SIGNATURE OVER PRINTED NAME

KMI-QUOTE-09-25-0720
REG-24%/4K/7K

Kolin Marketing, Inc.

1854 Sta. Rita St., Guadalupe Nuevo, Makati City

Tel.: (632) 8852-6473

Fax: (632) 8852-2170 / (632) 8852-4792

www.kolinphil.com.ph / kolinphilippines



September 26, 2025
 Willie Wisco
 3 Jasmin St. JPA Subd. Brgy Tunasan Muntinlupa City
 0917-5290736
 viber 0917-5290736

MODEL	Qty
KSG-IWF-20WFF8K1M32	1
KSG-IWF-25WFF8K1M32	1

ENTERTAINMENT ROOM		Area	17 sqm
--------------------	--	------	--------

ACU 1 2.0 HP Wall Mounted Inverter *KSG-IWF-20WFF8K1M32*
 Estimated Pipe Length = 13 ft
 Estimated Royal Cord Length = 18 ft
Initial Charge ₱ 7,500.00

Includes:
 Labor
 10ft Copper Tube
 10ft Royal Cord
 Outdoor Bracket (Wall)
 Consumables

Installation Materials	Description	Qty	Price per qty	Subtotal
Copper Tube	Ø 1/4" x Ø 1/2"	3 ft	₱ 350.00/ft	₱ 1,050.00
Royal Cord (comm. wire)	2.mm2 x 4C	8 ft	₱ 100.00/ft	₱ 800.00
Royal Cord (ACCU-Breaker)	3.5mm x 3c	7 ft	₱ 60.00/ft	₱ 420.00
Circuit Breaker waterproof	30A / 1Ph	1 pc/s	₱ 1,000.00/pc	₱ 1,000.00
Dismantle	2.0HP Wall Mounted	1 set	₱ 2,500.00/set	₱ 2,500.00
PVC blue	3/4" x 10'	1 pc/s	₱ 150.00/pc	₱ 150.00
Drain Hose	White -1/2"	7 ft	₱ 25.00/ft	₱ 175.00
				₱ 6,095.00

Estimated Charges	₱ 13,595.00
--------------------------	--------------------

DINING AREA		Area	23 sqm
-------------	--	------	--------

ACU 2 2.5 HP Wall Mounted Inverter *KSG-IWF-25WFF8K1M32*
 Estimated Pipe Length = 52 ft
 Estimated Royal Cord Length = 59 ft
Initial Charge ₱ 8,500.00

Includes:
 Labor
 10ft Copper Tube
 10ft Royal Cord
 Outdoor Bracket (Wall)
 Consumables

Installation Materials	Description	Qty	Price per qty	Subtotal
Copper Tube	Ø 1/4" x Ø 5/8"	42 ft	₱ 400.00/ft	₱ 16,800.00
Royal Cord (comm. wire)	2.mm2 x 4C	49 ft	₱ 100.00/ft	₱ 4,900.00
Royal Cord (ACCU-Breaker)	3.5mm x 3c	7 ft	₱ 60.00/ft	₱ 420.00
Rubber Insulation	2 1/8" x 3/4" x 6'	3 pc/s	₱ 350.00/pc	₱ 1,050.00
Chipping Works		1 mtr	₱ 500.00/mtr	₱ 500.00
Drain Hose	White -1/2"	7 ft	₱ 25.00/ft	₱ 175.00
				₱ 23,845.00

Estimated Charges	₱ 32,345.00
--------------------------	--------------------

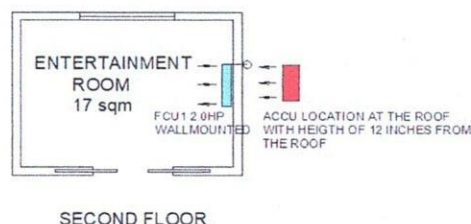
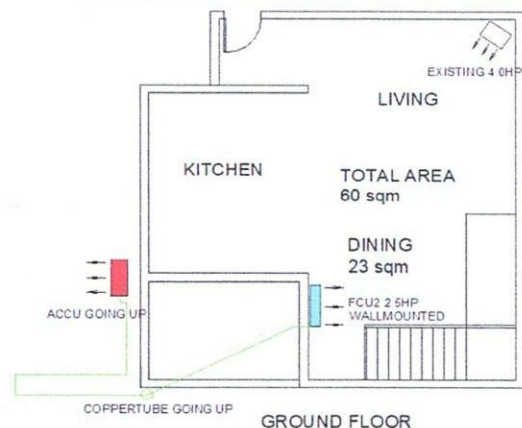

Total Estimated Charges

P 45,940.00

Validity: This quotation is valid for a period of fifteen (15) days from the date thereof, subject to our confirmation thereafter.

Installation notes:

- 1 Location of indoor and outdoor units were agreed by the customer and Kolin's surveyor.
- 2 AC drain line will be tapped to the nearest drain provision provided by the customer's contractor.
- 3 Coppertube expose inside the area. Need to open the ceiling and clear roof where the new coppertube lay out.
- 4 Need a loop of each unit outdoor unit location at the roof.
- 5 ACU2 With existing of 4.0hp.
- 6 Working days: Monday to Saturday, 8am- 5pm with parking. Need working permit.
- 7 Mechanical Plans, Permits, Electrical permits not included.
- 8 Deflectors, masonry, carpentry, chipping & plastering (finishing & restoration) are not included in the installation.
- 9 Air conditioning drain line and Electrical power supply (feeder line) **220v/ 60hz/ 1ph**, should be provided by customer's contractor.
- 10 **Final charges will be based on actual installation.**

Prepared by:

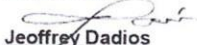
Jeffrey Dadios
Field Surveyor

Customer Conformer:

Signature Over Printed Name

Reviewed by:

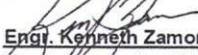
Engt. Kenneth Zamora
Service Supervisor Shop and
Field Operation