

ATTY. BOBBY SAN JOSE

UNIT 24D EASTON PLACE CONDO, 118 VALERO ST., SALCEDO VILLAGE BRGY. BEL AIR, MAKATI CITY

Email: roberto.sanjose@cltjps.com.ph

TEL#: 0923-9673736

Dear Ma'am/Sir,

Kolin Marketing Inc., is extremely honored for your endorsement of Kolin brand and we are please to offer you with a special price/s for the following items.

A. EQUIPMENT & INSTALLATION

* OPTION 1 *

QTY	U/M	MODEL / DESCRIPTION	SRP	DISCOUNTED PRICE		AMOUNT
1	UNIT/S	MODEL: KLG-IF40-5G1M32 KOLIN FLOOR MOUNTED AIRCONDITIONER 37,980 KJ/h (3.0TR) FULL DC INVERTER R-32 SINGLE PHASE	113,195.00	79,028.20	PHP	79,028.20
2	UNIT/S	MODEL: KSM-IW15-WCT10M1M32 KOLIN WALL MOUNTED CERTUS SERIES AIRCONDITIONER 12,660 KJ/h (1.5HP) REGULAR INVERTER W/ WIFI R-32	32,995.00	21,076.20	PHP	42,152.40
TOTAL UNIT COST					PHP	121,180.60
ESTIMATED COST OF INSTALLATION (please see attached)					PHP	60,210.00
OTHERS: DELIVERY CHARGE					PHP	600.00
TOTAL ESTIMATED COST OF THE PROJECT					PHP	181,990.60

* OPTION 2 *

QTY	U/M	MODEL / DESCRIPTION	SRP	DISCOUNTED PRICE		AMOUNT
1	UNIT/S	MODEL: KLG-IF40-5G1M32 KOLIN FLOOR MOUNTED AIRCONDITIONER 37,980 KJ/h (3.0TR) FULL DC INVERTER R-32 SINGLE PHASE	113,195.00	79,028.20	PHP	79,028.20
2	UNIT/S	MODEL: KSG-IWF-15WFF-8K1M32 KOLIN WALL MOUNTED PRIMUS GOLD AIRCONDITIONER 12,960 KJ/h (1.5HP) FULL DC INVERTER W/ WIFI R-32	46,595.00	28,412.20	PHP	56,824.40
TOTAL UNIT COST					PHP	135,852.60
ESTIMATED COST OF INSTALLATION (please see attached)					PHP	60,210.00
OTHERS: DELIVERY CHARGE					PHP	600.00
TOTAL ESTIMATED COST OF THE PROJECT					PHP	196,662.60

TERMS OF PAYMENT:

FULL PAYMENT OF UNIT AND DELIVERY CHARGE. IF CHECK, SUBJECT FOR 3 DAYS CLEARING.

WARRANTY:

FOR SPLIT TYPE : ONE (1) YEAR FREE PARTS AND LABOR, THREE YEARS (3) MAIN PCB , TEN (10) YEARS WARRANTY ON COMPRESSOR.

NOTES: PRICES ARE SUBJECT TO CHANGE WITHOUT PRIOR NOTICE.

PRICES IS VAT INCLUSIVE.

** Cost of Installation is Package with the Unit(s), this cost cannot avail separately (cost will be based on actual works).

*** You may settle first payment for unit/s & delivery. Installation payment can be settled directly to installer after actual works.

We thank you for giving opportunity to offer our product and services, hoping we receive your purchase order.

If you need assistance, don't hesitate to call the under signed at 0917-807-8607 or email at kmi_asst@kolinphil.com.ph

Very Truly Yours,

JANELLEN S. LIM
KMI-ASSISTANT

Noted by:
MART NATHANIEL R. FLORES
KMI-SUPERVISOR

Approved By:
MS. EDITHA M. FLORES
AVP - FINANCE

KMI-QUOTE-09-25-0656
DCG-24%/4K/7K

Conforme: _____
SIGNATURE OVER PRINTED NAME

Kolin Marketing, Inc.

1854 Sta. Rita St., Guadalupe Nuevo, Makati City

Tel.: (632) 8852-6473

Fax: (632) 8852-2170 / (632) 8852-4792

www.kolinphil.com.ph / kolinphilippines



September 4, 2025

ATTY BOBBY SAN JOSE

Unit 24D Easton Place Condo, 118 Valero St. Salcedo Village, Brgy Bel Air Makati

0923-9673736

aida.delapaz@cltpsi.com.ph / markrealica@yahoo.com/ roberto.sanjose@cltpsi.com.ph

MODEL	Qty
KLG-IF40-5G1M32	1
KSG-IWF-15Wfy8K1M32	2

UNIT 24D

BEDROOM A	Area	15 sqm
-----------	------	--------

ACU 1	1.5 HP Wall Mounted Inverter	KSG-IWF-15Wfy8K1M32
	Estimated Pipe Length = 17 ft	
	Estimated Royal Cord Length = 22 ft	
	Initial Charge	₱ 7,500.00

Includes:

Labor

10ft Copper Tube

10ft Royal Cord

Outdoor Bracket (Floor)

Consumables

Installation Materials	Description	Qty	Price per qty	Subtotal
Copper Tube	Ø 1/4" x Ø 3/8"	7 ft	₱ 350.00/ft	₱ 2,450.00
Royal Cord (comm. wire)	2.mm2 x 4C	12 ft	₱ 100.00/ft	₱ 1,200.00
Royal Cord (ACCU-Breaker)	3.5mm x 3c	5 ft	₱ 60.00/ft	₱ 300.00
Circuit Breaker waterproof	20A / 1Ph	1 pc/s	₱ 1,000.00/pc	₱ 1,000.00
Dismantle	1.5HP Wall Mounted	1 set	₱ 2,500.00/set	₱ 2,500.00
PVC blue	3/4" x 10'	2 pc/s	₱ 150.00/pc	₱ 300.00
				₱ 7,750.00

Estimated Charges	₱ 15,250.00
-------------------	-------------

LIVING DINING	Area	34 sqm
---------------	------	--------

ACU 2	4.0 HP Floor Standing Inverter	KLG-IF40-5G1M32
	Estimated Pipe Length = 13 ft	
	Estimated Royal Cord Length = 18 ft	
	Initial Charge	₱ 11,000.00

Includes:

Labor

10ft Copper Tube

10ft Royal Cord

Indoor Bracket (Floor)

Consumables

Installation Materials	Description	Qty	Price per qty	Subtotal
Copper Tube	Ø 3/8" x Ø 5/8"	3 ft	₱ 400.00/ft	₱ 1,200.00
Royal Cord (comm. wire)	2.mm2 x 4C	8 ft	₱ 100.00/ft	₱ 800.00
Royal Cord (ACCU-Breaker)	5.5mm x 3c	5 ft	₱ 70.00/ft	₱ 350.00
Circuit Breaker waterproof	40A/1Ph	1 pc/s	₱ 1,000.00/pc	₱ 1,000.00
Dismantle	4.0HP Ceiling Susp	1 set	₱ 3,500.00/set	₱ 3,500.00
PVC blue	3/4" x 10'	2 pc/s	₱ 150.00/pc	₱ 300.00
				₱ 7,150.00

Estimated Charges	₱ 18,150.00
-------------------	-------------

Area	14.4 sqm
------	----------

KSG-IWF-15Wfy8K1M32

Estimated Royal Cord Length = 42 ft

₱ 7,500.00

Labor

10ft Royal Cord

Consumables

Description

Ø 1/4" x Ø 3/8"

Qty	Price per qty
-----	---------------

27 ft @ 350.00/ft

Subtotal

₹ 9,450.00

2.mm2 x 4C

32 ft @ 100.00/ft

₱ 3,200.00

3.5mm x 3c

5 ft @ 60.00/ft

₹ 300.00

20A / 1Ph

1 pc/s ₹ 1,000.00/pc

₹ 1,000.00

2 1/8" x 3/4" x 6'

5 pc/s ₱ 350.00/pc

₱ 1,750.00

3/8" x 10'

1 pc/s ₹ 150.00/pc

₹ 150.00

3"

8 pc/s ₹ 120.00/pc

₹ 960.00

1.5HP Wall Mounted

1 set ₱ 2,500.00/set

₹ 2,500.00

₱ 19,310.00

₱ 26,810.00

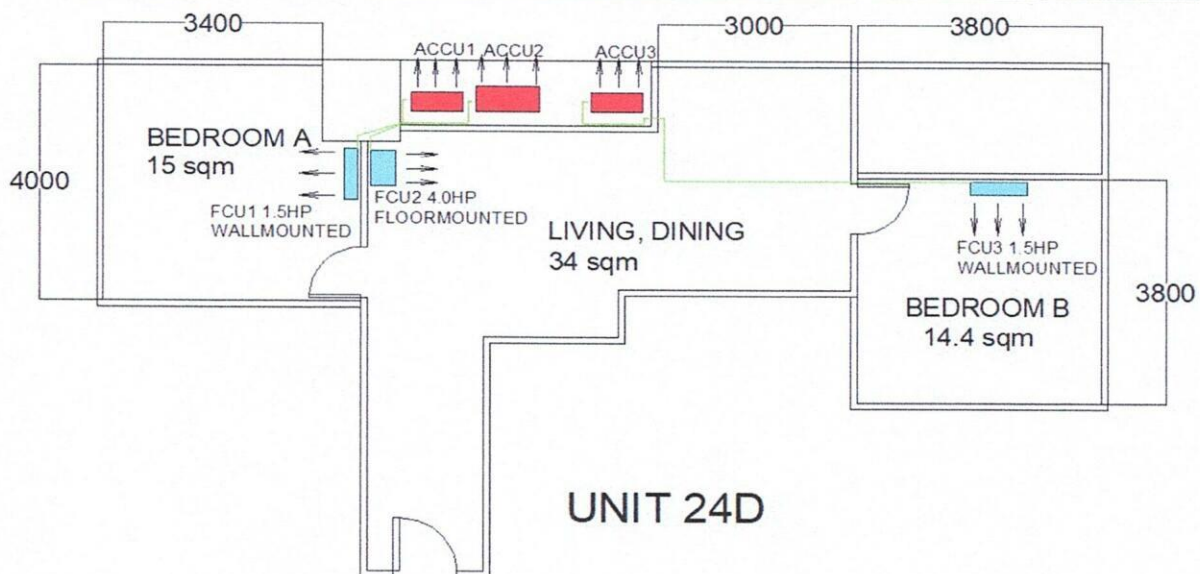

Validity: This quotation is valid for a period of fifteen (15) days from the date thereof, subject to our confirmation thereafter.

Installation notes:

- 1 Location of indoor and outdoor units were agreed by the customer and Kolin's surveyor.
- 2 AC drain line will be tapped to the nearest drain provision provided by the customer's contractor.
- 3 Need for marking and site visit before installation. Perform drain test. Dismantle first and markings.
- 4 Need to open wall for the lay out of coppertube ACU1 and ACU2.
- 5 Working days: Monday to Saturday, 8am- 5pm with parking. Need working permit.
- 6 Mechanical Plans, Permits, Electrical permits not included.
- 7 Deflectors, masonry, carpentry, chipping & plastering (finishing & restoration) are not included in the installation.
- 8 Air conditioning drain line and
Electrical power supply (feeder)
- 9 **Final charges will be based on actual installation.**

Prepared by:

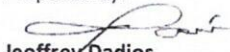
Jeffrey Dadios
Field Surveyor

Customer Conformance:

Signature Over Printed Name

Reviewed by:

Engr. Kenneth Zamora
Service Supervisor Shop and
Field Operation