

MR. RICHMOND JIMENEZ
938 QUIRINO AVE. BRGY DON GALO, PARAÑAQUE CITY
Email: rlozanojimenez@gmail.com
TEL#: 0917-8427460

Dear Ma'am/Sir,

Kolin Marketing Inc., is extremely honored for your endorsement of Kolin brand and we are please to offer you with a special price/s for the following items.

A. EQUIPMENT & INSTALLATION

* OPTION 1 *

QTY	U/M	MODEL / DESCRIPTION	SRP	DISCOUNTED PRICE		AMOUNT
1	UNIT/S	MODEL: KSM-IW20-WCT10M1M32 KOLIN WALL MOUNTED CERTUS SERIES AIRCONDITIONER 18,990 Kj/h (2.0HP) REGULAR INVERTER W/ WIFI R-32	41,995.00	27,916.20	PHP	27,916.20
2	UNIT/S	MODEL: KSM-IW15-WCT10M1M32 KOLIN WALL MOUNTED CERTUS SERIES AIRCONDITIONER 12,660 Kj/h (1.5HP) REGULAR INVERTER W/ WIFI R-32	32,995.00	21,076.20	PHP	42,152.40
TOTAL UNIT COST					PHP	70,068.60
ESTIMATED COST OF INSTALLATION (please see attached)					PHP	71,370.00
OTHERS: DELIVERY CHARGE					PHP	600.00
TOTAL ESTIMATED COST OF THE PROJECT					PHP	142,038.60

* OPTION 2 *

QTY	U/M	MODEL / DESCRIPTION	SRP	DISCOUNTED PRICE		AMOUNT
1	UNIT/S	MODEL: KSG-IWF-20WFF-8K1M32 KOLIN WALL MOUNTED PRIMUS GOLD AIRCONDITIONER 19,000 Kj/h (2.0HP) FULL DC INVERTER W/ WIFI R-32	59,595.00	38,292.20	PHP	38,292.20
2	UNIT/S	MODEL: KSG-IWF-15WFF-8K1M32 KOLIN WALL MOUNTED PRIMUS GOLD AIRCONDITIONER 12,960 Kj/h (1.5HP) FULL DC INVERTER W/ WIFI R-32	46,595.00	28,412.20	PHP	56,824.40
TOTAL UNIT COST					PHP	95,116.60
ESTIMATED COST OF INSTALLATION (please see attached)					PHP	71,370.00
OTHERS: DELIVERY CHARGE					PHP	600.00
TOTAL ESTIMATED COST OF THE PROJECT					PHP	167,086.60

TERMS OF PAYMENT:

FULL PAYMENT OF UNIT AND DELIVERY CHARGE. IF CHECK, SUBJECT FOR 3 DAYS CLEARING.

WARRANTY:

FOR SPLIT TYPE : ONE (1) YEAR FREE PARTS AND LABOR, THREE YEARS (3) MAIN PCB , TEN (10) YEARS WARRANTY ON COMPRESSOR.

NOTES: *** Need to sign waiver agreement due to under capacity of unit choice.

PRICES ARE SUBJECT TO CHANGE WITHOUT PRIOR NOTICE.

PRICES IS VAT INCLUSIVE.

** Cost of Installation is Package with the Unit(s), this cost cannot avail separately (cost will be based on actual works).

*** You may settle first payment for unit/s & delivery. Installation payment can be settled directly to installer after actual works.

We thank you for giving opportunity to offer our product and services, hoping we receive your purchase order.

If you need assistance, don't hesitate to call the under signed at 0917-807-8607 or email at kmi_asst@kolinphil.com.ph

Very Truly Yours,

JANELLEN S. LIM
KMI-ASSISTANT

Noted by:

MARTIN MANUEL R. FLORES
KMI-SUPERVISOR

Approved By:

MS. EDITHA M. FLORES
AVP - FINANCE

Conforme:

SIGNATURE OVER PRINTED NAME

KMI-QUOTE-09-25-0648-rev
REG-24%/4K/7K

Kolin Marketing, Inc.

1854 Sta. Rita St., Guadalupe Nuevo, Makati City

Tel.: (632) 8852-6473

Fax: (632) 8852-2170 / (632) 8852-4792

www.kolinphil.com.ph / kolinphilippines



SEPTEMBER 03, 2025
 RICHMOND JIMENEZ
 938 Quirino Ave. Brgy Dongalo Paranaque City
 0917-8427460
rlozanojimenez@gmail.com

MODEL	Qty
KSM-IW20-WCT10M1M32	1
KSM-IW15-WCT10M1M32	2

Revision 1

LIVING,DINING,KITCHEN	Area	32 sqm
------------------------------	------	--------

ACU 1	2.0 HP Wall Mounted Inverter	KSM-IW20-WCT10M1M32			
	Estimated Pipe Length =	50 ft			
	Estimated Royal Cord Length =	55 ft			
	Initial Charge				₱ 7,500.00
	Includes:				
	Labor				
	10ft Copper Tube				
	10ft Royal Cord				
	Outdoor Bracket (Wall)				
	Consumables				
	Installation Materials	Description	Qty	Price per qty	Subtotal
	Copper Tube	Ø 1/4" x Ø 1/2"	40 ft	₱ 350.00/ft	₱ 14,000.00
	Royal Cord (comm. wire)	2.mm2 x 4C	45 ft	₱ 100.00/ft	₱ 4,500.00
	Royal Cord (ACCU-Breaker)	3.5mm x 3c	5 ft	₱ 60.00/ft	₱ 300.00
	Circuit Breaker waterproof	30A / 1Ph	1 pc/s	₱ 1,000.00/pc	₱ 1,000.00
	Rubber Insulation	2 1/8" x 3/4" x 6'	3 pc/s	₱ 350.00/pc	₱ 1,050.00
	Full thread	3/8" x 10'	2 pc/s	₱ 150.00/pc	₱ 300.00
	Metal Clamp	3"	6 pc/s	₱ 120.00/pc	₱ 720.00
	PVC blue	3/4" x 10'	2 pc/s	₱ 150.00/pc	₱ 300.00
					₱ 22,170.00
	Estimated Charges				₱ 29,670.00

BEDROOM	Area	47 sqm
----------------	------	--------

ACU 2	1.5 HP Wall Mounted Inverter	KSM-IW15-WCT10M1M32			
	Estimated Pipe Length =	37 ft			
	Estimated Royal Cord Length =	42 ft			
	Initial Charge				₱ 7,500.00
	Includes:				
	Labor				
	10ft Copper Tube				
	10ft Royal Cord				
	Outdoor Bracket (Wall)				
	Consumables				
	Installation Materials	Description	Qty	Price per qty	Subtotal
	Copper Tube	Ø 1/4" x Ø 3/8"	27 ft	₱ 350.00/ft	₱ 9,450.00
	Royal Cord (comm. wire)	2.mm2 x 4C	32 ft	₱ 100.00/ft	₱ 3,200.00
	Royal Cord (ACCU-Breaker)	3.5mm x 3c	5 ft	₱ 60.00/ft	₱ 300.00
	Circuit Breaker waterproof	20A/ 1Ph	1 pc/s	₱ 1,000.00/pc	₱ 1,000.00
	PVC blue	3/4" x 10'	2 pc/s	₱ 150.00/pc	₱ 300.00
					₱ 14,250.00
	Estimated Charges				₱ 21,750.00

ACU 3 1.5 HP Wall Mounted Inverter**KSM-IW15-WCT10M1M32**

Estimated Pipe Length = 33 ft

Estimated Royal Cord Length = 38 ft

Initial Charge

₱ 7,500.00

Includes:

Labor

10ft Copper Tube

10ft Royal Cord

Outdoor Bracket (Wall)

Consumables

Installation Materials

	Description	Qty	Price per qty	Subtotal
Copper Tube	Ø 1/4" x Ø 1/2"	23 ft	₱ 350.00/ft	₱ 8,050.00
Royal Cord (comm. wire)	2.mm2 x 4C	28 ft	₱ 100.00/ft	₱ 2,800.00
Royal Cord (ACCU-Breaker)	3.5mm x 3c	5 ft	₱ 60.00/ft	₱ 300.00
Circuit Breaker waterproof	20A/ 1Ph	1 pc/s	₱ 1,000.00/pc	₱ 1,000.00
PVC blue	3/4" x 10'	2 pc/s	₱ 150.00/pc	₱ 300.00

₱ 12,450.00

Estimated Charges

₱ 19,950.00

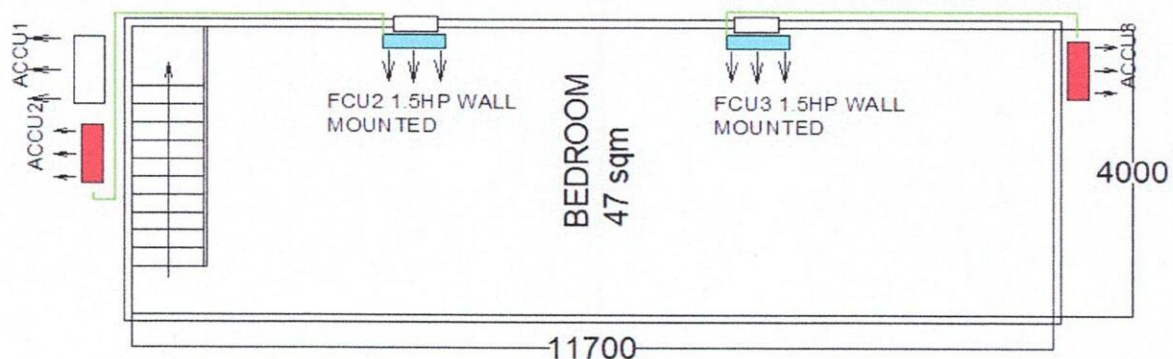
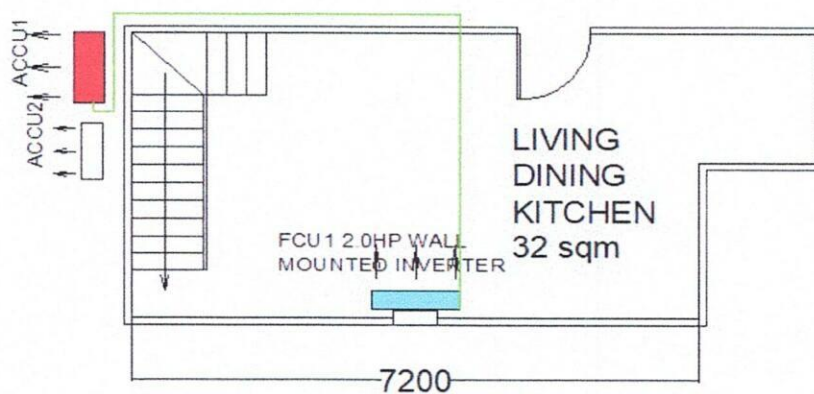
**SECOND FLOOR****GROUND FLOOR**

Validity: This quotation is valid for a period of fifteen (15) days from the date thereof, subject to our confirmation thereafter.

Installation notes:

- 1 Location of indoor and outdoor units were agreed by the customer and Kolin's surveyor.
- 2 AC drain line will be tapped to the nearest drain provision provided by the customer's contractor.
- 3 Need for marking and site visit before installation.
- 4 Marking for the chip of wall lay out and drainline.
- 5 Need waiver due to undercapacity. All units
- 6 Working days: Monday to Saturday, 8am- 5pm with parking. Need working permit.
- 7 Mechanical Plans, Permits, Electrical permits not included.
- 8 Deflectors, masonry, carpentry, chipping & plastering (finishing & restoration) are not included in the installation.
- 9 Air conditioning drain line and Electrical power supply (feeder line) **220v/ 60hz/ 1ph** , should be provided by customer's contractor. **(OUTDOOR LOCATION)**
- 10 **Final charges will be based on actual installation.**

Prepared by:

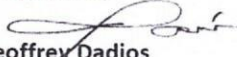
Jeffrey Dadios
Field Surveyor

Customer Conformance:

Signature Over Printed Name

Reviewed by:

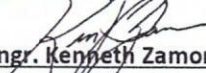
Engr. Kenneth Zamora
Service Supervisor Shop and
Field Operation

SEPTEMBER 03, 2025
RICHMOND JIMENEZ
938 Quirino Ave. Brgy Dongalo Paranaque City
0917-8427460
rlozanojimenez@gmail.com

Please be informed that the air-conditioner you intend to purchase is under capacity as compared to the following unit that we proposed:

Location	Area	Kolin's Recommendation	Customer's Choice	Remarks
LIVING/DINING	32 sqm	KSG-IWF-30WFY8K1M32	KSM-IW20-WCT10M1M32	Calculated 2.6hp under by 0.6hp
BEDROOM	47 sqm	KSG-IWF-20WFY8K1M32 2UNITS	KSM-IW15-WCT10M1M32	Calculated 3.9hp under by 0.9hp

Since the unit of your choice is under capacity, it is probable that you may experience the following;

1. Capacity of the unit to cool the area will take longer or it will not cool the area at all that may lead to your dissatisfaction with the cooling performance of our unit.
2. Power consumption will be higher due to frequent running of compressor for not reaching the desired temperature within the normal parameter.
3. Useful life of compressor will be shortened due to excessive running beyond the normal run cycle.

Considering the above conditions, we regret to inform you that we cannot guarantee the efficient performance of unit. **Also, One (1) year warranty for parts (compressor-3year).**

For your guidance and information

Prepared by:

Name
Surveyor

Approved by:

Mr. Alvin de Rivera
Service Manager

9/3/25

Noted by:

Engr. Kenneth Zamora
Service Supervisor - Field
and Shop Operation

Customer Conforme:

Signature Over Printed Name